

Trident™

3-setting Rainfall Showerhead with Direction-Adjustable Jets

To Connect

1. Remove old shower head by turning it counter-clockwise. Remove any excess material left on Shower Arm threads. Use steel wool if necessary.
2. Wrap some Plumber's Tape (included) around shower arm thread (Fig. 1). This will help to prevent leakage by providing extra sealing in addition to Shower Head Washer. NOTE: use of Plumber's Tape is not always required, but strongly recommended to insure leak-free connection in case of worn shower arm thread.
3. Make sure Washer is positioned FLAT and STRAIGHT inside Connection Nut of Trident Shower Head (Fig. 2), then screw Trident Shower Head onto Shower Arm and hand tighten its Connection Nut (Fig. 3).

To Secure Connection from Loosening

1. Insert Socket Screw (included) into small Threaded Opening on the side of Connection Nut (Fig. 4).
2. Use small Hex Key (included) to tighten Socket Screw.

Optional: as an alternative to using Socket Screw and Hex Key, you can achieve secure connection by applying extra Plumber's Tape onto Shower Arm (Fig. 1) and further tightening Connection Nut with conventional wrench or pliers.

NOTE: If your shower arm has a ball on the end of it instead of threads, it will not work with this shower unit and will need to be replaced with a standard shower arm available at most plumbing supply stores.

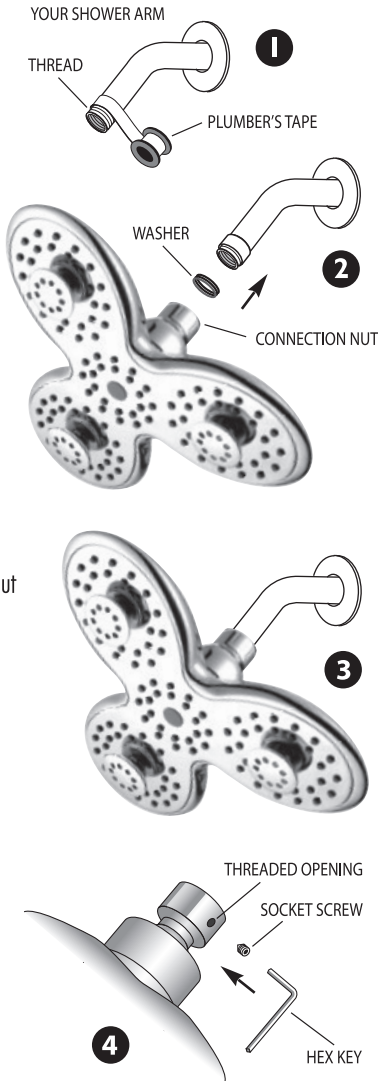

To Operate

1. Choose from one of three water flow settings that include Drenching Rain, Jet Massage and Combination. To switch flow to desired water pattern, rotate Trident Shower Head around its connection axis (Fig. 5). While turning, you can hold Base with free hand to prevent accidental loosening of connection.
2. To set angle, swivel Trident Shower Head around its connection ball joint.
3. To point Direction-adjustable Jets, swivel each jet to desired angle.

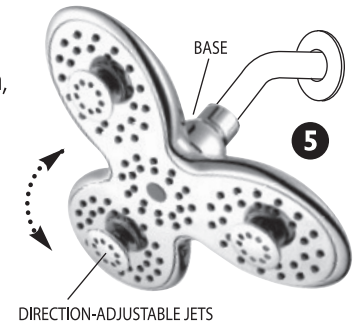

Low Water Pressure? You can remove Water Regulator.

As mandated by U.S. federal law, this shower head is equipped with water flow regulator that limits maximum water flow to 2.5 gallons (9.5 liters) per minute at 80 psi water pressure. In areas with extremely low water pressure causing the shower water flow to be unsatisfactory, the flow regulator may be removed to improve the water flow in the shower head.

To remove Water Flow Regulator, remove Washer from Connection Nut and, using screwdriver or other pointed tool, pull out Water Regulator located inside Connection Nut (Fig. 6). After you are done, place Washer back in.

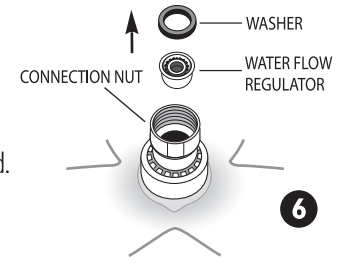

Patent Pending Made in China

Cleaning Instructions Remove mineral deposits from jets by rubbing nozzles with your finger, clean chrome surfaces by wiping them with 50% white vinegar/50% water solution. Do not clean or rinse with harsh chemicals, heavy-duty cleaners or abrasives that may damage finish and void warranty.

For Questions on Installation or Part Replacement Call Toll Free

1-888-869-4010

Mon. - Fri. 9:00 AM - 4:00 PM Eastern Standard Time

LIMITED LIFETIME WARRANTY

Interlink will repair or replace any of this product's parts that exhibit defects in workmanship or materials for above stated period from date of purchase. If malfunction occurs, send only defective part(s) with proof of purchase to Customer Service Department at the address listed below. This warranty does not cover product purchased from unauthorized distributors, malfunction or damage due to accident, misuse, use of harsh chemicals or failure to follow any included written instructions. This warranty gives you specific legal rights. You may also have other rights that vary where you reside.

Interlink Products International, Inc.

1315 E. Elizabeth Ave., Linden, NJ 07036

ipshowers.com