

CASCADE

“ARC ONE” 40” RECHARGEABLE TOWER FAN INSTRUCTION MANUAL

40” RECHARGEABLE TOWER FAN

MODELS: AOTFRB, AOTFRG, AOTFRN, AOTFRW

CHARGER INPUT:

VOLTAGE: 120V

FREQUENCY: 60 Hz, 1.0A

CHARGER OUTPUT: DC12V, 2.0A

BATTERY: 12,000 mAh

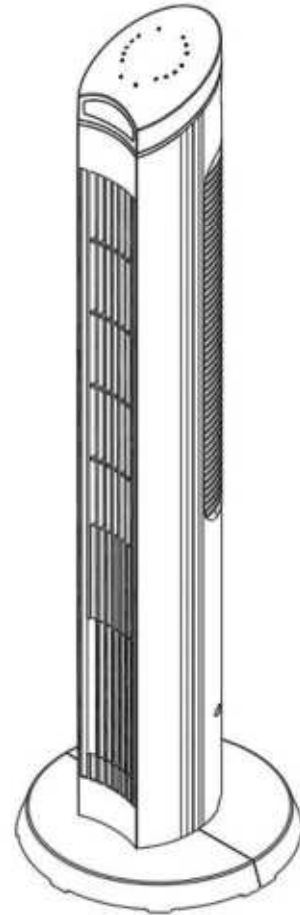

Distributed by:
Chesapeake International, Inc.
Fort Worth, TX

**IMPORTANT, RETAIN FOR FUTURE REFERENCE:
READ CAREFULLY - FOR HOUSEHOLD USE ONLY
USE ONLY WITH PROVIDED 12V CHARGER**

©2026 Chesapeake International, Inc. TM and other trademarks are the property of the respective owners. All other brand names and logos are registered trademarks of their respective owners.

Specifications are subject to change without notice.

MADE IN CHINA

 WARNING	
<ul style="list-style-type: none">• INGESTION HAZARD: This product contains a button cell or coin battery.• DEATH or serious injury can occur if ingested.• A swallowed button cell or coin battery can cause Internal Chemical Burns in as little as 2hours.• KEEP new and used batteries OUT OF REACH of CHILDREN.• Seek immediate medical attention if a battery is suspected to be swallowed or inserted inside any part of the body.	



ATTENTION! BEFORE FIRST USE, PLUG THE TOWER FAN INTO THE INCLUDED CHARGER AND TURN THE ON/OFF TOGGLE SWITCH ON THE BACK OF THE FAN TO THE ON POSITION:

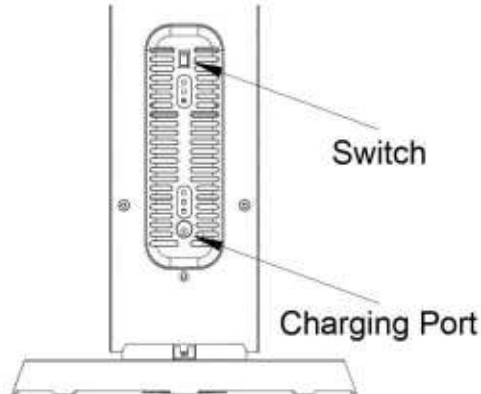

PLEASE READ AND SAVE THESE INSTRUCTIONS WHEN USING ELECTRICAL APPLIANCES, BASIC PRECAUTIONS SHOULD ALWAYS BE FOLLOWED TO REDUCE THE RISK OF FIRE, ELECTRIC SHOCK AND INJURY TO PERSON OR PROPERTY, INCLUDING THE FOLLOWING:

- Read all instructions before using this product.
- Use this fan only as described in this manual.
- Any other use not recommended by the manufacturer may cause fire, electrical shock or injury to person or property and may void the warranty.
- Always unplug unit before assembly, disassembly or cleaning.
- Always unplug unit when not in use, when moving from one location to another and before cleaning.
- To disconnect, grasp the plug and pull it from the wall outlet. **DO NOT** unplug by pulling on cord.
- The use of attachments is not recommended nor sold by the manufacturer and may cause hazards.
- Avoid contact with moving parts.
- **DO NOT** operate any fan with a damaged cord, plug, or wall adapter after a malfunction, or if dropped or damaged in any manner.
- **DO NOT** operate the fan in the presence of explosive and/or flammable fumes.
- **DO NOT** place the fan or any parts near an open flame, cooking or other heating appliances.
- Extreme caution is necessary when fan is used by or near children and whenever the fan is left operating and unattended.
- This product is intended for household use only and not for commercial or industrial use.
- **DO NOT** use outdoors.
- Always use on a dry, level surface.
- **DO NOT** operate if the fan housing is removed or damaged.
- A loose fit between the AC outlet and wall adapter may cause overheating of the plug; consult a qualified electrician.
- **DO NOT** run cord under carpeting. **DO NOT** cover cord with throw rugs, runners, or the like.
- Arrange cord away from traffic areas and where it will not be tripped over.
- **DO NOT** connect the charger to any power sources other than 120V alternating current polarized outlet.
- **WARNING:** To reduce the risk of electric shock, **DO NOT** use this fan with any solid-state speed control.
- **DO NOT** insert finger or any object into grill.
- **WARNING: KEEP BATTERIES OUT OF REACH OF CHILDREN**

- Swallowing may lead to serious injury in as little as 2 hours or death due to chemical burns and potential perforation of the esophagus.
- If you suspect your child has swallowed or inserted in their body a button battery, immediately seek urgent medical assistance.
- Examine devices and make sure the battery compartment is correctly secured, e.g. that the screw or other mechanical fastener is tightened. Do not use if the compartment is not secure.
- Dispose of used button batteries immediately and safely. Flat batteries can still be dangerous.
- Tell others about the risks associated with button batteries and how to keep children safe.
- **Note:** To reduce the risk of fire, electrical shock and injury to a person or property, do not plug this product into extension cords. The extension cord could overheat. Do not plug the fan into any cord connected devices. This includes surge protectors, multiple outlet adapters, and power strips.

FCC STATEMENT OF COMPLIANCE

This device complies with Part 15 of the FCC Rules. Operation is subject to the following two conditions: (1) this device may not cause harmful interference, and (2) this device must accept any interference received, including interference that may cause undesired operation. Instruction manual shall include,

- Warning: Changes or modifications to this unit not expressly approved by the party responsible for compliance could void the user's authority to operate the equipment.
- NOTE: This equipment has been tested and found to comply with the limits for a Class B digital device, pursuant to Part 15 of the FCC Rules.

These limits are designed to provide reasonable protection against harmful interference in a residential installation. This equipment generates, uses and can radiate radio frequency

energy and, if not installed and used in accordance with the instructions, may cause harmful interference to radio communications. However, there is no guarantee that interference will not occur in a particular installation. If this equipment does cause harmful interference to radio or television reception, which can be determined by turning the equipment off and on, the user is encouraged to try to correct the interference by one or more of the following measures:

- Reorient or relocate the receiving antenna.
- Increase the separation between the equipment and receiver.
- Connect the equipment into an outlet on a circuit different from that to which the receiver is connected.
- Consult the dealer or an experienced radio/TV technician for help.

INSTALLATION & BASE ASSEMBLY

1. Unscrew the lock nut from the bottom of the unit.
2. Align and snap the two base pieces together.

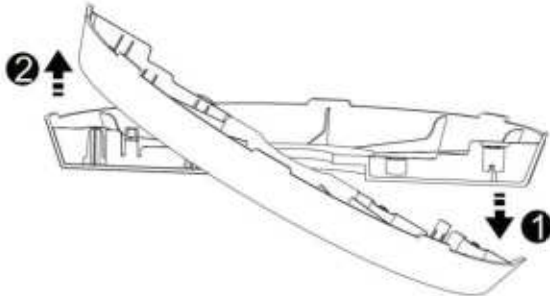

3. Position the assembled base onto the main unit – the base will only fit one way. Secure the base to the unit by fastening the lock nut clockwise.

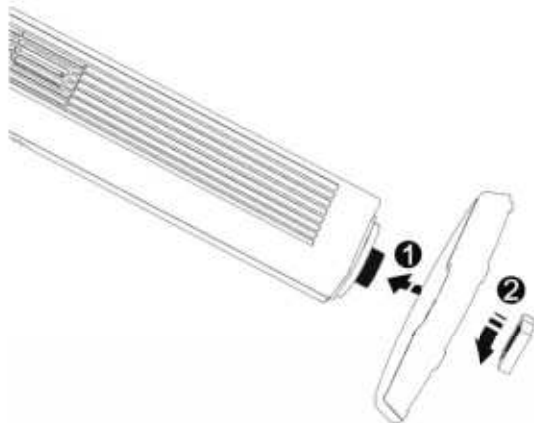

OPERATION:

POWER: To turn the fan ON, tap the power button.
The lights on the fan will illuminate and the fan will default to the lowest fan speed setting (F1) and STANDARD mode. To turn the fan OFF, tap the power

MODE: Tap this button to change the fan's mode. There are 3 fan modes: Standard, Evening and Breeze

OSCILLATION: Turns the fan's oscillation feature ON/OFF

FAN SPEED CONTROL: Controls fan speed: F1: ECO, F2: LOW, F3: MED, F4: HIGH, F5: EXTRA HIGH.
Tapping the fan speed button again if the fan is on the F5 setting will reset the fan speed to F1.

LIGHTING: Turns lights in the accent ring and the control panel ON/OFF

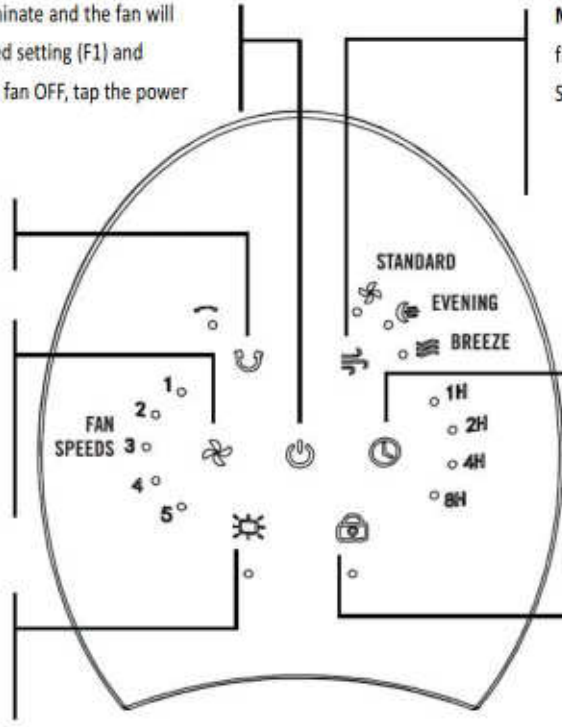

TIMER: Allows for automatic shut off. Time increases by 1 hour with each tap of the button. The LED indicator lights are cumulative for a total of 15 hours. Once the set duration expires, the fan will shut off.

CHILD LOCK: Activate the child lock by tapping and holding the lock button for 3 seconds. This feature will lock all controls including the remote. Tap and hold the lock button again for 3 seconds to reactivate all controls

ATTENTION: When the fan is powered ON using the toggle switch, all indicator lights and the LED ring around the control panel will illuminate for one second and then turn OFF. When the power button on the control panel is used to turn the fan ON, the fan will not beep. However, if the fan is being controlled using the remote control, the fan will beep to confirm that the command was received from the remote control.

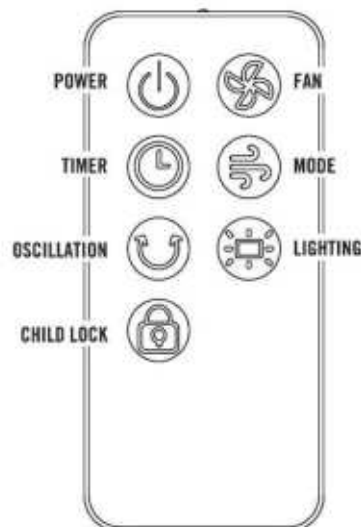

ATTENTION: Please connect the fan to the charger before setting the timer function.

MODE EXPLANATION:

- **STANDARD:** Standard wind mode is simply the F1, F2, F3, F4, and F5 speed settings
- **EVENING:** Evening wind mode gradually decreases fan speeds in 30 min increments until it reaches the lowest fan speed (F1). Example: if Evening wind mode is selected while the fan speed is set to F4, the mode will hold F4, F3, and F2 fans speeds for 30 min each until it reaches F1. Once it reaches F1, it will hold the speed.
- **BREEZE:** Breeze mode automatically selects fan speeds randomly to replicate an outdoor breeze. A breakdown of Breeze mode's function is listed below:
 - **F1 (Eco):** if Breeze mode is selected while the fan is set to the F1 speed, the fan speeds will fluctuate between the F1, F2, and F3 speeds in 75 second cycles with F1 being the most common.
 - **F2 (Low):** if Breeze mode is selected while the fan is set to the F2 speed, the fan speeds will fluctuate between the F1, F2, and F3 speeds in 75 second cycles with F2 being the most common.
 - **F3 (Medium):** if Breeze mode is selected while the fan is set to the F3 speed, the fan speeds will fluctuate between the F1, F2, F3, and F4 speeds in 75 second cycles with F3 being the most common.
 - **F4 (High):** if Breeze mode is selected while the fan is set to the F3 speed, the fan speeds will fluctuate between the F1, F2, F3, and F4 speeds in 60 second cycles with F4 being the most common.
 - **F5 (Extra High):** if Breeze mode is selected while the fan is set to the F3 speed, the fan speeds will fluctuate between the F1, F2, F3, F4, and F5 speeds in 80 second cycles with F4 being the most common.

CHARGING

- This fan includes a wall charger to charge the fan's battery.
- **Only use the provided charger to operate the fan and charge the fan's battery.**

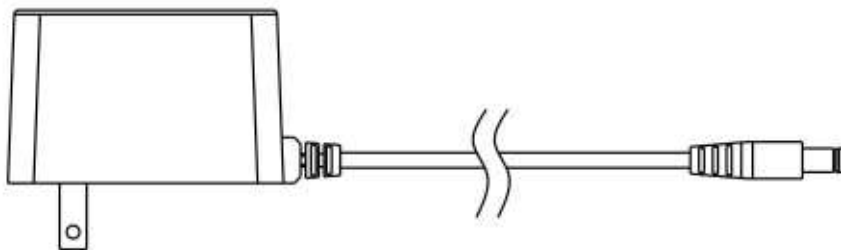

- If the battery is fully depleted, it will take about 4 hours to charge
- **Charging the battery:**
 - Plug the charging tip into the charging port on the back of the fan.
 - Plug the charger into a wall outlet.
 - Attention: The charging indicator light will illuminate red when charging. The charging indicator light will turn blue when fully charged.
 - **Note: When the battery charge is less than 10%, and the fan is not plugged into the charger and charging, the charging indicator light will turn red and flash to providing a warning that the battery capacity is low.**

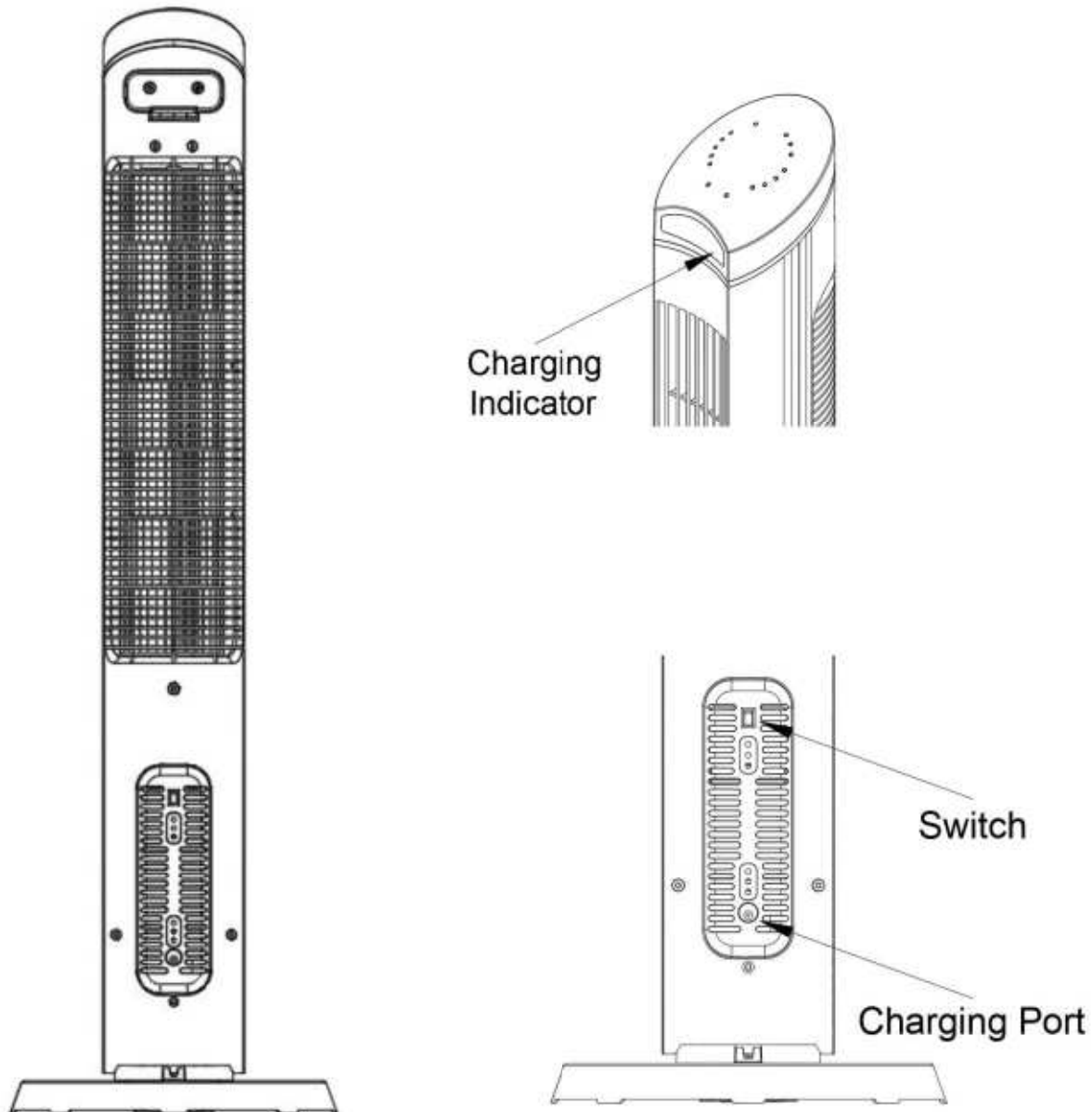

ATTENTION: Due to the large number of features included with this fan, standby power consumption will deplete the battery charge if the fan is not being used and not plugged into the charger. If the fan is not plugged into the charger or used for an extended period, use the ON/OFF toggle switch on the back of the fan to turn the power OFF to preserve battery charge.

Always turn the toggle switch on the back of the fan to the OFF position when storing the fan.

CLEANING AND STORAGE

- To clean your fan, first turn it OFF using the ON/OFF toggle switch on the back of the fan and UNPLUG the unit.
- Use a soft cloth to wipe the housing, DO NOT use water or any other chemical solution or cleaner. DO NOT soak or immerse the fan in water or liquid.
- DO NOT ATTEMPT TO TAKE THE FAN APART.
- Store in a dry place away from excessive heat and direct sunlight.
- Make sure that the ON/OFF toggle switch on the back of the fan is in the OFF position when storing.
- Regular cleaning will ensure optimum performance and appearance of the fan.
- DO NOT kink the power cord when storing or while in use.

REMOTE BATTERY STATEMENT

- Use type CR2025 batteries only.
- Install only new batteries of the same type in your product.
- Failure to insert batteries in the correct polarity, as indicated in the battery compartment, may shorten the life of the batteries or cause batteries to leak.
- Do not mix old and new batteries.
- Do not mix Alkaline, Standard (Carbon-Zinc) or Rechargeable (Nickel Cadmium) or (Nickel Metal Hydride) batteries.
- Danger of explosion if battery is incorrectly replaced.
- Batteries should be recycled or disposed of as per state or local guidelines.

REMOTE CONTROL BATTERY REPLACEMENT

- On the back of the remote, press the release button on the bottom right-hand side. This will allow the tray containing the battery to be released. Release the tray by squeezing the small lip and pulling down the tab at the bottom of the remote (Fig. 2).
- Replace the battery with one new CR2025 button battery. Important: install only new batteries of the same type in your product. Failure to insert batteries in the correct polarity, as indicated in the battery compartment, may shorten the life of the batteries or cause batteries to leak. Do not mix old and new batteries. Do not mix Alkaline, Standard (Carbon-Zinc) or Rechargeable (Nickel Cadmium) or (Nickel Metal Hydride) batteries. Danger of explosion if battery is incorrectly replaced.
- DO NOT DISPOSE OF BATTERY IN FIRE, BATTERY MAY EXPLODE OR LEAK

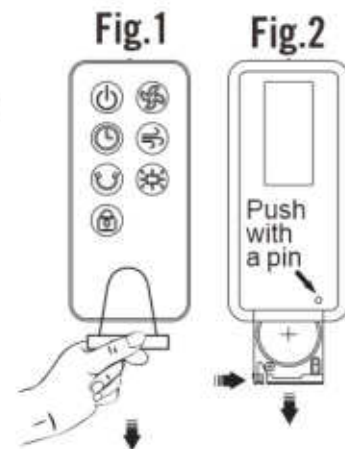

This product contains a button cell battery. If swallowed, it could cause severe injury or death in just 2 hours. Seek medical attention immediately.

Batteries should be recycled or disposed of as per state and local guidelines.

TROUBLESHOOTING

Problem	<ul style="list-style-type: none"> • Fan does not operate
Possible Cause	<ul style="list-style-type: none"> • Battery charge is insufficient to power. • Charger plug is not fully inserted into the wall • Make sure that the ON/OFF toggle switch on the back of the fan is turned to the ON position
Solution	<ul style="list-style-type: none"> • Make sure the charger plug is fully inserted into the wall outlet as well as the back of the fan and charge the fan's battery until the red light above the power button on the fan changes to blue.

HAVE A PROBLEM? PLEASE CONTACT CUSTOMER SERVICE:

Should you have any questions or comments please contact us at:

customerservice@chesapeakeinternationalinc.com

or by phone at 1-888-525-7969



WARRANTY: This product includes a one (1) year warranty, which covers manufacturer defects and workmanship under normal use. Warranty is offered only to the original purchaser. Proof of purchase is required. Proof of purchase constitutes a dated sales receipt. This warranty is void if the product(s) have been subject to abuse such as: being dropped which could result in damage to the product cabinets, motors, product controls, etc. immersion in or exposure to water, exposure to excessive heat, outdoor usage, any use other than household use, disassembly, repair or alteration by anyone other than an authorized service provider, use on improper voltage or current, or any use contrary to the user instructions. Batteries and battery life are not covered in this warranty. **DO NOT** attempt to repair any electrical or mechanical functions of this product; doing so will void this warranty and could lead to injury.

This warranty gives you specific legal rights, and you may also have other rights which vary from state to state.

WARNING: Chemical Burn Hazard. Keep batteries away from children. This product contains a lithium button/coin cell battery. If a new or used lithium button/coin cell battery is swallowed or enters the body, it can cause severe internal burns and can lead to death in as little as 2 hours.

Always completely secure the battery compartment. If the battery compartment does not close securely, stop using the product, remove the batteries, and keep it away from children. If you think batteries might have been swallowed or placed inside any part of the body, seek immediate medical attention.

The cells shall be disposed of properly, including keeping them away from children. Even used cells may cause injury.