

Set Your Combination

Your new Integrated lock is preset to open at 0-0-0. You may change and reset your combination anytime you like. Follow these steps to set your lock:

Step 1

Make sure every digit on your dial is set to the preset starting code 0-0-0.

Step 2

To reset the code, use the tip of a ballpoint pen to press down the **Reset Button** until you hear the "click" sound. After pressing the reset button, adjust each **Dial** to your preferred combination.

Step 3

When you have finalized your new code, press down on the large **Release Button** located to the right side of the lock. If the zippers pop out from the zipper pull, you have correctly set your lock!

Keep your combination in a safe and accessible place for future reference.

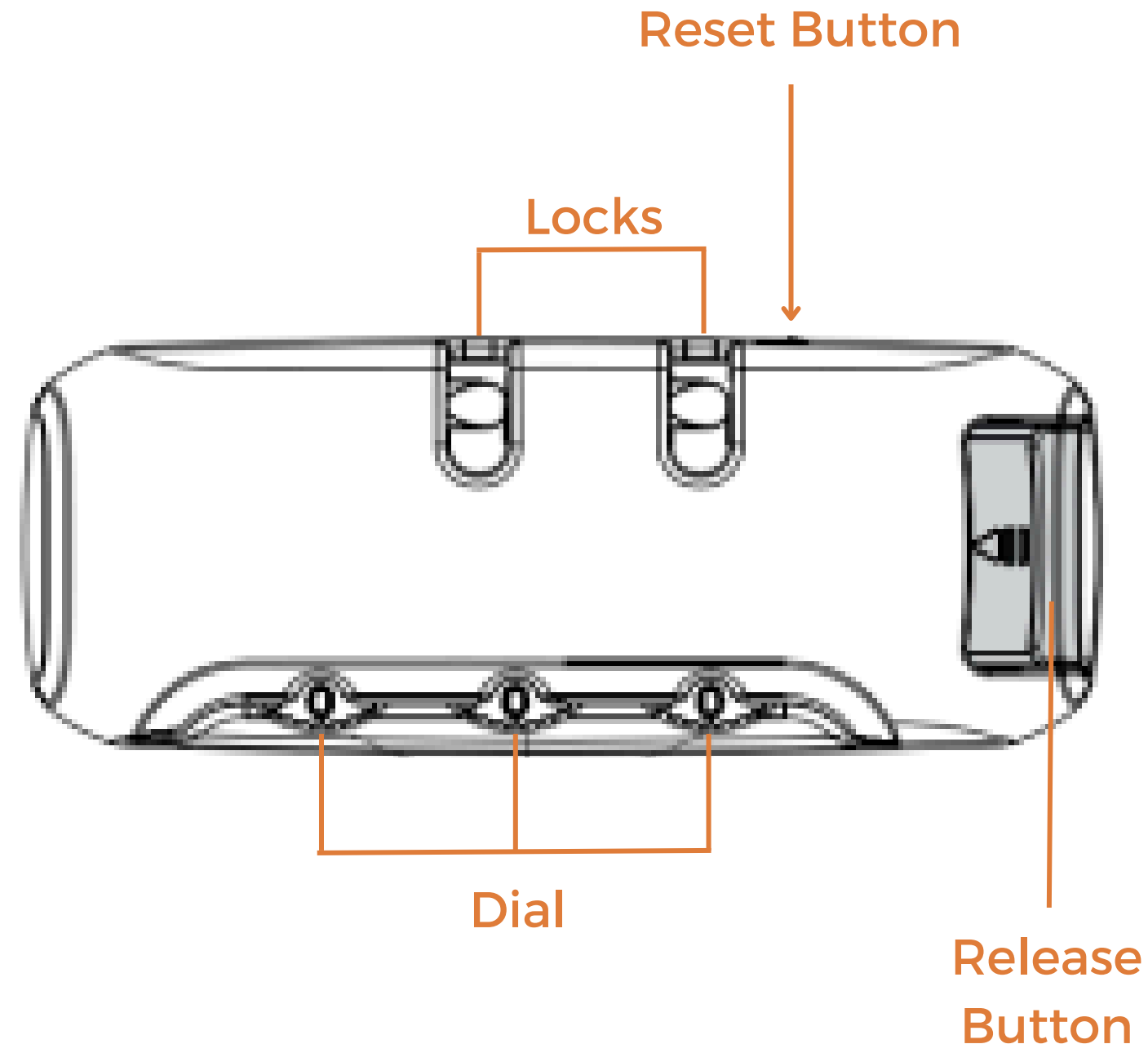

How to Set Your
Combination Video

