

WHAT'S INSIDE:

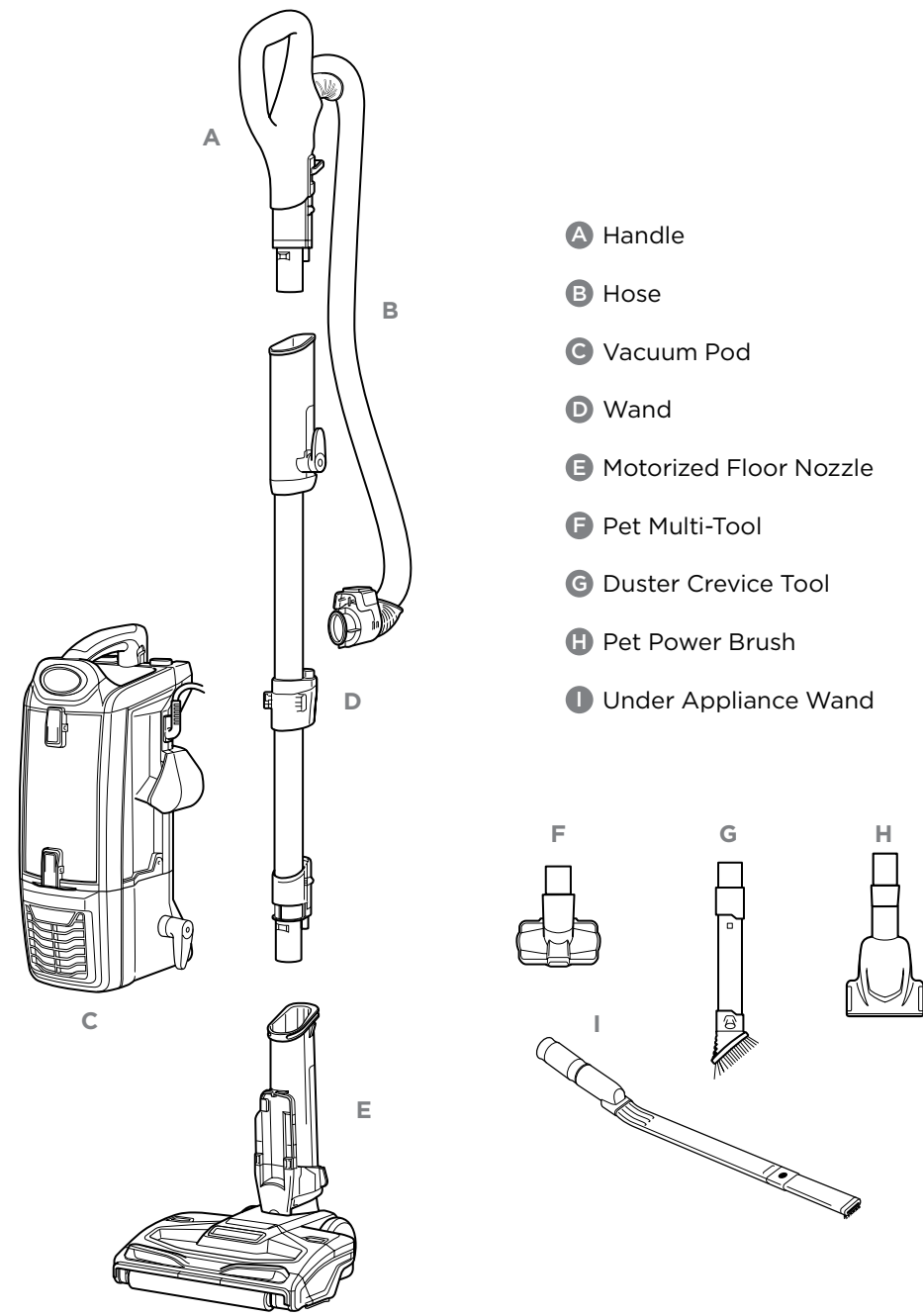

For additional parts and accessories, visit sharkaccessories.com

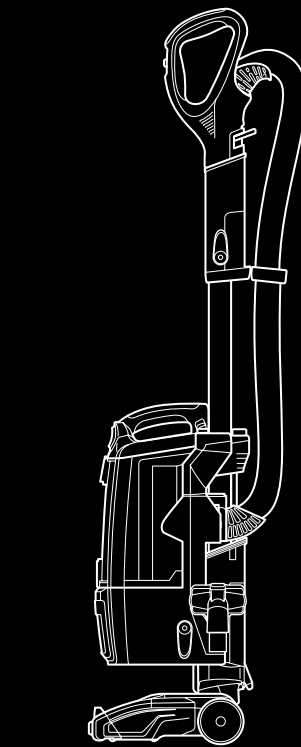

Shark

For questions or to register your product, contact us at
1-800-798-7398 or visit us online at sharkclean.com



@sharkcleaning

©2017 SharkNinja Operating LLC. LIFT-AWAY, POWERED LIFT-AWAY and SHARK are registered trademarks of SharkNinja Operating LLC. DUOCLEAN and JOIN THE CLEAN EVOLUTION are trademarks of SharkNinja Operating LLC.

NV801Q_QSG_170331

Please be sure to read the enclosed Shark® Instruction Manual prior to using your unit.

Shark

POWERED LIFT-AWAY[®] SPEED

duo clean™

NV801Q

QUICK START GUIDE

Use this Quick Start Guide
to learn about your new
vacuum's great features.



ASSEMBLY

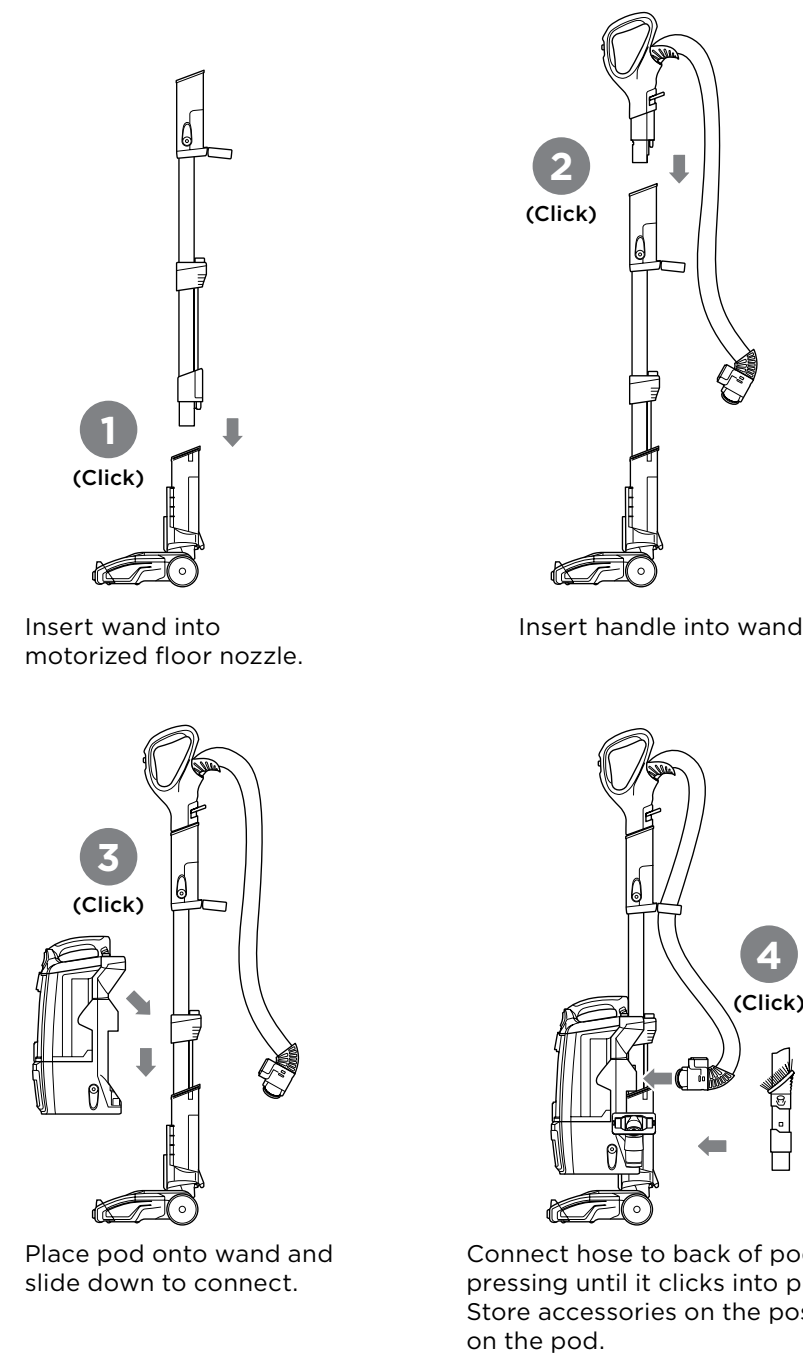

Join The Clean Evolution.™

When it comes to
cleaning, we're not afraid
to get our hands dirty.
At Shark®, we're constantly
working to evolve and
innovate products to meet
the needs of people like
you. Because our job is
to make 5-star-worthy
products that make your
life a whole lot easier.

HAVING TROUBLE?

ISSUE

Vacuum is not picking up debris. No suction or light suction.

Solution

Empty dust cup, clean filters, check all openings for blockages.

ISSUE

Vacuum lifts area rugs.

Solution

Turn off the unit to disengage the brushroll and restart with the Power Button.

ISSUE

Brushroll and/or soft roller does not spin. The Brushroll Indicator Light on the floor nozzle turns red.

Solution

Turn off and unplug the vacuum immediately. Remove any blockages, then reconnect and turn vacuum back on. If Brushroll Indicator Light on the floor nozzle is green, the blockage has been successfully cleared. If the light is still red, please contact customer service at 1-800-798-7398.

3 WAYS TO CLEAN

1

UPRIGHT MODE

Use for carpet and hard-floor cleaning

Floor Type

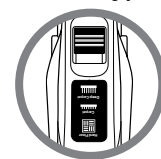

Power Button

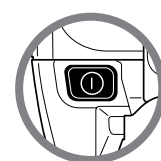

Place foot on floor nozzle and tilt handle back. Choose appropriate floor setting. Press power button.

2

LIFT-AWAY® MODE

Use for portable cleaning on stairs above-floor areas

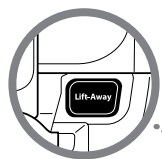

Lift-Away Release



Wand Release

Press Lift-Away® Release button to lift pod off floor nozzle. You are now ready to clean those hard-to-reach places.

Attach any of the specialized cleaning accessories to the handle or wand.

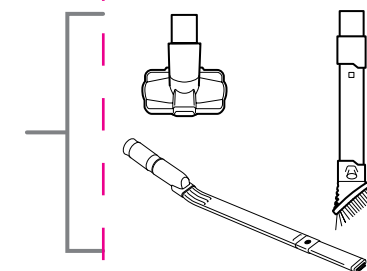

3

CANISTER MODE

Convert your upright to a convenient canister (caddy sold separately)

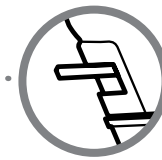
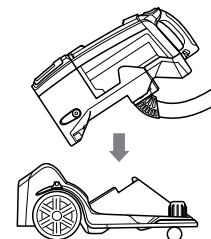

Handle Release

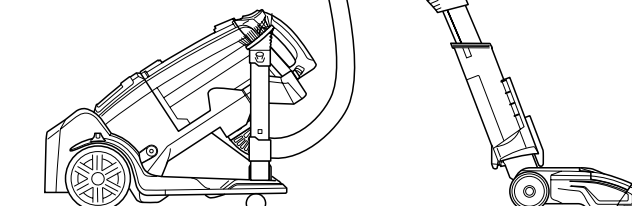

From Lift-Away mode, place pod onto caddy.

When you are done cleaning with your caddy, press the Lift-Away Release button to remove the pod.

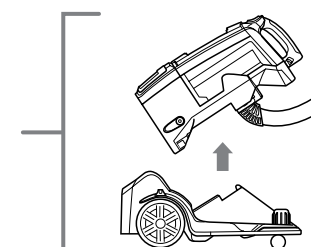

DUOCLEAN™ TECHNOLOGY

ON FLOORS

Direct engagement with the Soft Roller removes large particles, small particles, and stuck-on dust.

Hard Floor

Gentle on bare floor and delicate area rugs.

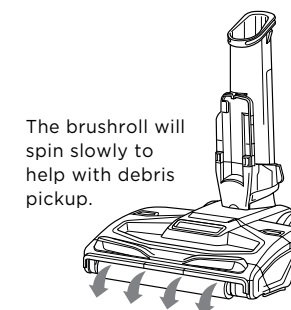

The brushroll will spin slowly to help with debris pickup.

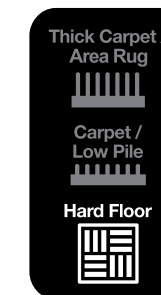

ON CARPETS*

The Soft Roller pulls in large particles, while the deep-cleaning bristle brush removes embedded fine dirt.

Carpet/Low Pile

Optimized brushroll and suction for carpets.

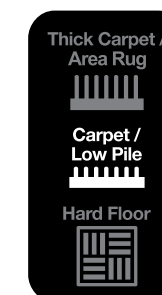

The brushroll will spin faster to help pick up debris below the surface.

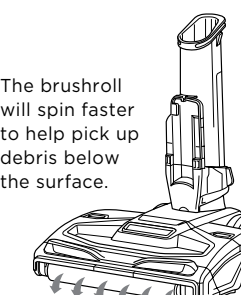

Thick Carpet/Area Rug

Optimized brushroll and suction for thick carpets and delicate area rugs.

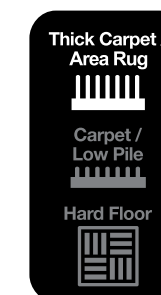

*For deep cleaning per ASTM F 608 (embedded dirt in carpet) use in Carpet/Low Pile mode.

MAINTENANCE

Empty dust cup after each use

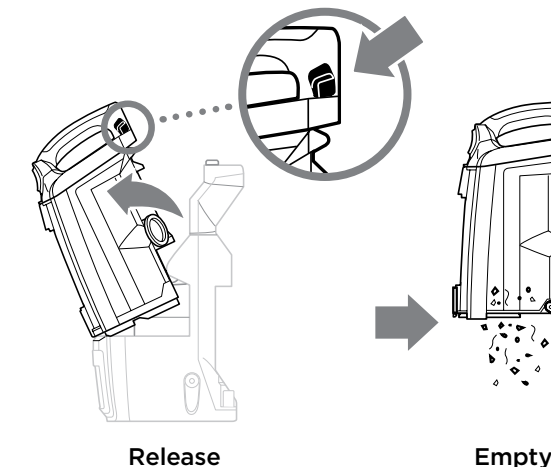

TIP:

Wash filters every 3 months to keep the suction strong.

Rinse filters and allow to air-dry completely. Tap loose dirt from foam filters as needed between washes.

Easy brushroll access: just pop open the garage

Push the release buttons and the brushroll garage door will pop open. Lift out the brushroll to easily remove any string, hair, or debris that may be wrapped around it. Slide the Soft Roller access button up to remove the Soft Roller for cleaning.

