

Soniclean[®]

pro 4800

SMILE
— WITH —
CONFIDENCE[®]



WHAT'S IN THE BOX

Soniclean® Pro 4800

- Sonic Rechargeable Toothbrush Handle
- 12 Total Brush Heads
- Instruction Manual
- 1 Charging Base

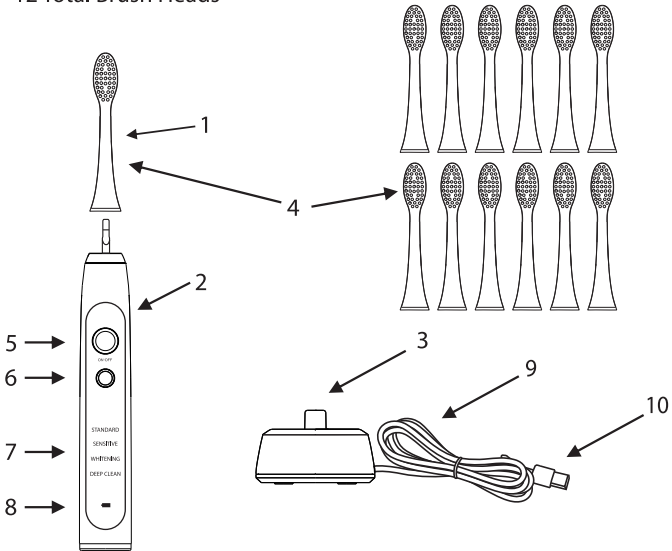

Main Parts

1. Brush Head
2. Handle
3. Charging Base
4. 12 Total Brush Heads
5. Power Button
6. Mode Button
7. Mode Indicator: Standard, Sensitive, Whitening and Deep Clean
8. Charging Indicator
9. Power Cord
10. USB Power Plug

1 Year Warranty

TABLE OF CONTENTS

General Information	4 - 5
General Information and Safety Instructions	4
Important Medical Safeguards	4
Warnings	5
Safety Warnings	5

User Instructions	6
--------------------------------	---

Cleaning and Maintenance	7
---------------------------------------	---

Other Useful Information	8-10
Storing.....	8
Troubleshooting.....	8
Disposal.....	9
Service Center	10
FCC Statement	10

GENERAL INFORMATION & SAFETY INSTRUCTIONS

PLEASE READ AND SAVE ALL INSTRUCTIONS BEFORE USING THE SONICLEAN® PRO 4800 TOOTHBRUSH.

When using an electrical appliance, basic safety precautions should be observed, including the following.

Instructions

1. Always unplug the charging base after the recharging cycle is complete or if the unit will be left unattended for long periods of time.
2. DO NOT use while bathing.
3. DO NOT allow the charging base to become wet or damp.
4. DO NOT place or store the charging base where it can fall or be pulled into water or any other liquid.
5. DO NOT reach for the charging base if it has fallen into water or any other liquid. Unplug immediately.
6. Close supervision is necessary when this product is used by, on, or near children or invalids.
7. Use this product only for its intended use as described in this manual. Do not use attachments not recommended by the manufacturer.
8. Never operate this product if it has a damaged cord or plug, if it is not working properly, if it has been dropped or damaged, or if it is dropped in water. Call the customer service number provided.
9. Keep the cord away from heated surfaces.
10. DO NOT use this product if you feel drowsy.
11. DO NOT use this product outdoors or operate where aerosol (spray) products are being used or where oxygen is being administered.
12. NO object(s) should ever be inserted or dropped into any opening within this product.

Important Medical Safeguards

1. Contact your dentist before using the Sonic Toothbrush if you have had oral or periodontal surgery.
2. Contact your dentist if excessive bleeding occurs or if bleeding continues after the first week of using the Sonic Toothbrush.
3. If you have questions concerning usage with a pacemaker, consult your physician prior to use.
4. This unit is designed for cleaning teeth and gums only. DO NOT use it for any other purposes.
5. The Sonic Toothbrush can be used with any leading brand of toothpaste.

Warnings

Read and understand all instructions. Failure to follow all instructions listed below may result in electric shock, fire or serious personal injury. The warnings, cautions, and instructions discussed in this instruction manual cannot cover all possible conditions and situations that may occur. It must be understood by the operator that common sense and caution are a factor which cannot be built into this product, but must be supplied by the operator.

CAUTION: A short power supply cord is provided to reduce the risk of personal injury resulting from becoming entangled in or tripping over a longer cord.

Electric Power

If electric circuit is overloaded with other appliances, your appliances may not operate properly. The appliances should be operated on a separate electrical circuit from other operating appliances.

Safety Warnings

Although your appliance is easy to operate, for your safety, the warnings below must be followed:

1. Do not place the appliance near a heat source.
2. Use the appliance on a stable surface.
3. Do not unplug by pulling on the supply cord.
4. The appliance must be unplugged:
 - A. Before any cleaning or maintenance.
 - B. If it appears to be faulty.

USER INSTRUCTIONS

1. Place the Sonic Toothbrush base on a level and dry surface. Check the USB cord before you connect the local mains.
2. Never use the charging base if it is damaged in any way. If the USB cable is damaged, always have it replaced with one of the original type in order to avoid a hazard.
3. Place the handle into the base. The LED charging indicator light will light up on the handle to indicate the handle is charging. Please note, the LED indicator light will stay on so long as the handle is sitting in the charging base and it is plugged in.
4. It will take approximately 24 hours for a full charge the first time. The charger may stay plugged in, but it is recommended that the unit be unplugged if it will not be used for an extended period of time, i.e. vacation.
5. Fully discharge the handle at least every 6 months in order to maintain the maximum capacity of the rechargeable batteries. This can be achieved by unplugging the base and letting the handle run down with normal use.
6. Insert the brush head onto the shaft of the handle. There will be a small space (1mm) between the brush head and the handle. This allows for a free motion of the brush head during brushing.
7. Apply toothpaste to the brush head before switching it on.
8. Select the desired mode, Standard, Sensitive, Whitening, or Deep Clean, by repeatedly pushing the mode button. The speed indicator light will light up with each push and will switch from Standard, Sensitive, Whitening, Deep Clean and then repeat.
9. Move the brush head gently along your teeth and gum line and allow the brush heads to stay on the surface of each tooth for a few seconds with a slight circular motion for the best cleaning and gum massaging effect.
10. This unit comes with a built in timer that will pulse 3 times at the end of 30 seconds. This allows the brusher to concentrate on each quadrant of your mouth for 30 seconds with a total brushing time of 2 minutes. **DO NOT** forget to reach all areas of your teeth including the inner and chewing surfaces and behind your back teeth.
11. After 2 minutes, the handle will automatically turn off. After use, rinse the brush head under a tap and wipe the handle dry.

Note

When you first use your Sonic Toothbrush, you may experience slight bleeding. This should stop after a few days when your gums get used to the toothbrush. If the bleeding persists, please consult your dentist or hygienist.

CLEANING & MAINTENANCE

Cleaning and Maintenance

1. Disconnect the charging base cord from the outlet.
2. DO NOT immerse the base, power cord or plug in water or any other liquids.
3. Brush Heads: After each use, rinse the brush head for several seconds under running water. You may soak the brush head in denture cleanser every 2 to 4 weeks to keep it hygienically clean.
4. Charging Base and Handle: Periodically clean the exterior of the handle and charging base with a soft, slightly damp towel or paper towel. Dry thoroughly before plugging back into the outlet and placing the handle back on the charger.
5. DO NOT wrap the power cord around the charging base.
6. This unit has no serviceable parts, therefore NO altering or servicing should be performed by any unauthorized representative.

OTHER USEFUL INFORMATION

Technical Specifications

Rated Wattage	0.8 – 1.6W
Rating Voltage	100 - 240V
Rechargeable Battery	Lithium-ion battery

Storing

Store the unit in a dry location. Do not place any heavy items on top of unit during storage as this may result in possible damage of Sonic Toothbrush.

Troubleshooting

Problem	Possible Cause	Solution
The toothbrush doesn't work.	You have just purchased the product or it has not been used for more than 3 months.	Charge the main unit for at least 24 hours.
Weak or diminished vibration.	The toothbrush is pressed hard against your teeth.	Place the brush head gently against your teeth.
The toothbrush operates only for a short period of time even immediately after being charged.	The battery has reached the end of its life cycle.	Contact service center for support.
	Charging time was insufficient.	Charge the main unit for at least 24 hours.

Disposal

The power source of this product is Lithium-ion battery which can be recycled. At the end of the product's life, always remove the battery before you discard the product, and recycle or dispose of the battery according to local waste management requirements. If you have recycling questions, contact your local waste management office.

Removing and recycling the battery:

Do not disassemble the product at any time other than when disposing of it. Doing so earlier will destroy the product. Observe basic safety precautions.

The appliance must be disconnected from the outlet when removing the battery.

- 1 Before removing the battery, be sure to completely drain the unit of power.
- 2 Use a screwdriver to remove the screw cover and battery door.
- 3 Hold the handle upside down, press the toothbrush shaft and remove the two hooks to release the internal components of the handle.
- 4 Insert the screwdriver next to the battery connections and twist to break the connections. Remove the circuit board and pry the battery from the plastic carrier.
- 5 Recycle or dispose of the battery properly. Ask your local waste management office if they accept the remaining toothbrush components for recycling.

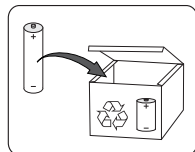
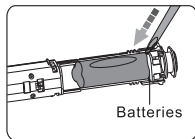
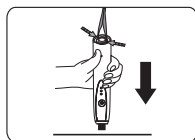
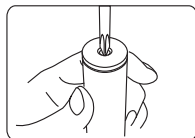

Be careful not to short-circuit the negative and positive poles of the battery. Do not connect the appliance to the outlet again after you have removed the battery.

Service Center

If you have any questions in regards to the operation of this appliance, please contact our service center at:

Ashtel Studios Inc.
Ontario, CA 91761

Tel: 1-877-274-8358

(Business hours Mon – Fri 11:00 AM – 8:00 PM EST)

Email: support@brushbuddies.com

Environmental Protection

If the appliance should no longer work at all, please make sure that it is disposed of in an environmentally friendly way.

FCC Statement

FCC Information

This device complies with part 15 of the FCC Rules. Operation is subject to the following two conditions: (1) This device may not cause harmful interference, and (2) this device must accept any interference received, including interference that may cause undesired operation.

WARNING: Changes or modifications to this unit not expressly approved by the party responsible for compliance could void the user's authority to operate the equipment.

NOTE: This equipment has been tested and found to comply with the limits for a Class B digital device, pursuant to part 15 of the FCC Rules. These limits are designed to provide reasonable protection against harmful interference in a residential installation. This equipment generates uses and can radiate radio frequency energy and, if not installed and used in accordance with the instructions, may cause harmful interference to radio communications. However, there is no guarantee that interference will not occur in a particular installation. If this equipment does cause harmful interference to radio or television reception, which can be determined by turning the equipment off and on, the user is encouraged to try to correct the interference by one or more of the following measures:

- Reorient or relocate the receiving antenna.
- Increase the separation between the equipment and receiver.
- Connect the equipment into an outlet on a circuit different from that to which the receiver is connected.
- Consult the dealer or an experienced radio/TV technician for help.



Soniclean®