

...UPDATED INSTRUCTIONS...

Back-Saver Rolling Work Seat

WEIGHT LIMIT: 300LBS

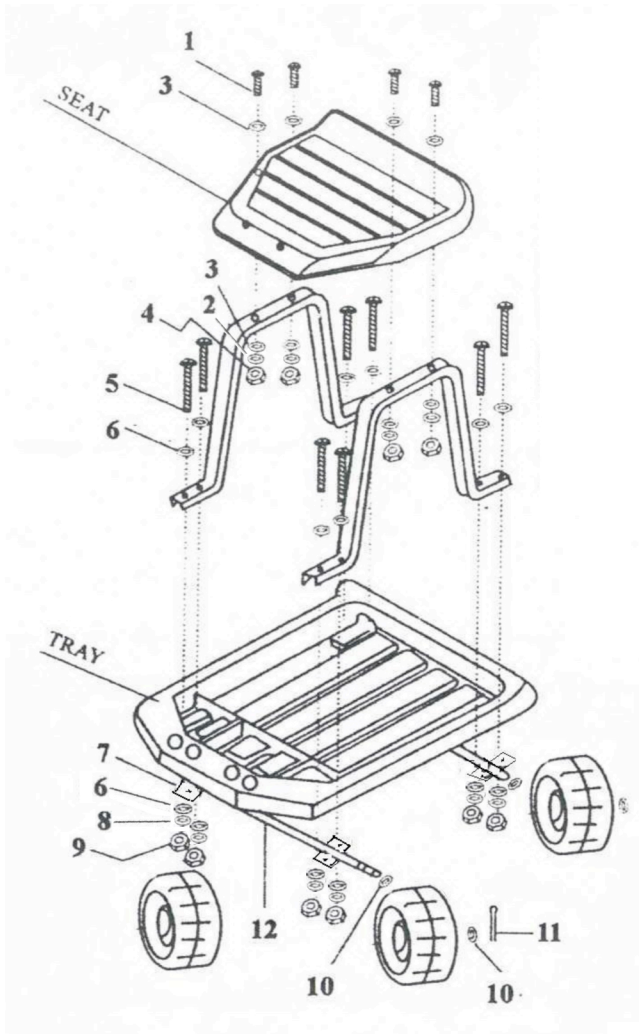

PARTS/CONTENTS

SEAT (1 PC)
LEG BRACES (2 PCS)
LOWER TRAY (1 PC)
WHEELS (4 PCS)

HARDWARE AS FOLLOWS:

1. SMALL BOLTS (4 PCS)
2. SMALL LOCK WASHERS (4 PCS)
3. SMALL FLAT WASHERS (8 PCS)
4. SMALL NUTS (4 PCS)
5. LARGE BOLTS (8 PCS)
6. LARGE FLAT WASHERS (16 PCS)
7. METAL PLATES (4 PCS)
8. LARGE LOCK WASHERS (8 PCS)
9. LARGE NUTS (8 PCS)
10. FLAT WHEEL WASHERS (8 PCS)
11. COTTER PINS (4 PCS)
12. AXLES (2 PCS)

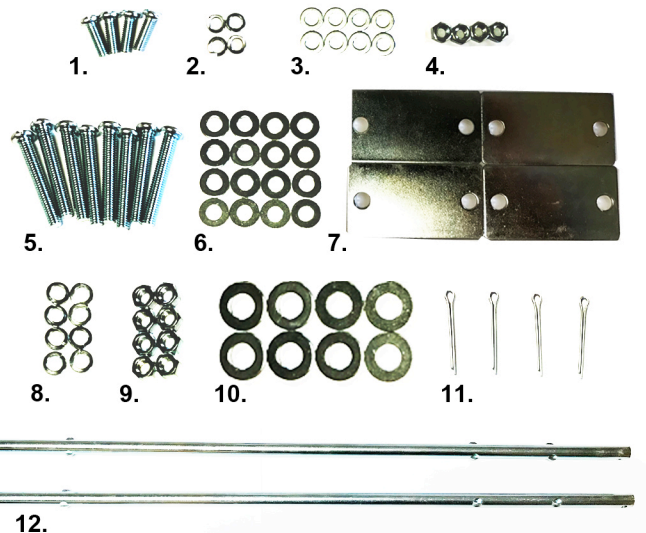

ASSEMBLY

1. Thread a small washer (#3) onto a small bolt (#1) and insert into one of the holds in the top of the seat.
2. Align a leg brace as shown in the drawing and push the bolt end through the appropriate hole in the leg brace.
3. Thread a small flat washer (#3) onto the small bolt (#1), then a small lock washer (#2) and secure everything with a small nut (#4).
4. Repeat steps 1-3 for each of the 4 holes in the seat and tighten all 4 nuts securely.
5. Align the 4 leg brace ends with the lower tray as shown in drawing.
6. Thread a large flat washer (#6) onto a large bolt (#5) and push it through one of the holes in the leg brace and through the lower tray (Do not use the center hole).
7. Press one of the axles (#12) into the slot on one of the metal plates (#7)
8. Align the axel clamp as shown in the drawing and slide it over the bolt.
9. Slide a large washer (#6) and then a large locking washer (#8) over the large bolt (#5) and secure with a large nut.
10. Repeat steps 5-9 for the other 7 large bolts and tighten all nuts securely.
11. Slide a flat wheel washer (#10) over one axel end. Slide a wheel over the axel then follow with another flat wheel washer.
12. Slide a cotter pin through the hole in the end of the axel and spread the 2 legs apart.
13. Repeat steps 11 & 12 for each wheel.
14. Tighten all connections and test for sturdiness before use.