



Scan for Quick Start Video

Solar Bug Trap User Manual for DT030-GN, DT030-BK, DT030-SB & DT030-GR

The Dynatrap Solar Bug Trap is an advanced insect trap that uses UV LED light to attract mosquitoes and other flying insects. Once lured, insects are quietly and efficiently drawn in by a fan and captured in an easy-to-empty catch basket. Ideal for indoor and outdoor use, it features multiple operating modes and flexible power options for maximum convenience.

Getting Started

What's in the Box

- 1 Dynatrap® Solar Bug Trap
- 1 power cord (USB-C)
- 3 removable legs (for tabletop use)

Power Options

Your trap can run from three power sources for maximum flexibility.

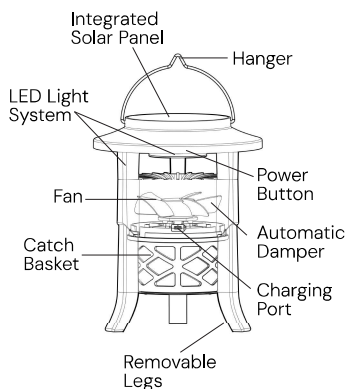

Power Option	What to do	When to use
Solar	Place the trap in direct sunlight to charge via the built-in solar panel. Note: Trap run-time from solar charge is dependent on sun intensity and will be less than run-time from full charge when plugged in.	In areas with ample sunlight.
Cordless	Charge the trap, then unplug it for placement. It takes approximately 3.5 hours for the battery to fully charge. The trap can run for up to 7 hours on a full charge.	In areas that do not have ample sunlight or access to a wall outlet.
Plug	Connect the power cord to the trap and plug it into a standard wall outlet for continuous use.	Recommended if you want to run your Dynatrap 24/7 for maximum protection.

How to Charge

1. Connect the power cord to the trap and plug into a standard wall outlet.
2. A red LED light under the lid will illuminate to show that charging is in progress.
3. Once fully charged, the LED light will turn green.

How to Operate

Powering ON: Press the Power Button one time.

Powering OFF: Press the Power Button repeatedly until the fan, center light, pillar lights and lantern light turn OFF.



Your trap can function in two modes: Manual Mode or Automatic Mode.

Manual Mode

- The trap is turned ON and OFF manually, with the operating function chosen by the user.
- This mode is ideal for users who wish to control when the trap runs or operate the trap continuously, 24/7.

Automatic Mode

- Dusk-to-Dawn feature turns on at dusk and off at dawn when trap is plugged in.
- Once set, the trap keeps the selected setting and operating function until the user changes it.

Mode	How to Select
Manual Mode	Trap arrives in Manual Mode (default setting). Simply turn trap ON by pressing the power button one time.
Automatic Mode (Dusk-to-Dawn)	To enter Automatic Mode: 1. Trap must be turned ON and in Manual Mode. 2. Navigate to your desired operating function (Standard, Enhanced or Lantern--see table below). 3. To activate Automatic Mode, press and hold the power button for 4 seconds until the pillar lights flash three times. The trap will now turn ON at dusk and OFF at dawn in the selected operating function. To exit Automatic Mode: 1. Press and hold the power button for 4 seconds until pillar lights flash two times. The trap is now in Manual Mode.

Operating Functions

Next, select your preferred operating function.

Function	When to use	What to do	What you'll see
Standard Trapping	Insect activity is low to moderate	From the OFF position, press the power button one time .	Center UV light and fan ON
Enhanced Trapping	Insect activity is high	From the OFF position, press the power button two times .	Center + Post UV lights and fan ON

Function	When to use	What to do	What you'll see
Lantern (white light only, no trapping)	During evening or nighttime hours for additional light. Note: When your Dynatrap is in the Lantern function, trapping functions are disabled.	From the OFF position, press the power button three times.	Center light ON, fan OFF

Place Your Device

You can place your trap two ways:

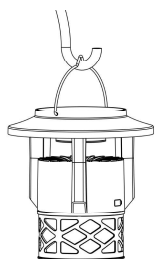

Hanging

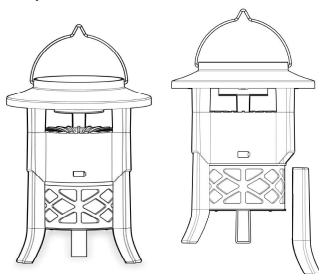

Standing by adding the legs



For best results, we recommend placing your trap:

- 3 to 6 feet above the ground
- 20 to 40 feet away from your area of enjoyment
- Away from main light sources

Maintenance

Clean the trap at least once a week to extend the lifespan of the trap, ensure fire prevention, promote more effective solar charging, and ensure overall efficient operation.

- Unplug before cleaning.
- Twist the catch basket counterclockwise to remove the catch basket. Remove the damper by grasping and lifting the center crossbar.
- Remove insect debris and any buildup from inside the catch basket.
- Replace the damper by placing it back into the basket.
- Reattach the catch basket to the trap by (1) aligning the opening at the top edge of the basket with the leg positions on the upper trap assembly and (2) turning the catch basket clockwise to lock it into place.
- Close the charging port cover when trap is not in use.

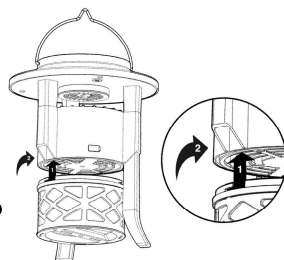

Safety

- Always keep the catch basket clean to ensure optimal airflow.
- Use only the provided power cord.
- Do not clean the trap with water spray.
- Do not submerge the trap in water.
- Avoid placing the trap in heavy rain or extremely dusty environments.
- To reduce risk of injury from moving parts or electric shock, always turn OFF and disconnect plug when not in use and before cleaning.
- Do not position the trap near heat, gas, oil or other flammable materials.
- Do not abuse the cord. Never carry or hang the trap by the cord or yank it to disconnect from receptacle. Keep cord away from sharp edges.
- Never operate the trap if it has a damaged cord or plug, if it is not working properly, if it has been dropped or damaged, or if it has been dropped into water or other liquid.
- When using outdoors, connect only to a circuit that is protected by a ground-fault circuit-interrupter (GFCI).
- When using outdoors, use only extension cords with a tag stating "Suitable for Use with Outdoor Appliances."

Troubleshooting

Issue	Solution
Trap not turning on or lights not working	<p>Make sure you press the power button to turn the trap ON.</p> <p>Ensure the trap is charged and/or plugged in securely. Check the plug, receptacle and fuse or circuit breaker.</p> <p>Note: If the trap is in Dusk-to-Dawn mode, it will only operate in dark conditions.</p>
Fan not working	<p>Make sure you press the power button to turn the trap ON.</p> <p>Check the power cord cable connection and power source.</p> <p>Turn the trap OFF and remove the catch basket. Ensure the fan is clear of foreign material, dirt or build-up of insect debris. See the "Maintenance" section.</p>
Dusk-to-Dawn Mode not active	<p>Make sure your trap has power (is fully charged or plugged in).</p> <p>Hold the button in the Enhanced Trapping function for 4 seconds to enable.</p> <p>Note: If the trap is in Dusk-to-Dawn mode, it will only operate in dark conditions. See the "How to Operate" section.</p>
Catch basket not staying attached	See the "Maintenance" section.
Solar charger not working	<p>Ensure the trap is placed in a location with full sun during the day.</p> <p>Ensure your solar panel surface is clean.</p>