

FLAT-PANEL

HDTV ANTENNA OUTDOOR /
INDOOR USAGE

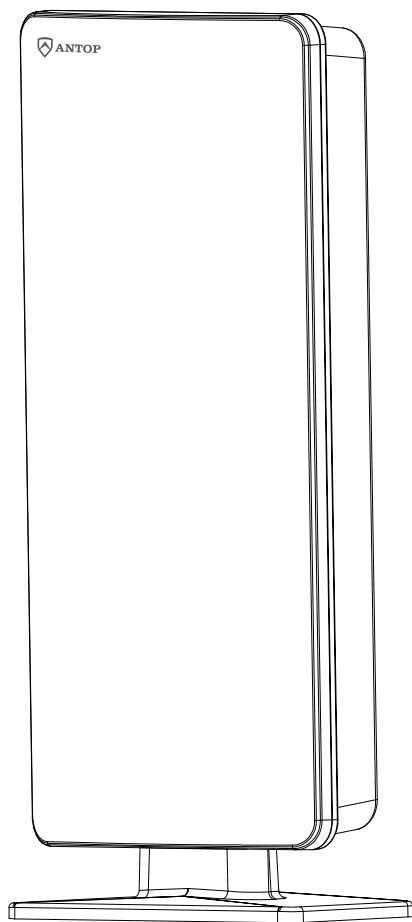

AT-400

Installation Instruction Manual

Your FLAT PANEL HDTV Antenna / AT-400 can be used either as an outdoor or indoor antenna. Antop's New Generation Digital Technology allows you the flexibility to set up your antenna in various locations and still receive a great digital reception.

ANTOP's New Generation Digital Technology

- High Gain: designed to match similar gain of traditional bulky, unsightly mechanical antennas

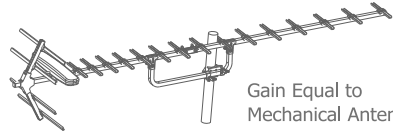

Gain Equal to Mechanical Antennas

- Each Antop antenna is supported by a team of dedicated international product engineers to ensure you receive the highest quality product.

Following are instructions for installation options for outdoor use as a mast pole mount or wall mount, as well as for indoor options in an attic or placed on a table top. Read through all instructions prior to beginning installation procedure.

Note: Although this antenna is great for indoor and outdoor use, a higher mounting location positioned towards the broadcast tower may result in better reception. Install the antenna as high as possible, and preferably with a clear path between the antenna and the TV station transmitters. Trees, buildings, mountains, etc., can all impact the performance of any antenna. This antenna can also be placed in attic.

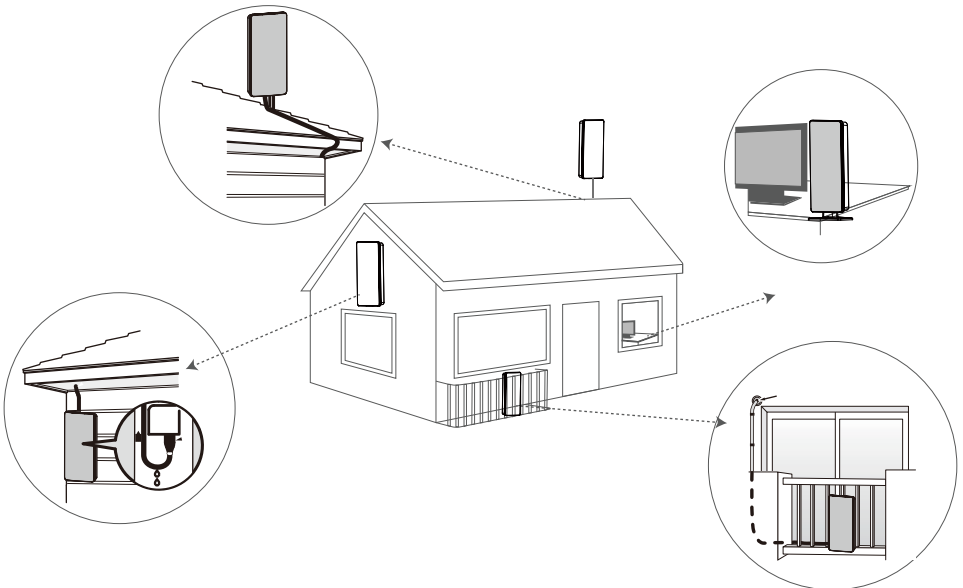

1 / Installation for Outside Use

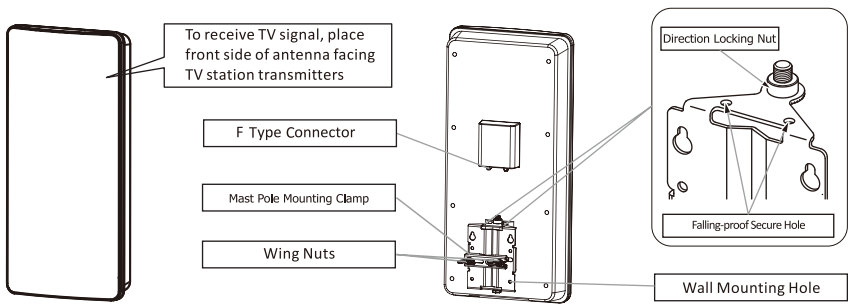

1.1 For Outdoor Use, Mast Pole Mounting

Install a mast pole (not provided) on the house, preferably on rooftop or the side of the house facing the TV station transmitters. Attach the antenna to the mast pole by using the clamp kit provided.

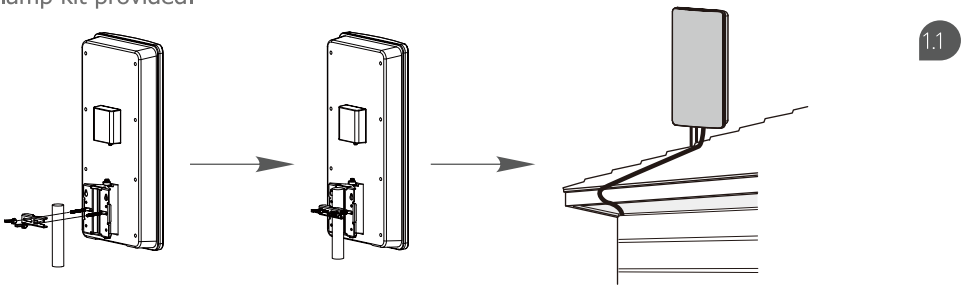

1.2 For Outdoor Use, Wall Mounting

To remove antenna hardware from backside of unit, release fastening bolt by turning counter clockwise. Determine the location on the wall where the antenna is to be mounted, preferably on the side of the house facing the TV station transmitters. The antenna can be mounted onto the wall horizontally or vertically. Fasten the antenna hardware onto the wall with screws (screws not provided).

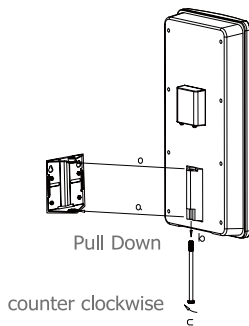

1.2

1.2.1 Horizontal or Vertical Mounting

Mount hardware horizontally or vertically to the wall. Before attaching hardware back to the antenna, see Connecting instructions. To attach hardware back to backside of antenna, insert fastening bolt and turn clockwise.

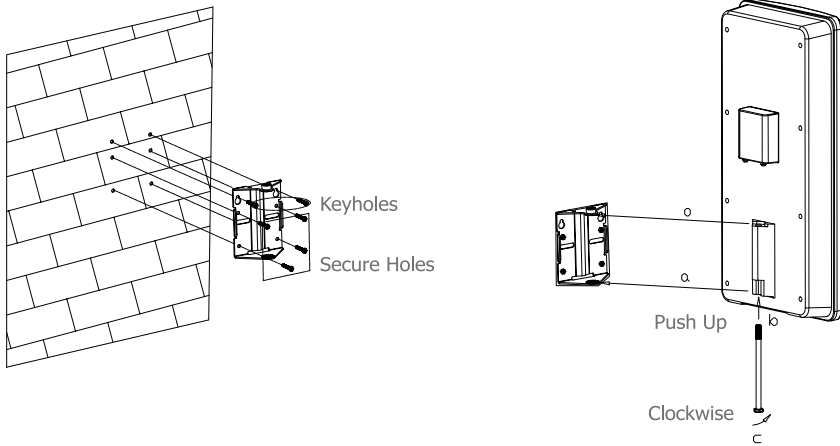

1.3 For Indoor Use, In Attic

Determine location in attic where antenna will be placed. To mount antenna onto a beam or wall, preferably on the side of the house facing the TV station transmitters, remove antenna hardware from backside of unit, release fastening bolt by turning counter clockwise. The antenna can be mounted horizontally or vertically. Fix the antenna hardware onto the beam or wall with screws (screws not provided). Before attaching hardware back to the antenna, see Connecting instructions. To attach hardware back to backside of antenna, insert fastening bolt and turn clockwise.

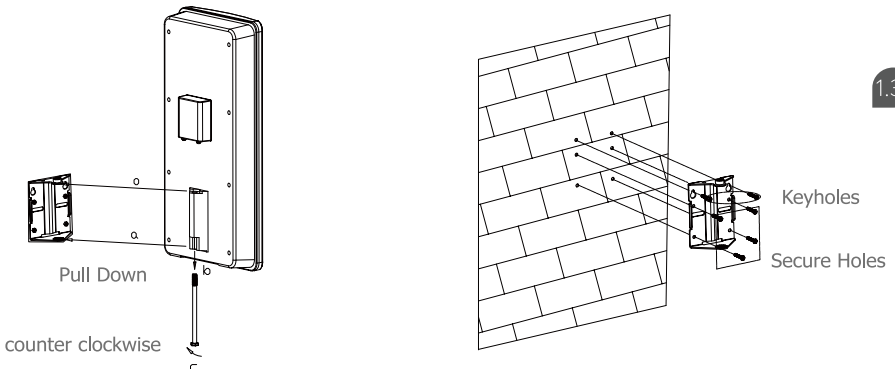

1.4 For Indoor Use, with Table Stand

To remove antenna hardware from backside of unit, release fastening bolt by turning counter clockwise. Attach the Table Stand to the bottom of antenna.

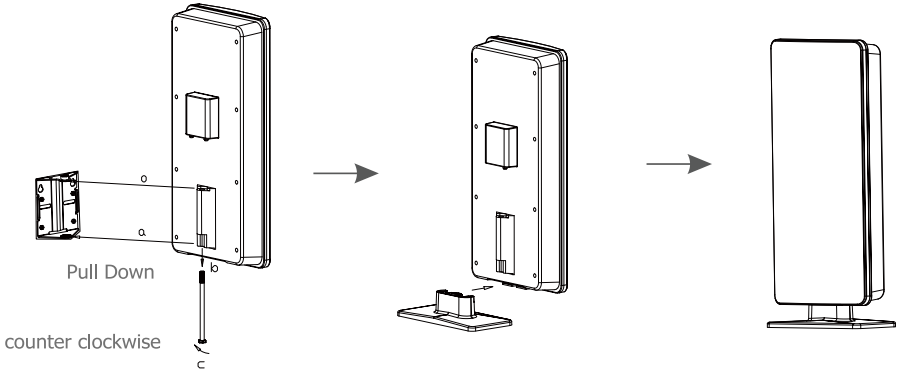

2 / Connecting

2.1 For Outdoor Use, Mast Pole or Wall Mount Preparation for Connection

2.1.1 Select entry point to house. Drill a hole under the eaves at entry point. Attach coaxial cable with water proof cap end to connector on the antenna. For Vertical Wall Mount, utilize U-shape coaxial cable setup to prevent water from entering interior of antenna casing. For Wall Mounts, attach antenna back to hardware already mounted to wall. With antenna fixed to either a mast pole or an exterior wall, feed loose end of coaxial cable through drilled opening.

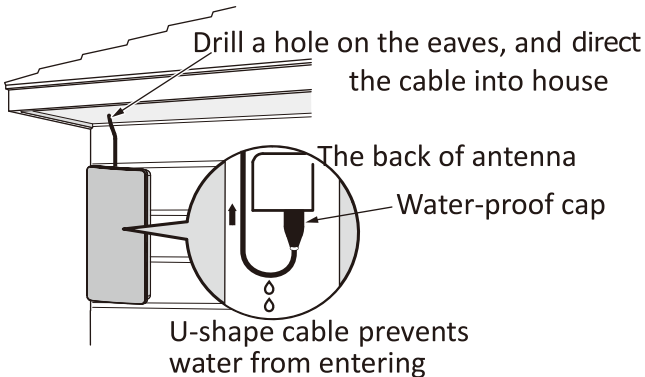

2.2 For Indoor Use, in Attic placement, Preparation for Connection

Select entry point to house. Drill a hole at entry point. Attach coaxial cable with water proof cap end to connector on the antenna. Attach antenna back to hardware already mounted to beam or wall, or just use the table stand for placement. Feed loose end of coaxial cable through drilled opening.

2.3 If you haven't already done so, attach coaxial cable to connector on the antenna

Connect other end of the coaxial cable to the ANTENNA/CABLE IN connector on the back of the TV or converter box.

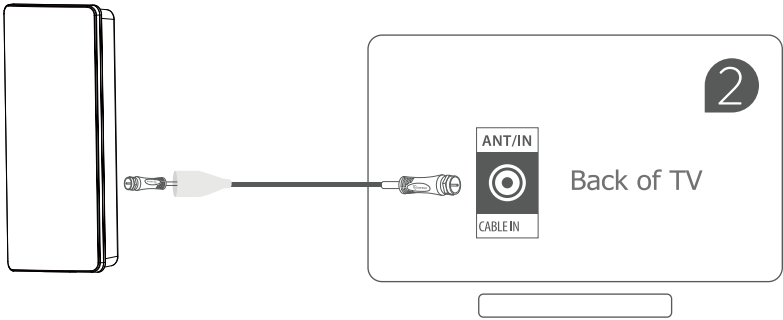

3 / Setting and Scanning

In the TV's setup menu, set the mode to "Antenna" or "Air", then, set TV to "Scan" for channels. Consult the TV manual for detailed instructions.

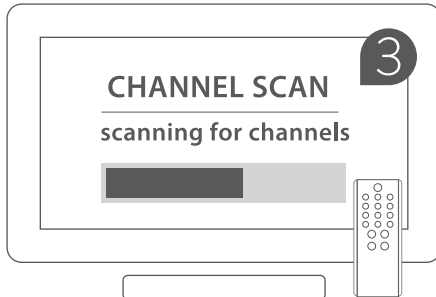

4 / Adjustment Instructions

For the best reception, adjust the direction of antenna. Based on wall mounting, the antenna can be turned left or right within 45° angle by releasing the bolt.

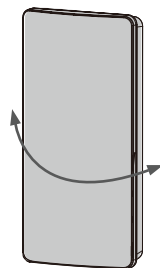
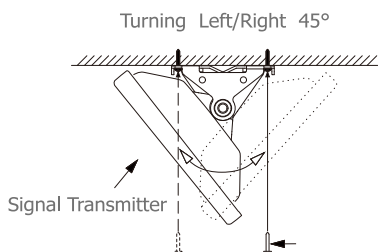
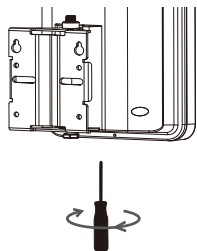

WARRANTY POLICY

Customers should first contact their place of purchase to determine the reseller's warranty policy. Antop Antenna's warranty will take effect after the expiration of reseller's policy. **Antop Antenna**, warrants its products for a period of one (1) year from the original date of purchase. Warranty is valid only with proof of purchase. Warranty does not apply to defects or failures of the product caused by: neglect, misuse, negligence, accident, abuse, mishandling, misapplication, alteration, modification, power outage, unauthorized/unreasonable use, or any uncontrollable environmental damage.

RETURNS & REFUNDS

For any return, customers should first contact their place of purchase to determine the reseller's return policy. If purchased directly from Antop Antenna or before returning directly to Antop Antenna, a Return Material Authorization (RMA) number must be obtained in advance by contacting Antop Antenna customer service via e-mail or telephone. Merchandise returned to Antop Antenna must have an RMA number displayed on the box and a copy of your proof of purchase inside the package. Absolutely no refund after 30 days of purchase from Antop Antenna. A restocking fee of 15% may be deducted from any refund, ask representative for further details. Refund policy for US & Canada customers only.

EXCHANGE & REPLACEMENT

For any exchange or replacement, customers should first contact their place of purchase to determine the reseller's policies. No upgrades or exchanges for different models or SKU's. One (1) Year limited manufacturer's warranty for exchange of product due to malfunction, failure or defect, missing parts or components. Exchanges will be for the same item, model and/or SKU, within one (1) year of original purchase date. A Return Material Authorization (RMA) number must be issued by Antop Antenna prior to returning any product or part. To obtain an RMA, contact Antop Antenna via email or telephone.

SHIPPING & COSTS

Customer will be responsible for shipping costs of merchandise sent to Antop Antenna. Please consult a customer service representative for details. When shipping any item to Antop Antenna, please consider using a trackable shipping method. Antop Antenna cannot be held responsible for lost or misdirected shipments. Exchanged and returned products must be sent to: Antop Antenna, RMA Department, 1650 S. Balboa Ave, Ontario, California 91761. To receive a Return Material Authorization from Antop Antenna please send your request to RMA Dept: Support@antopusa.com or to speak to Customer Service: via telephone, M-F, 9am to 5pm (PST) 909-947-8883.

www.antopusa.com

ANTOP ANTENNA INC | Tel. 909.947.8883 | Email: Support@antopusa.com