

尺寸: 210mm x 148mm
 材质: 书写纸100g (正反面印刷)

BP300 Portable Power Station Quick Guide

The BP300 power station will automatically turn off after 30 seconds if no devices connected to it are pulling a current greater than 100mA. To disable this auto-off function turn on the power station by pressing the power button for 3 seconds. The power station will remain on for 6hrs.

How To Use The Power Station

a

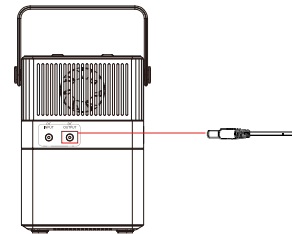

Using with DC Devices

Connect the DC appliance to the power station's 5.5mm 12V DC port. The power station will automatically turn on and supply power to the device.

b

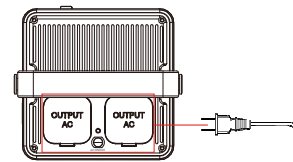

Using with AC Devices

Connect the AC appliance to one of the BP300 power station's AC sockets. Press the AC button for 3 seconds to turn on the AC current and supply power to the device.

c

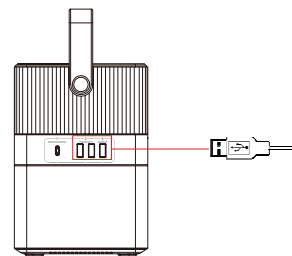

Using with USB Devices

Connect the USB cable to one of the BP300 power station's USB sockets. Connect the other end to your USB device. The power station will automatically turn on and supply power to the device.

d

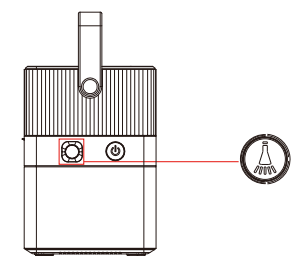

Using the LED Flashlight

1. Turn on
To turn on the LED flashlight press the power button.
2. Change light modes
To cycle between the different lighting modes press the power button. (On/SOS/Strobe/Off)
3. To turn off
To turn off the LED light press the power button for 3 seconds.

BP300 Portable Power Station Quick Guide

Charging The Power Station

a

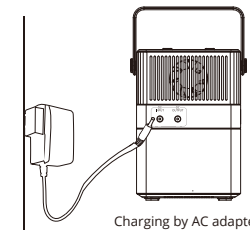

With an AC Power Source

Connect the AC adapter that comes with the package to the AC outlet. Connect to the other end of the AC adapter to the input port. When fully charged the display will turn off.

b

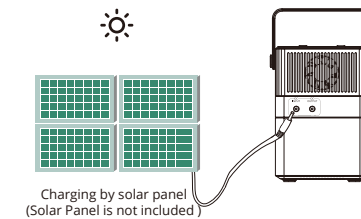

With Solar Panel

Place the solar panel in a place where there is strong direct sunlight. Connect the output of the solar panel to the charging input of the power station.

c

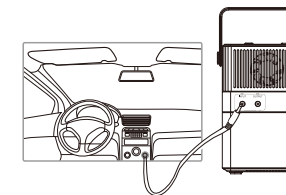

With a Vehicle Charging Cable

Connect one end of the charging lead to the DC Input Port. Start your vehicle's engine and connect the other end of the charging lead to your vehicles auxiliary/cigarette lighter port. The DC charging voltage range is 12V-24V.

d

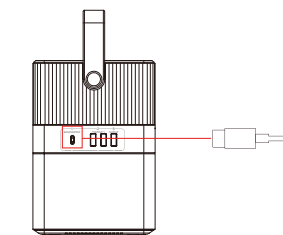

Charging with USB Type-C

Connect to the USB Type-C adapter to the USB Type-C port, connect the other end to a USB power outlet or an AC adapter and plug into a power outlet.

For any support or comments concerning our products, please send an email to: Support@ideausa.com or Toll-Free NO: +1-866-886-6878
 BP300I19UMEN-01