

3 PLACING YOUR CUP, TRAVEL MUG, OR CARAFE

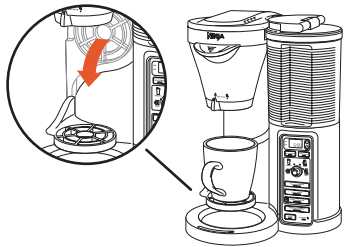

Brew a Single Cup

- Remove the carafe and fold down the cup platform.
- Place a 12-oz. (or larger) cup or mug on the cup platform.

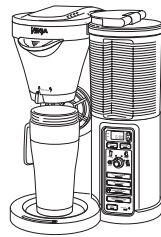

Brew a Travel Mug

- Remove the carafe.
- Place a 16-oz. (or larger) travel mug on the base of the Coffee Bar.

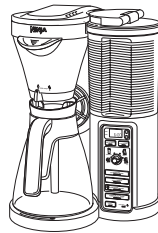

The warming plate will only turn on when you brew a half or full carafe.

Brew a Carafe

- Make sure the cup platform is folded up.
- Set the carafe in place on the base of the Coffee Bar.

MAKING ICED COFFEE?
Fill your cup, travel mug, or carafe with ice before placing under the brew basket.
IMPORTANT NOTICE: Do not use glassware.

4 CHOOSE YOUR SIZE

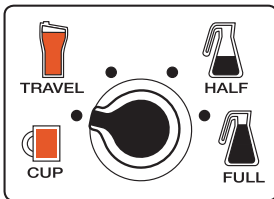

Select your size on the multi-serve dial.

NOT ALL CUPS ARE CREATED EQUAL

Our “cup” is larger than the 5-oz. cup size you may be used to with other coffee makers. So, no need to use a dainty coffee cup—your favorite mug will work great.

How much will the CUP and TRAVEL MUG settings actually make?*

SIZE	CLASSIC	RICH	OVER ICE (filled with ice)	OVER ICE (coffee only)	SPECIALTY
CUP	9.5 oz.	8.8 oz.	9.5 oz.	3.7 oz.	3.1 oz.
TRAVEL MUG	14 oz.	13.2 oz.	14 oz.	5.8 oz.	4 oz.

*approximate brew volumes

5 CHOOSE YOUR BREW

HOW DO I KNOW IT'S WORKING ITS MAGIC?

Each brew has a pre-infusion cycle that unlocks the flavors of your favorite coffee. The brew will begin, pause to pre-infuse, and be quiet for a short period of time before it resumes the brew.

CLASSIC BREW

Smooth, balanced flavor from your favorite coffee.

RICH BREW

Richer, more intense than Classic, but not bitter coffee flavor that stands up to milk, cream, or flavoring.

OVER ICE BREW

Specially designed to brew hot over ice to lock in flavor for freshly brewed iced coffee that is not watered down.
Always fill your vessel with ice before brewing.

SPECIALTY BREW (CONCENTRATED COFFEE)

Super-rich concentrate designed to create all kinds of hot milk-based, iced, and frozen blended coffeehouse-style drinks.

