

INSTRUCTIONS FOR USE

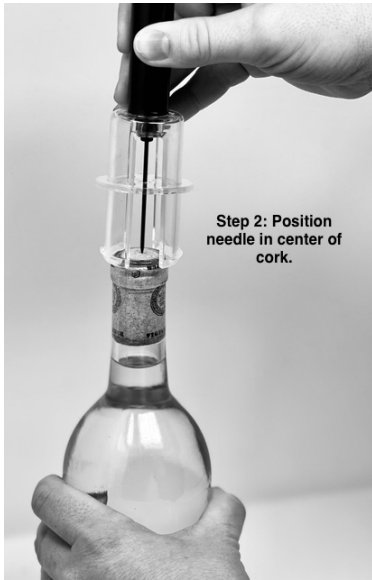

Step 1: Remove foil from cork.



Step 2: Position needle in center of cork.

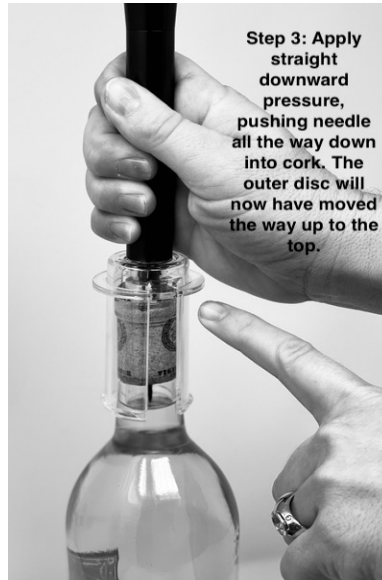

Step 3: Apply straight downward pressure, pushing needle all the way down into cork. The outer disc will now have moved the way up to the top.



Step 4: The needle will be visible underneath the cork.



Step 5: Lift the handle all the way up and begin pumping. Note: you don't need to pump hard and fast, just an easy upward and downward motion.



Step 6: Continue pumping about 3-10 times, depending on the cork.

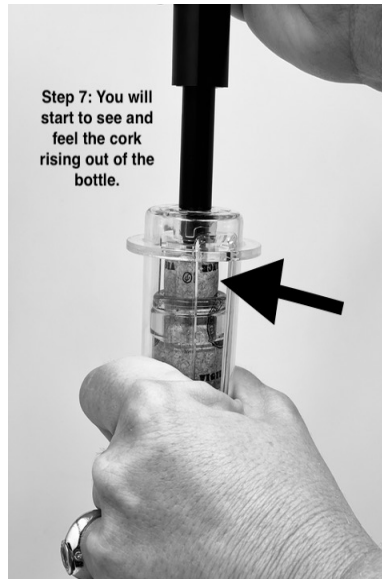

Step 7: You will start to see and feel the cork rising out of the bottle.



Step 8: After the cork "pops" out of the bottle, use the outer disc to push the cork until it ejects from the wine opener.



Step 9: Cork is pushed all the way up the needle.



Step 10: Now you're ready for your next bottle!

Air Pump Wine Opener

CAUTION:

1. Keep out of reach of children! This item is sharp!
2. Use this product to open a new and full bottle of wine only.
3. Always use the outer disc to remove the cork from the needle after opening the wine bottle to ensure your fingers stay protected from the sharp needle.
4. Do not aim at face or other body parts.

ATTENTION:

1. Do not use this wine opener to open sparkling wine or on a plastic cork.
2. Reduce pumping force when cork starts to loosen.
3. Rarely, the cork isn't completely sealed or has gotten soft from saturation in the bottle to begin with. This will make the opener ineffective at opening the bottle.

COMPONENTS

