

GET STARTED

QUICK START GUIDE

For complete instructions and videos, go online to kitchenaid.com/quickstart.

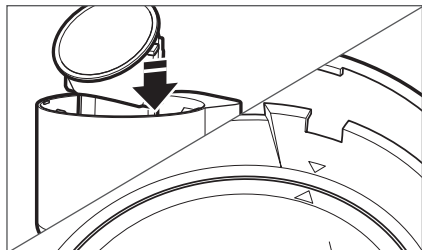

- 1. Install the swivel chute:** Lower the swivel chute into the sifter housing at an angle, aligning the marks on the swivel chute with the marks on the inside of the sifter housing.

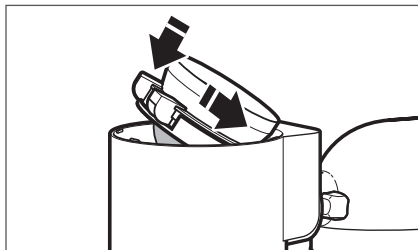

- 2. Install the sifter assembly:** Lower the sifter into the sifter housing at an angle. Once the shaft is inserted into the sifter housing, press down on the back of the sifter to click it into place.

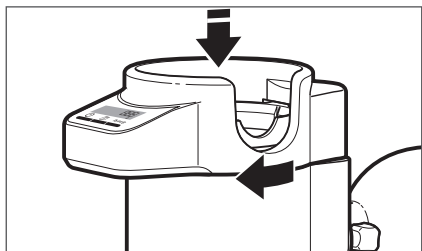

- 3. Install the scale:** Place scale on top of sifter housing as shown, and slightly left of center. Twist the scale counterclockwise until it locks into place.

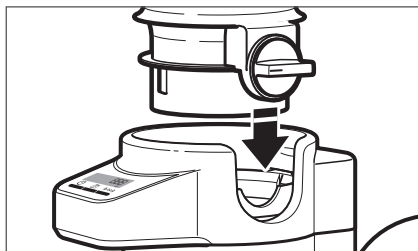

- 4. Install the ingredient hopper:** Align the ingredient valve with the corresponding notch on the scale, and lower the hopper onto the scale until fully seated.

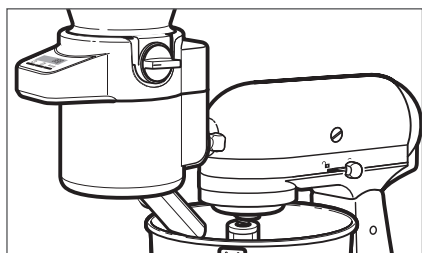

- 5. Before adding ingredients to the hopper,** be sure the ingredient valve is in the closed position and swivel chute is pointed into the mixer bowl or an appropriate container.

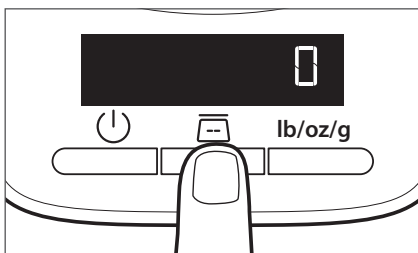

- 6. Press** (On/Off), then press (Tare) until the display reads 0. Add your ingredients to the ingredient hopper until you reach the target weight.

TIPS:

- Use dry ingredients only with the Sifter+Scale attachment.
- Make sure your dry ingredients have no large or hard clumps before feeding them through the sifter.
- The sifter can operate at any speed, so select the speed that works best for your recipe.