







# COFFEE BREWING TIPS

## Is it hot in here? Or is it just the cup you’re using?

Coffeehouses traditionally serve their coffee in paper cups. And it’s not just because they’re inexpensive and easy to discard. The type of cup you brew into can drastically influence the temperature of your coffee. Take a look.

CUP TYPE	CERAMIC CUP			NINJA® CUP	PAPER CUP
CUP TEMP	Room Temp	Pre-warmed with hot water	Pre-warmed in microwave with milk	Room Temp	Room Temp
DRINKING TEMP	Hot 	Hotter 	Hotter 	Hotter 	Hottest 
WHY DOES THIS MATTER?	A cold ceramic mug will steal heat from the coffee	If the mug is already warm, it will not steal as much heat from the coffee	Just like your cold mug, cold milk steals heat from the coffee	The Ninja® double wall mug is designed to retain initial coffee temp better than a ceramic mug	Unlike a ceramic mug, a paper cup does not steal substantial heat from the coffee



## When you just can’t wait for that first cup to be ready, don’t.

Simply close the Drip Stop to pause the brew cycle and pour your cup. Then re-open the Drip Stop to continue the brew. If you forget to re-open the Drip Stop, your Ninja Coffee Bar™ will give you a friendly audible reminder.

## Want the perfect iced coffee?

**Be sure to fill your cup, travel mug, or carafe with ice before brewing.** Allowing the hot coffee to brew directly over the ice ensures you get a smooth, rich, refreshing taste every time.

IMPORTANT NOTICE: Do not use glassware.



Please make sure to read the enclosed Ninja® Owner’s Guide prior to using your unit.



# QUICK START GUIDE

## 1 FILLING THE WATER RESERVOIR

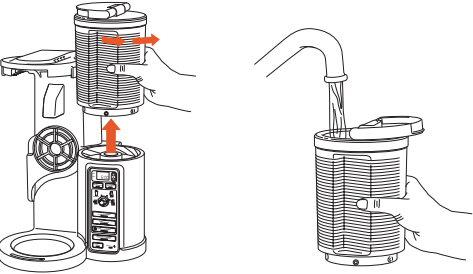



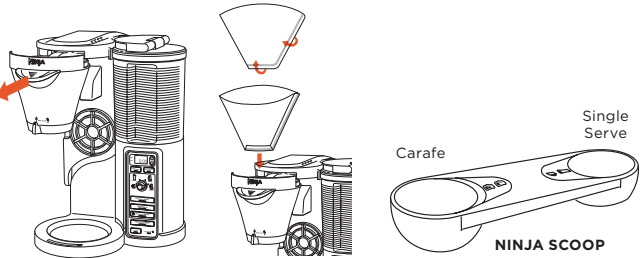

- Twist the Water Reservoir counter-clockwise and remove for easy filling.
- Fill with fresh, filtered water up to the carafe line, marked on the outside of the Water Reservoir. Auto-iQ™ knows just the right amount of water to draw from it for the size and brew you select. Before you brew, always be sure the Water Reservoir is filled above the minimum fill line for your desired size.
- Twist the Water Reservoir clockwise to lock into place.

## 2 FILLING THE BREW BASKET



- Slide the Brew Basket out for easy filling.
- If using a paper filter, first remove the permanent filter, then fold a #4 paper cone filter along the seams and insert firmly into the brew basket.
- Using the provided Ninja scoop, scoop the appropriate amount of ground coffee for your drink size into the filter.

SINGLE SERVE	NINJA SCOOP Single Serve Side	TABLESPOONS
 CUP	2-3 Scoops	2-3 Tbsp.
 TRAVEL MUG	3-4 Scoops	3-4 Tbsp.
CARAFE	NINJA SCOOP Carafe Side	TABLESPOONS
 HALF CARAFE	2-3 Scoops	5-7 Tbsp.
 FULL CARAFE	4-6 Scoops	8-12 Tbsp.