

# POWERFRESH<sup>®</sup> SLIM STEAM MOP

---

USER GUIDE  
2075 SERIES

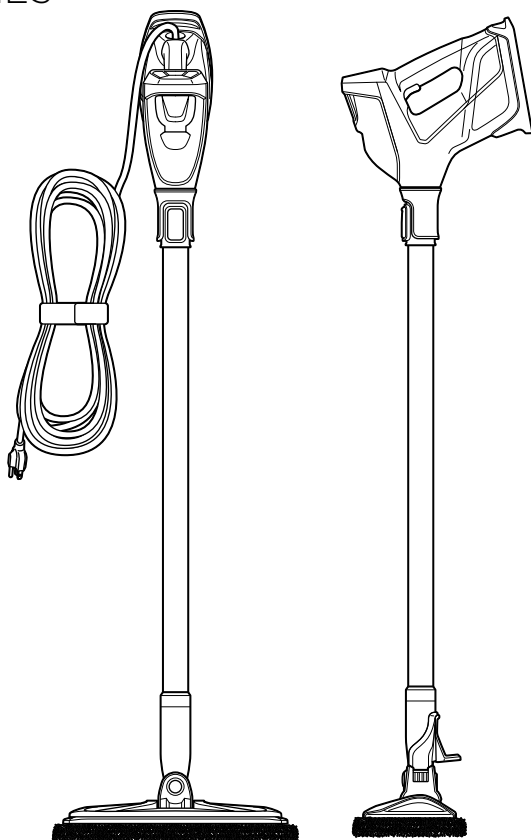

# IMPORTANT SAFETY INSTRUCTIONS

## READ ALL INSTRUCTIONS BEFORE USING YOUR STEAM MOP.

When using an electrical appliance, basic precautions should be observed, including the following:

Always connect to a polarized outlet (left slot is wider than right). Unplug from outlet when not in use and before conducting maintenance.

## **WARNING**

### TO REDUCE THE RISK OF FIRE, ELECTRIC SHOCK, OR INJURY:

- » This appliance can be used by children 8 years old and above, and persons with reduced physical, sensory and mental capabilities or lack of experience and knowledge if they have been given supervision or instruction concerning use of the appliance in a safe way and understand the hazards involved. Cleaning and user maintenance shall not be made by children without supervision.
- » Children should be supervised to ensure that they do not play with the appliance.
- » If the cord is damaged, it must be replaced by the manufacturer, its service agent or similarly qualified persons in order to avoid a hazard.
- » Use extra care when cleaning on stairs.
- » Do not use with damaged cord or plug.
- » Do not use outdoors.
- » Always turn off this appliance before connecting or disconnecting the nozzle. Do not direct steam at people, animals, or at electrical outlets.
- » Unplug from outlet when not in use and before conducting maintenance or troubleshooting.
- » Do not leave steam cleaner unattended.
- » Do not expose hair, loose clothing, fingers or body parts to openings or moving parts.
- » Do not service steam cleaner when it is plugged in.
- » Do not handle steam cleaner with wet hands.
- » Do not use steam cleaner if it has been dropped, damaged, left outdoors or dropped into water, return it to a service center.
- » Do not pull or carry by cord, use cord as a handle, close door on cord, pull cord around sharp corners or edges, or expose cord to heated surfaces.
- » Do not unplug by pulling on cord.
- » Do not use appliance in an enclosed space filled with

vapor given off by oil-base paint, paint thinner, some moth proofing substances, flammable dust, or other explosive or toxic vapors.

- » Do not allow to be used as a toy.
- » Do not use on leather, wax polished furniture or floors, synthetic fabrics, velvet or other delicate, steam-sensitive materials.
- » Do not immerse in water or liquid.
- » Not for space heating purposes.
- » Do not use for any purpose other than described in this User's Guide.
- » Use only manufacturer's recommended attachments - use of attachments not provided or sold by BISSELL may cause fire, electric shock or injury.
- » Never put descaling, aromatic, alcoholic, detergent or vinegar products into the steam cleaner, as this may damage it or make it unsafe for use.
- » Unplug by grasping the plug, not the cord.
- » Close attention is necessary when used by or near children.
- » Keep the appliance out of reach of children when it is energized or cooling down.
- » The foot surfaces are liable to get hot during use.
- » Do not open the aperture during use.

## **WARNING**

**SURFACE MAY BE HOT. AVOID CONTACT.**



**THESE SYMBOLS MEAN WARNING:**  
**Any use of steam has the potential danger of scalding.**

## SAVE THESE INSTRUCTIONS FOR FUTURE USE

This model is for household use only. Commercial use of this unit voids the manufacturer's warranty.

# Thanks for buying a BISSELL PowerFresh® Slim Steam Mop

Your steam mop needs a little assembly before you can put it to work, so flip to page 5 and let's get started!

Safety Instructions . . . . .	2	Troubleshooting . . . . .	14
Product View . . . . .	4	Warranty . . . . .	15
Assembly . . . . .	5	Service . . . . .	15
Operations . . . . .	6-10	Product Registration . . . . .	16
Maintenance & Care . . . . .	11-13	Consumer Care . . . . .	16

## What's In The Box?

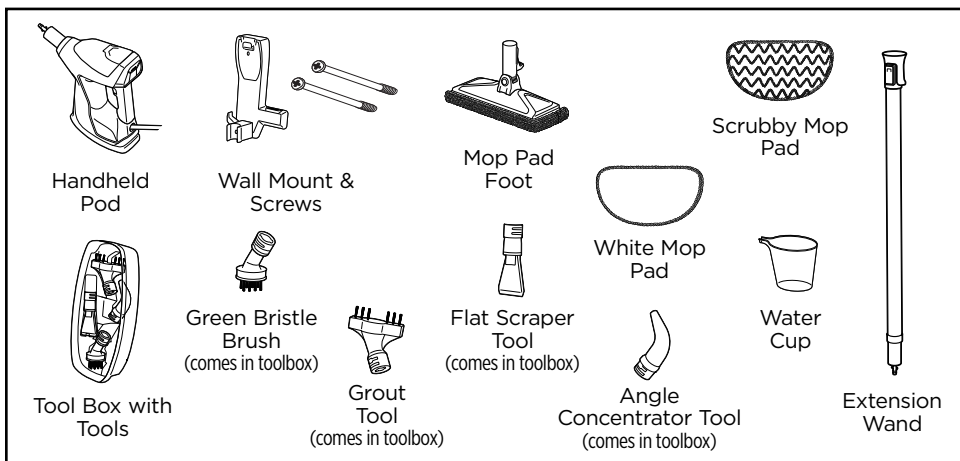

### VARIES BY MODEL

Standard accessories may vary by model. To identify what should be included with your purchase, please refer to the "Carton Contents" list located on the carton top flap.

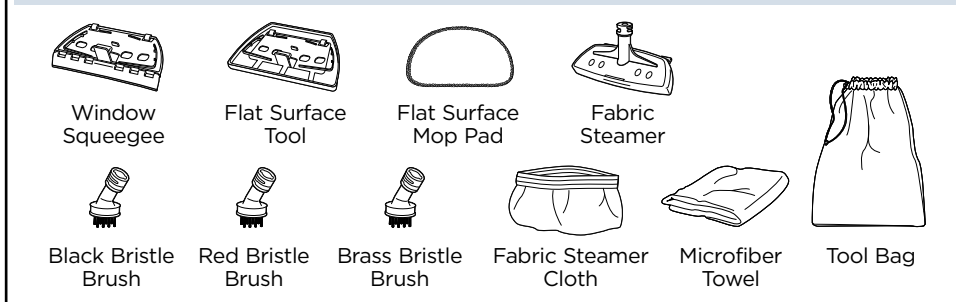

# Getting to Know Your Steam Mop

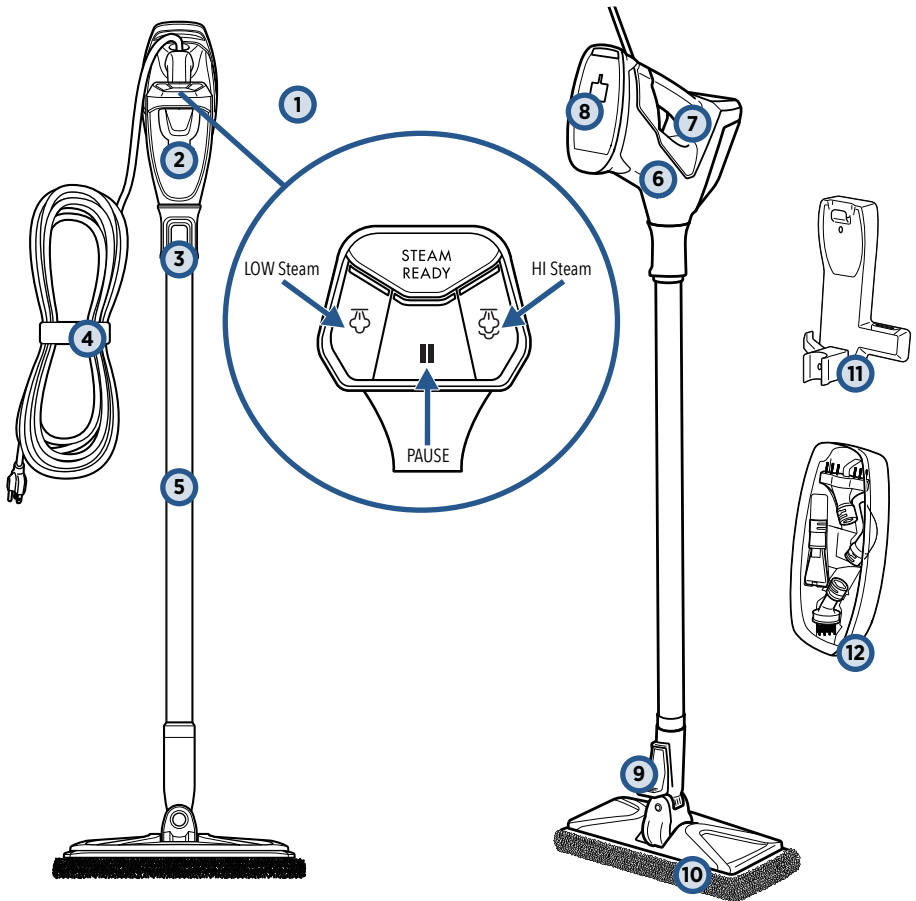

- |   |                             |    |                              |
|---|-----------------------------|----|------------------------------|
| 1 | SmartSet Steam Control      | 7  | Steam Trigger                |
| 2 | Easy Fill Water Tank        | 8  | Wall Mount Storage Clip Area |
| 3 | Handheld Pod Release Button | 9  | Extension Wand Release Pedal |
| 4 | Power Cord with Wrap Strap  | 10 | Mop Pad Foot                 |
| 5 | Extension Wand              | 11 | Wall Mount                   |
| 6 | Handheld Pod                | 12 | Tool Box                     |

**NOTE:** Tool Box stores Green Bristle Brush, Angle Concentrator Tool, Grout Tool, and Flat Scraper Tool.

# Assembly

## WARNING

Do not plug in your PowerFresh® Slim Steam Mop until you are familiar with all instructions and operating procedures.

Your BISSELL PowerFresh® Slim Steam Mop assembles quickly and easily. It is packaged with the following items:

- Handheld Pod
- Extension Wand
- Mop Pad Foot

1

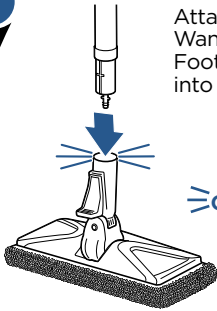

Attach the Extension Wand to the Mop Pad Foot by snapping it into place.

2

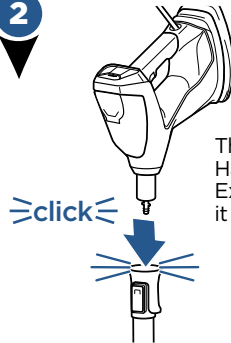

Then, insert the Handheld Pod to the Extension Wand until it clicks into place.

3

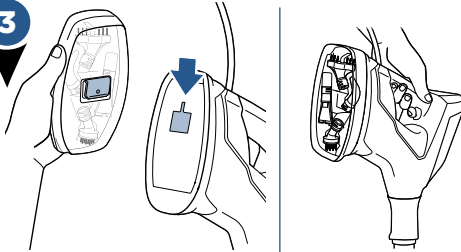

Attach the tool box to the Handheld Pod by aligning the clip on the back side of the Tool Box to the opening on the bottom of the Handheld Pod and slide down into place.

4

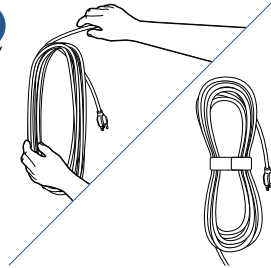

Wrap the cord around the palm of your hand into a circle. Then, place the wrap strap around the cord and back onto itself to secure.

**NOTE:** For instructions on attaching the Wall Mount and Storage, please refer to page 12.

# Filling Your Water Tank

1

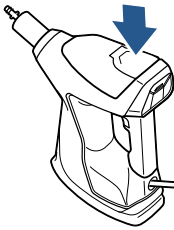

The clean water tank is located on the top of the Handheld Pod.

2

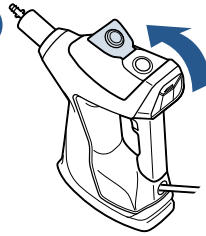

Pull the water tank cap straight up to open.

3

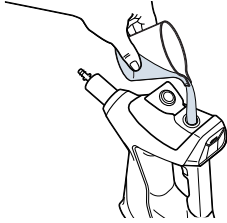

Use water cup provided and fill with distilled or demineralized water, recommended in place of tap water. Close the water tank cap after filling.

## A few notes about filling the Water Tank:

- The Water Tank's capacity is 350 mL (12 oz).

**DO NOT USE CHEMICALS IN THE WATER TANK OF YOUR POWERFRESH® SLIM STEAM MOP.**

- Other solutions may harm the machine and void the warranty.

**NOTE:** Use of distilled water or demineralized water is recommended to prolong the life of your steam mop. To add a fresh scent as you clean, try BISSELL demineralized waters in various scents like Citrus, Eucalyptus Mint and Spring Breeze.

# Attaching Microfiber Mop Pads

1

Your PowerFresh® Slim Steam Mop may have come with two different pads.



White Mop Pad



Scrubby Mop Pad

The **White Mop Pad** is best for everyday use on delicate flooring like sealed hardwoods and laminate. The **Scrubby Mop Pad** is recommended for durable surfaces like tile.

2

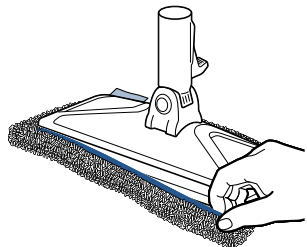

To attach mop pad, wrap mop pad around the bottom of the foot, making sure the gray stitching is located on the front of the foot and the Quick Grip Release™ Tab is located on the back.

# Using SmartSet™ Steam Control

1

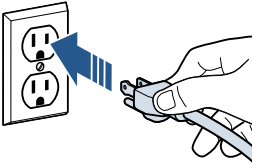

Plug machine into a properly grounded outlet.

2

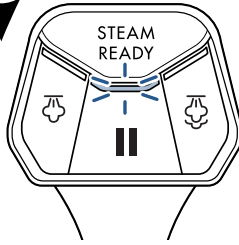

When the unit is plugged in, the STEAM READY light will start to blink.

3



After 30 seconds, the STEAM READY light will turn to a solid light. This means the steam mop is heated and ready to use.

4

Now, select a desired steam level based on your cleaning needs.



Push the HI STEAM button once to turn ON. Use HI STEAM when cleaning durable floors or sticky messes.

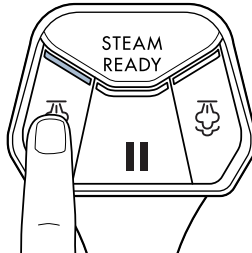

Push the LOW STEAM button once to turn ON. Use LOW STEAM for delicate floors or for light, everyday cleaning.

5

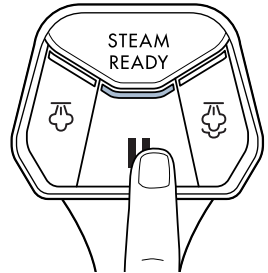

To turn steam OFF, press the PAUSE button once.

**NOTE:** You must wait until the STEAM READY light is a solid color before selecting your desired steam level. Upon the first use of your steam mop or first use after refilling the water tank, the pump may make a “knocking” sound. This is normal and will diminish after a few seconds.

# Cleaning Your Hard Floors

**NOTE:** Before you clean, thoroughly sweep or vacuum floor prior to cleaning with the PowerFresh® Slim Steam Mop.

**YOUR STEAM MOP IS DESIGNED TO CLEAN HARD FLOORING SUCH AS CERAMIC TILE, LAMINATE, MARBLE, STONE AND SEALED HARDWOOD FLOORS. USE OF YOUR STEAM MOP ON WAXED OR SOME UNWAXED FLOORS MAY RESULT IN A DIMINISHED GLOSSINESS. THE STEAM MOP IS NOT FOR USE ON UNSEALED FLOORS. FOR BEST RESULTS, TEST IN AN INCONSPICUOUS AREA AND CHECK THE CARE INSTRUCTIONS FROM YOUR FLOORING MANUFACTURER.**

1

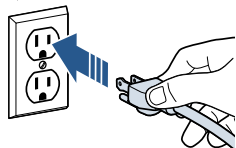

Plug machine into a properly grounded outlet.

2



Make sure the STEAM READY light is solid before selecting the appropriate steam level based on your hard floor cleaning needs.

3

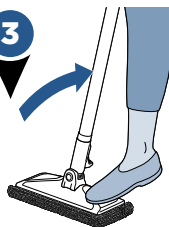

Step on the side of the foot to recline the body of the machine to begin cleaning.

**NOTE:** Your Steam Mop may have already come assembled with a mop pad on the foot. If not, refer to instructions on page 6 in the "Attaching Microfiber Mop Pads" section to learn how to attach the mop pad.

4

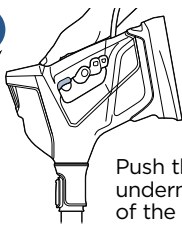

Push the trigger underneath the handle of the Handheld Pod to release steam.

5



To easily maneuver and clean tight spaces such as baseboards, behind the toilet, and around furniture, take advantage of the swivel steering.

6



For best results to sanitize an area of your floor, use the microfiber cloth pads and slowly and evenly stroke your steam mop back and forth at least three times over the area using continuous steam. Remove the pad after use and wash.

7

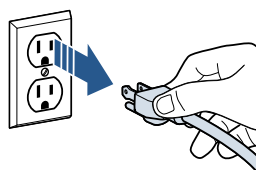

When finished cleaning, turn off the machine by pressing the PAUSE button and unplugging the unit.



# Above Floor Cleaning

Your BISSELL PowerFresh® Slim Steam Mop has the ability to clean above floors or in tight spaces when using the Extension Wand. It also has the convenience of converting into a handheld steamer when removing the Extension Wand.

1



Before changing from mopping to the handheld feature or disconnecting a tool from the handheld pod or extension wand, make sure steam is no longer coming from the nozzle by releasing the trigger and pressing the PAUSE button.

2

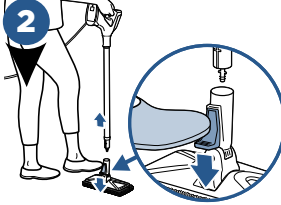

To clean above floors using the **Extension Wand**, step down on the pedal located on the back of the steam mop and lift up to release the Extension Wand.

3

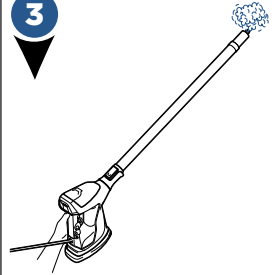

Be sure the desired steam setting is selected, then push the trigger located under the handle of the Handheld Pod to release steam.

**NOTE:** Do not step on the back pedal to recline the unit. When removing the Extension Wand from the foot, make sure to lift away from your body as the bottom of the wand may release steam.

4

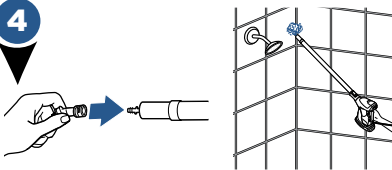

Attach desired tool to end of Extension Wand to clean above floors and hard to reach areas such as ceilings, showers, baseboards, and sliding door tracks.

5



To convert the steam mop into a **handheld steamer**, push the release button located on the top of the Extension Wand and lift up to detach the Handheld Pod from the Extension Wand.

6



## Cleaning Without Tools:

Push the trigger located under the handle of the Handheld Pod to release steam from the end of the Handheld Pod.

7

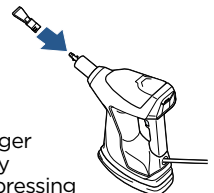

## Cleaning With Tools:

Make sure steam is no longer coming from the nozzle by releasing the trigger and pressing the pause button. Then connect the desired tool.

Continue steps on next page

# Above Floor Cleaning (continued)

**8** Based on your cleaning needs, connect desired tool to the end of the Extension Wand or the Handheld Pod. Select cleaning tools are included with this model.

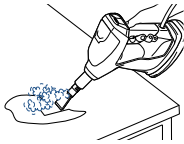

Use the **Flat Scraping Tool** to steam and scrape off those sticky messes on floors, countertops, etc.

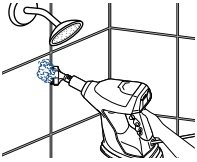

Use the **Grout Tool** to remove dirt and grime from grout.

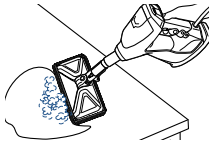

Use the **Mop Pad Foot** to steam larger areas such as shower walls, countertops, stairs, etc.

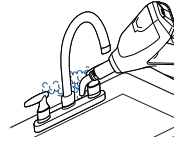

Use the **Angle Concentrator Tool** to steam clean hard-to-reach corners and crevices where dirt and grime build-up in the home, like sinks and faucets.

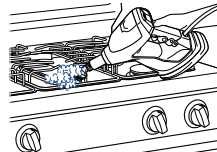

Use the **Green Bristle Brush** to clean around stove tops, sinks, showers, etc.

**NOTE:** Additional tools are available for purchase on [BISSELL.com](http://BISSELL.com).

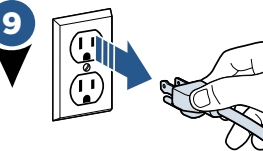

When finished cleaning, turn OFF the machine by pressing the PAUSE button and unplug the unit.

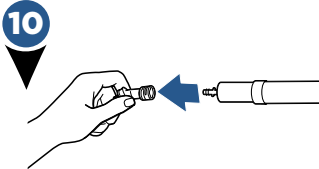

Wait for the steam to stop, then remove tools from the Extension Wand and/or Handheld Pod before reassembling your machine.

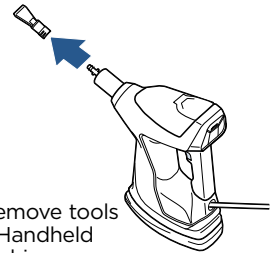

**CAUTION:** Let steam cool down before removing tools. The end of the extension wand or handheld pod will be hot.

**11** Insert foot back into the end of the Extension Wand until it clicks into place.

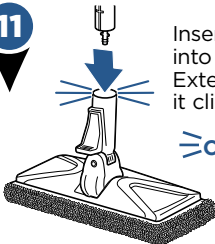

≡click≡

**12** Then, insert the Handheld Pod back into the Extension Wand until it clicks into place.

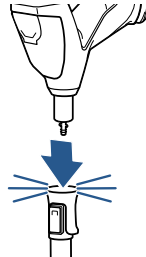

≡click≡

# Cleaning Your Steam Mop

## WARNING

To reduce the risk of fire, electric shock or injury, turn power OFF and disconnect plug from electrical outlet before performing maintenance or troubleshooting.

1

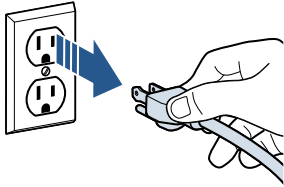

Turn machine OFF and unplug from the grounded outlet.

2

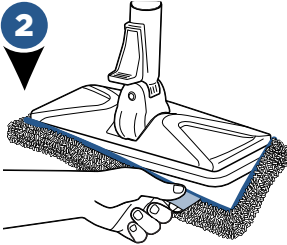

Carefully remove mop pad using the Quick Grip Release Tab from the mop head.

**NOTE:** Mop pad and lower assembly may be hot.

3

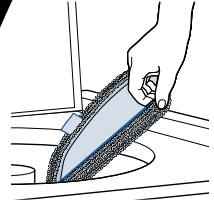

Mop pads can be machine washed in warm water. Use only non-bleach liquid detergents. Do not use fabric softeners or bleach. For best results, air dry.

4

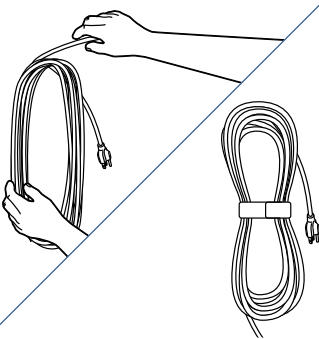

Wrap the cord around the palm of your hand into a circle. Then, place the wrap strap around the cord and back onto itself to secure.

5

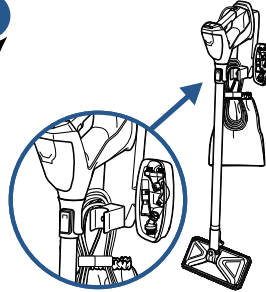

Store on the Wall Mount that is securely mounted to a wall in a protected, dry area. Store with dry pads as wet mop pads may damage wood and other delicate hard floors.

**NOTE:** Unit does not stand up on its own. If you are not using the Wall Mount, make sure your steam mop is stored in a safe place, in the upright position against a firm surface to prevent from falling over.

# Setting Up The Wall Mount

## WARNING

To reduce the risk of fire, electric shock or injury, turn power OFF and disconnect plug from electrical outlet before performing maintenance or troubleshooting.

A Phillips Head Screwdriver is needed to install the wall mount. If installing onto drywall, use plastic anchors with provided screws.

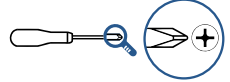

1

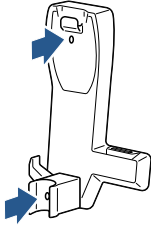

Place the wall mount against the wall in the area where you've determined you would like to store your machine.

2

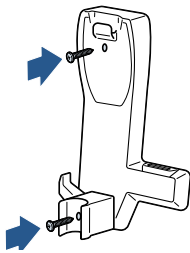

Place each screw through the two holes in the wall mount. Use a screwdriver or drill to affix to the wall.

3

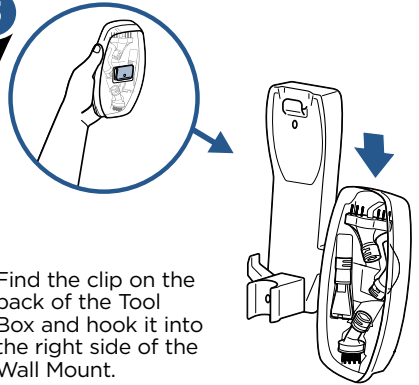

Find the clip on the back of the Tool Box and hook it into the right side of the Wall Mount.

# Using The Wall Mount Storage

## WARNING

To reduce the risk of fire, electric shock or injury, turn power OFF and disconnect plug from electrical outlet before performing maintenance or troubleshooting.

Your BISSELL PowerFresh® Slim Steam Mop can be stored in 2 different ways using the Wall Mount.

### OPTION 1:

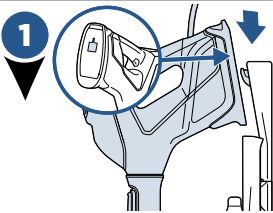

Find the opening on the back of the Handheld Pod and hook it onto the top lip of the Wall Mount.

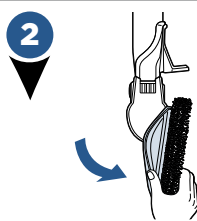

Bend the Mop Pad Foot downward in a slanted position.

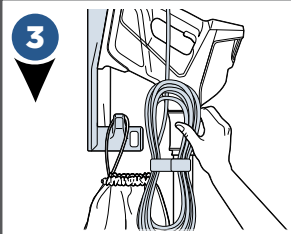

Hang the power cord and tool bag on the left-side hook.

### OPTION 2:

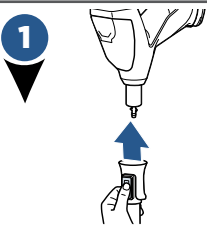

Detach the Extension Wand from Handheld Pod.

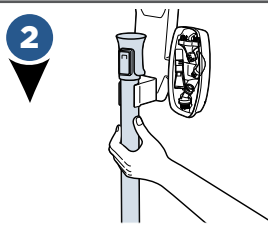

Clip the extension wand into the holder.

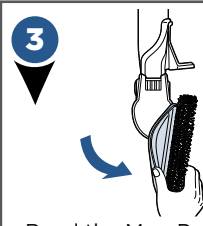

Bend the Mop Pad Foot downward in a slanted position.

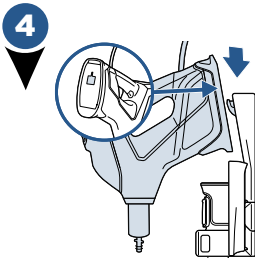

Find the opening on the back of the Handheld Pod and hook it onto the top lip of the Wall Mount.

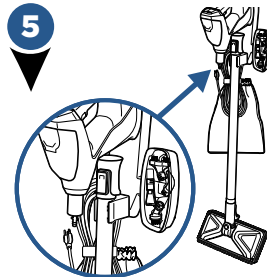

Hang the power cord and tool bag on the left-side hook.

# Troubleshooting

## WARNING

To reduce the risk of electric shock, turn power switch off and disconnect plug from electrical outlet before performing maintenance or troubleshooting checks.

<b>Problem</b>	<b>Possible causes</b>	<b>Remedies</b>
<b>Reduced steam OR no steam</b>	Water tank empty.	Refill tank.
	Steam level not selected.	Select steam level by pushing steam level button.
	Wand not installed properly.	Push the wand all the way into the handheld pod until you hear a click.
	Foot not installed properly.	Insert the Extension Wand into foot until you hear a click.
	PAUSE button is pressed.	Once STEAM READY light is solid, select desired steam level (HI or LO) then push the trigger under the handle of the Handheld Pod to release steam.
<b>Streaking</b>	Dirty mop pad.	Remove and wash pad per instructions before further use.
	Use on waxed or oiled floor.	If you have used floor polishes or wax on your floors, steam products may decrease glossiness. Refer to the wax or polish manufacturer. If you don't wax or polish your floors, check the floor care instructions from your flooring manufacturer.
<b>Leaking</b>	Mop pad is too wet.	Remove and replace with dry mop pad and intermittently press the steam trigger for less steam.
	Steam level is too high.	Lower the steam level.
	Crack in unit or water tank.	Check to see if there are any cracks on the unit or tank and check to make sure the rubber gasket on the tank is still attached and seated properly in the unit.
<b>Knocking Noise</b>	First use or water tank is empty.	Fill water tank and knocking will diminish after a few seconds.
	Metal tube cannot reach water.	Shake the pod to let the tube reach the water level.

# Warranty

This warranty gives you specific legal rights, and you may also have other rights which may vary from state to state. If you need additional instruction regarding this warranty or have questions regarding what it may cover, please contact BISSELL Consumer Care by E-mail, telephone, or regular mail as described below.

## Limited Two-Year Warranty

Subject to the \*EXCEPTIONS AND EXCLUSIONS identified below, upon receipt of the product BISSELL will repair or replace (with new or remanufactured components or products), at BISSELL's option, free of charge from the date of purchase by the original purchaser, for two years any defective or malfunctioning part.

See information below on "If your BISSELL product should require service".

This warranty applies to product used for personal, and not commercial or rental service. This warranty does not apply to fans or routine maintenance components such as filters, belts, or brushes. Damage or malfunction caused by negligence, abuse, neglect, unauthorized repair, or any other use not in accordance with the User's Guide is not covered.

BISSELL IS NOT LIABLE FOR INCIDENTAL OR CONSEQUENTIAL DAMAGES OF ANY NATURE ASSOCIATED WITH THE USE OF THIS PRODUCT. BISSELL'S LIABILITY WILL NOT EXCEED THE PURCHASE PRICE OF THE PRODUCT.

**Some states do not allow the exclusion or limitation of incidental or consequential damages, so the above limitation or exclusion may not apply to you.**

## \*EXCEPTIONS AND EXCLUSIONS FROM THE TERMS OF THE LIMITED WARRANTY

THIS WARRANTY IS EXCLUSIVE AND IN LIEU OF ANY OTHER WARRANTIES EITHER ORAL OR WRITTEN. ANY IMPLIED WARRANTIES WHICH MAY ARISE BY OPERATION OF LAW, INCLUDING THE IMPLIED WARRANTIES OF MERCHANTABILITY AND FITNESS FOR A PARTICULAR PURPOSE, ARE LIMITED TO THE TWO YEAR DURATION FROM THE DATE OF PURCHASE AS DESCRIBED ABOVE.

Some states do not allow limitations on how long an implied warranty lasts so the above limitation may not apply to you.

**NOTE:** Please keep your original sales receipt. It provides proof of date of purchase in the event of a warranty claim.

# Service

## If your BISSELL product should require service:

Contact BISSELL Consumer Care to locate a BISSELL Authorized Service Center in your area.

If you need information about repairs or replacement parts, or if you have questions about your warranty, contact BISSELL Consumer Care.

### Website:

[www.BISSELL.com/service-centers](http://www.BISSELL.com/service-centers)

### E-mail:

[www.BISSELL.com/email-us](mailto:www.BISSELL.com/email-us)

### Call:

BISSELL Consumer Care  
1-800-237-7691  
Monday - Friday 8am - 10pm ET  
Saturday 9am - 8pm ET  
Sunday 10am - 7pm ET

## Please do not return this product to the store.

Other maintenance or service not included in the manual should be performed by an authorized service representative.

For any questions or concerns, BISSELL is happy to be of service. Contact us directly at 1-800-237-7691.

# Register your product today!

Registering is quick, easy and offers you benefits over the lifetime of your product.

## You'll receive:

### **BISSELL Rewards Points**

Automatically earn points for discounts and free shipping on future purchases.

### **Faster Service**

Supplying your information now saves you time should you need to contact us with questions regarding your product.

### **Product Support Reminders and Alerts**

We'll contact you with any important product maintenance reminders and alerts.

### **Special Promotions**

Optional: Register your email to receive notice of offers, contests, cleaning tips and more!

Visit [www.BISSELL.com/registration!](http://www.BISSELL.com/registration!)

## Visit us online at: **BISSELL.com**

When contacting BISSELL, have model number of cleaner available.

Please record your

Model Number: \_\_\_\_\_

Please record your

Purchase Date: \_\_\_\_\_

**NOTE: Please keep your original sales receipt. It provides proof of purchase date in the event of a warranty claim. See Warranty page for additional details.**

## Parts & Supplies

For Parts and Supplies, go to **BISSELL.com** and enter your model number in the search field.

*We can't wait to hear from you!*

We really do read your comments, tweets, and posts.

**Rate this product on BISSELL.com**

or any of our retailer sites and let us (and millions of your closest friends) know what you think!

For cleaning tips and more visit [www.BISSELL.com](http://www.BISSELL.com) or find us at:



BISSELL



BISSELLClean



BISSELLClean



BISSELL



BISSELL



©2017 BISSELL Homecare, Inc  
Grand Rapids, Michigan  
All rights reserved. Printed in China  
Part Number 161-2078 06/17  
Visit our website at: [www.BISSELL.com](http://www.BISSELL.com)