

WHAT'S INSIDE:

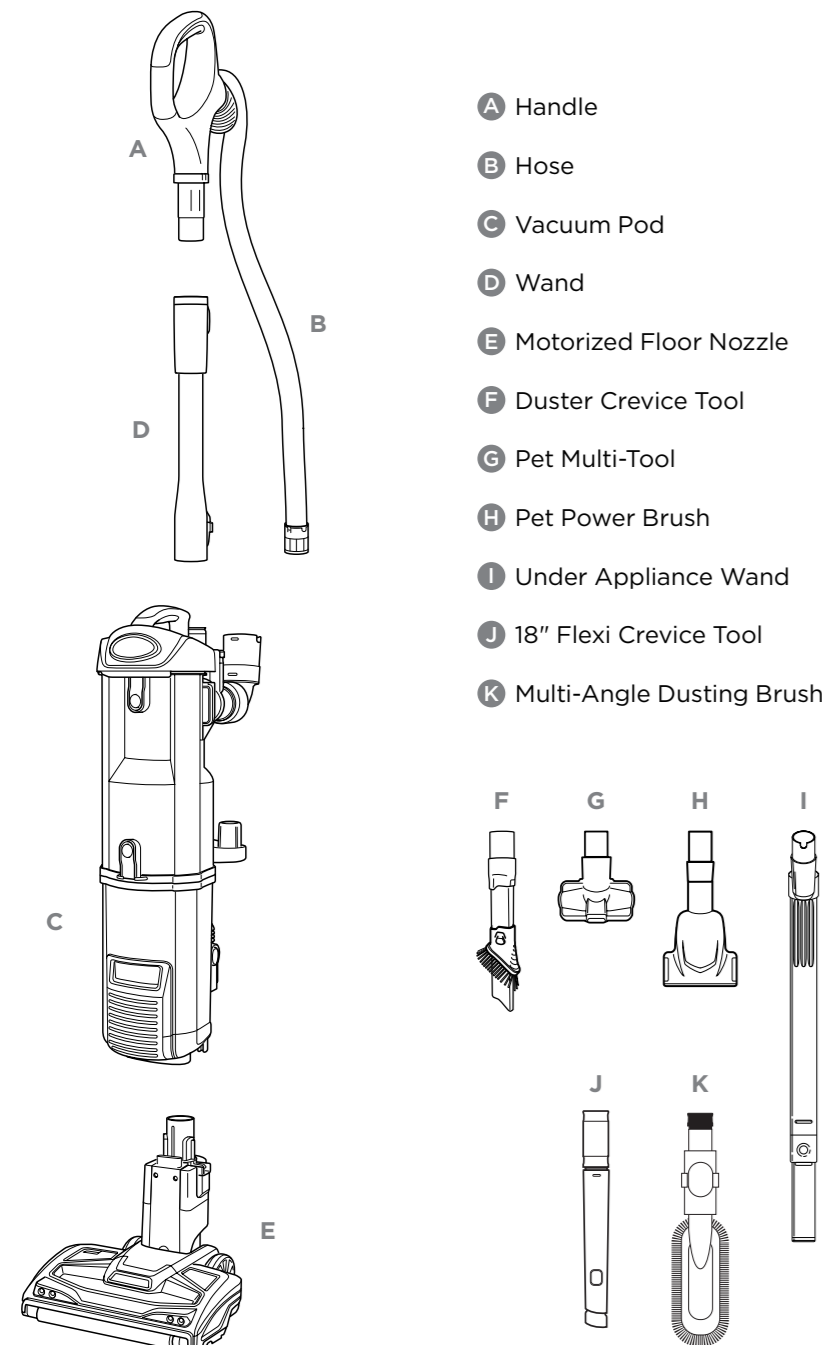

For additional parts and accessories, visit sharkaccessories.com

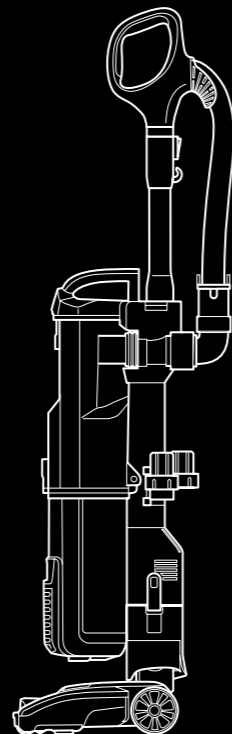

Shark

For questions or to register your product, contact us at
1-800-798-7398 or visit us online at sharkclean.com



@sharkcleaning

©2017 SharkNinja Operating LLC. SHARK is a registered trademark of SharkNinja Operating LLC. DUOCLEAN and JOIN THE CLEAN EVOLUTION are trademarks of SharkNinja Operating LLC.

NV200Q_QSG_PLT_170324

Please be sure to read the enclosed Shark® Owner's Guide prior to using your unit.

Shark

SLIM

THE ONLY
duo clean[™]
DUAL BRUSHROLL

QUICK START GUIDE

Use this Quick Start Guide to learn about your new vacuum's great features.

NV200Q



ASSEMBLY

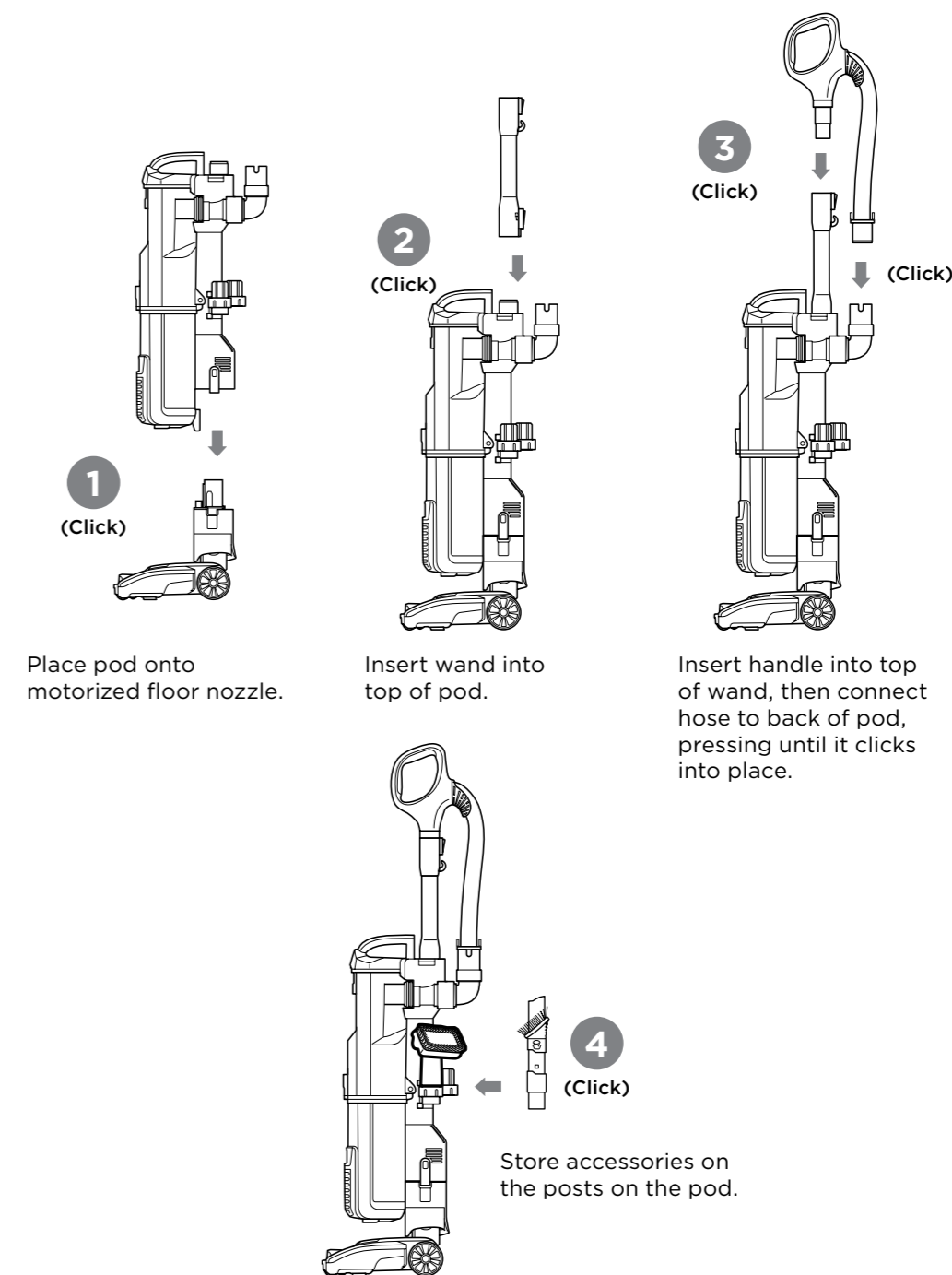

Join The Clean Evolution.™

When it comes to cleaning, we're not afraid to get our hands dirty. At Shark®, we're constantly working to evolve and innovate products to meet the needs of people like you. Because our job is to make 5-star-worthy products that make your life a whole lot easier.

HAVING TROUBLE?

ISSUE

Vacuum is not picking up debris. No suction or light suction.

Solution

Empty dust cup, clean filters, check all openings for blockages.

ISSUE

Vacuum lifts area rugs.

Solution

Turn off the unit to disengage the brushroll, then restart by pushing the Power button.

ISSUE

Brushroll and/or Soft Roller does not spin. The Brushroll Indicator Light on the floor nozzle turns red.

Solution

Turn off and unplug the vacuum immediately. Remove any blockages, then reconnect and turn vacuum back on. If Brushroll Indicator Light on the floor nozzle is green, the blockage has been successfully cleared. If the light is still red, please contact customer service at 1-800-798-7398.

2 WAYS TO CLEAN:

1

UPRIGHT

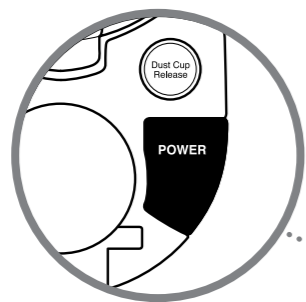

Power

Push the POWER button to turn the vacuum on or off.



Brushroll Operation

In Carpet mode brushroll spins fast (green light)

In Hard Floor mode, brushroll spins slowly (no light)

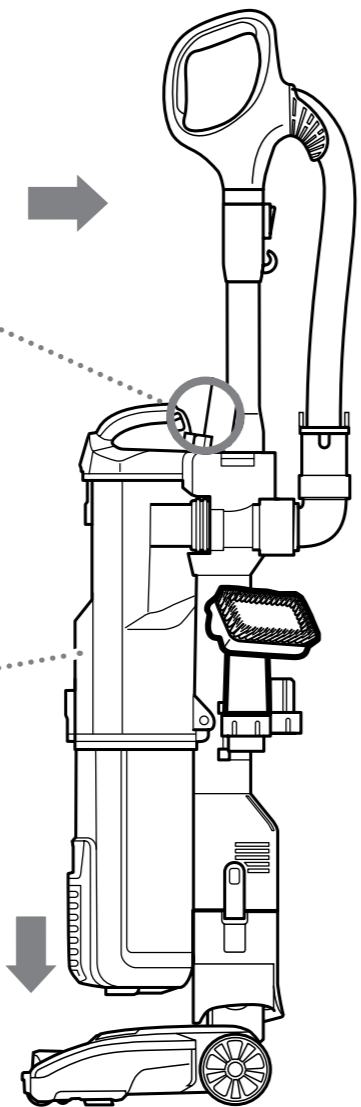

2

ABOVE THE FLOOR

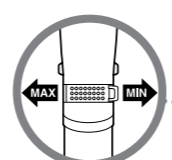

Suction Control



Handle Release

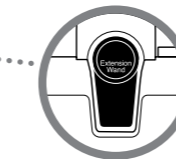

Wand Release

Attach any of the specialized cleaning accessories to the handle or wand.

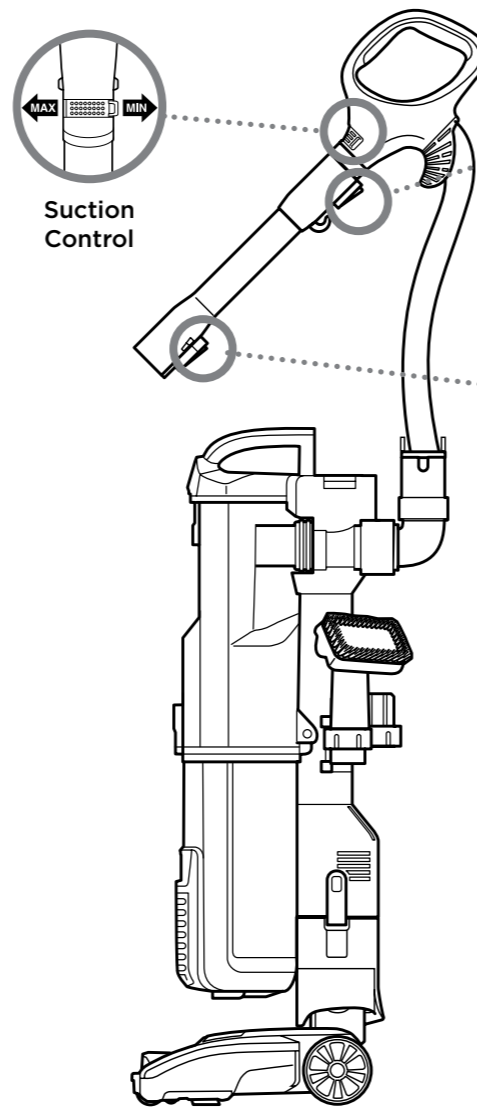
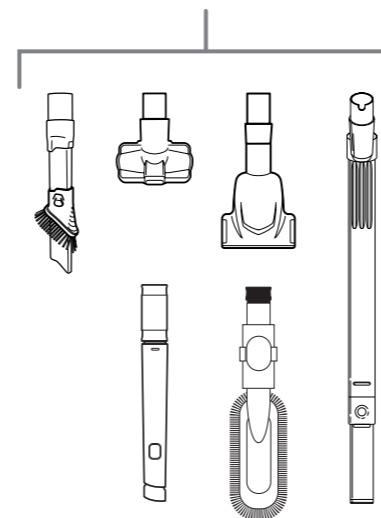

DUOCLEAN™ TECHNOLOGY

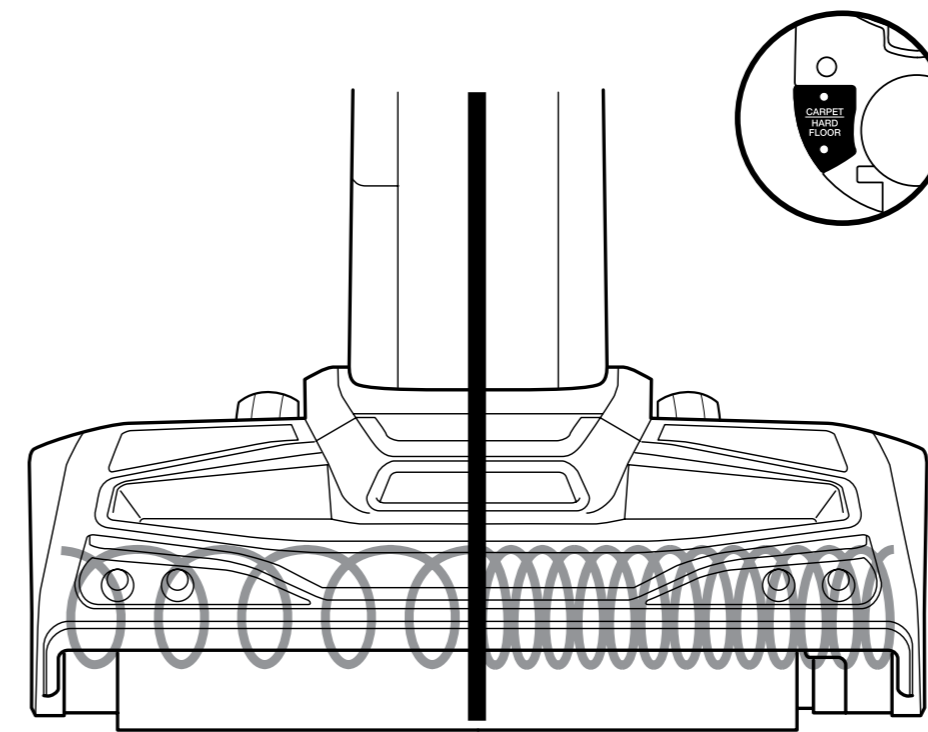

ON FLOORS

Direct engagement with the Soft Roller removes large particles, small particles, and stuck-on dust.

Hard Floor

Gentle on bare floors and delicate area rugs.

ON CARPETS*

The Soft Roller pulls in large particles, while the deep-cleaning bristle brush removes embedded fine dirt.

Carpet

Optimized brushroll speed for carpets.

* For deep cleaning per ASTM F 608 (embedded dirt in carpet) please use in Carpet mode with suction control closed.

MAINTENANCE

Empty dust cup after each use

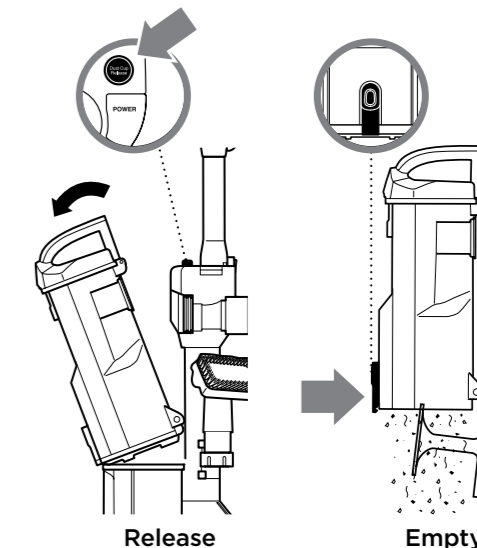

TIP:

Wash filters once every month to keep the suction strong.

Rinse filters and allow to air-dry completely. Tap loose dirt from foam filters as needed between washes.

Maintaining the Soft Roller

Lift out the brushroll to easily remove any string, hair, or debris that may be wrapped around it. Slide the Soft Roller access button up to remove the Soft Roller for cleaning.

