

# ***Shark***<sup>®</sup> ***Rocket***<sup>®</sup>

**AH454Q**

**Model**

---

## **INSTRUCTIONS**



sharkclean.com



1-800-798-7398

# THANK YOU

for purchasing the Shark® Rocket® Powerhead

## REGISTER YOUR PURCHASE

 sharkclean.com

 1-800-798-7398

## RECORD THIS INFORMATION

Model Number: \_\_\_\_\_

Date Code: \_\_\_\_\_

Date of Purchase (Keep receipt): \_\_\_\_\_

Store of Purchase: \_\_\_\_\_

## TECHNICAL SPECIFICATIONS

Voltage: 120V., 60Hz

Watts: 600 W

Amps: 5 A

## PLEASE READ CAREFULLY AND KEEP FOR FUTURE REFERENCE.

These instructions are designed to help you get a complete understanding of your new Shark Rocket Powerhead.

If you should have a question, please call the customer service line at 1-800-798-7398.

# CONTENTS

<b>Important Safety Instructions</b> .....	<b>3</b>
<b>Getting To Know Your Shark® Rocket® Powerhead</b> .....	<b>5</b>
<b>Assembling Your Vacuum</b> .....	<b>7</b>
<b>Speed Settings</b> .....	<b>9</b>
Suction Control .....	9
<b>Choosing the Appropriate Brushroll &amp; Setting</b> .....	<b>10</b>
All-Surface Brushroll.....	10
Gentle Touch Hard Floor Brushroll .....	10
<b>Using Your Vacuum</b> .....	<b>11</b>
What Does the Brushroll Indicator Light Mean? .....	10
<b>Storage</b> .....	<b>12</b>
<b>Maintenance</b> .....	<b>13</b>
Emptying the Dust Cup.....	13
Cleaning the Filters.....	15
Accessing & Cleaning the Brushroll .....	17
<b>Troubleshooting Guide</b> .....	<b>19</b>
<b>Notes</b> .....	<b>20</b>
<b>Warranty</b> .....	<b>22</b>

# IMPORTANT SAFETY INSTRUCTIONS

FOR HOUSEHOLD USE ONLY

## ⚠ WARNING

To reduce the risk of injury, fire, electric shock, and property damage resulting from improper use of the appliance, carefully observe the following instructions. This unit contains electrical connections and moving parts that potentially present risk to the user.

### THE FLOOR NOZZLE, WAND, AND HANDLE CONTAIN ELECTRICAL CONNECTIONS:

- These are not serviceable parts.
- Do not use to vacuum any liquids.
- Do not immerse in water.
- If handle/wand is damaged, discontinue use.

- 1 Inspect power cord or plug for any damage before use. DO NOT use vacuum cleaner with a damaged cord or plug. Turn off all controls before plugging or unplugging the vacuum cleaner. Store your vacuum cleaner with the power cord secured around the two cord hooks.
- 2 DO NOT use outdoors or on wet surfaces. Use only on dry surfaces.
- 3 Unplug from electrical outlet when not in use and before servicing.
- 4 If vacuum cleaner is not working as it should, has been dropped, damaged, left outdoors, or dropped into water, return it to SharkNinja Operating LLC for examination, repair, or adjustment.
- 5 DO NOT pull or carry vacuum cleaner by the cord or use the cord as a handle.
- 6 DO NOT unplug by pulling on cord. Grasp the plug, not the cord.

- 7 DO NOT handle plug or vacuum cleaner with wet hands.
- 8 DO NOT run the vacuum cleaner over the power cord, close a door on the cord or pull cord around sharp corners.
- 9 The use of an extension cord is NOT recommended.
- 10 DO NOT leave vacuum cleaner when plugged in.
- 11 Keep cord away from heated surfaces.

### GENERAL USE

- 12 Use only as described in this manual.
- 13 Keep your work area well lit.
- 14 Keep the vacuum cleaner moving over the carpet surface at all times to avoid damaging the carpet fibers.
- 15 DO NOT place vacuum cleaner on unstable surfaces such as chairs or tables.
- 16 DO NOT put any objects into openings. DO NOT use with any opening blocked; keep free of dust, lint, hair, and anything that may reduce airflow.
- 17 DO NOT allow the appliance to be used by children. Close attention is necessary when used near children. This is not a toy.
- 18 DO NOT use without dust cup and/or filters in place.

# SAVE THESE INSTRUCTIONS

PLEASE READ CAREFULLY BEFORE USE

- 19 DO NOT use if airflow is restricted; if the air paths or the floor nozzle become blocked, turn the vacuum cleaner off and unplug from electrical outlet. Remove all obstructions before you turn on the unit again.
- 20 Keep nozzle away from hair, face, fingers, uncovered feet, or loose clothing.
- 21 Only use manufacturer's recommended attachments.

### DUST CUP/FILTERS/ACCESSORIES

Before turning on the vacuum:

- 22 Make sure that all filters are thoroughly dry after routine cleaning.
- 23 Make sure that dust cup and all filters are in place after routine maintenance.
- 24 Make sure brushrolls are free of blockages by removing hair and carpet fibers.
- 25 Only use Shark-brand filters and accessories (failure to do so will void the warranty).

### GENERAL CLEANING

- 26 DO NOT pick up large-sized objects.
- 27 DO NOT pick up hard or sharp objects such as glass, nails, screws, or coins that could damage the vacuum cleaner.
- 28 DO NOT use to pick up drywall dust, fireplace ash, or embers. DO NOT use as an attachment to power tools for dust collection.

- 30 DO NOT pick up smoking or burning objects such as hot coals, cigarette butts, or matches.
- 31 DO NOT pick up flammable or combustible materials (e.g., lighter fluid, gasoline, or kerosene) or use vacuum in areas where they may be present.
- 32 DO NOT pick up toxic solutions (e.g., chlorine bleach, ammonia, or drain cleaner).
- 33 DO NOT use in an enclosed space where vapors are present from paint, paint thinner, moth-proofing substances, flammable dust, or other explosive or toxic materials.
- 34 DO NOT vacuum up any liquids.
- 35 DO NOT immerse vacuum cleaner in water or other liquids.
- 36 Use extra care when cleaning on stairs.
- 37 Remove brushroll from unit before rinsing.

### POLARIZED PLUG

To reduce the risk of electric shock, this vacuum cleaner has a polarized plug (one blade is wider than the other). As a safety feature, this plug will fit into a polarized outlet only one way. If the plug does not fit fully into the outlet, reverse the plug. If it still does not fit, contact a qualified electrician. DO NOT force into outlet or try to modify to fit.

# GETTING TO KNOW YOUR SHARK® ROCKET® POWERHEAD

## WELCOME!

Congratulations on your purchase. Use this instruction manual to learn about your new vacuum's great features. From assembly to use to maintenance, you will find it all in here.

### MAIN UNIT

- A** Power/LO/Hi Switch
- B** Upper Cord Hook
- C** Height Adjust Button/Telescoping Wand
- D** Pre-Motor Filters
- E** Lower Cord Hook
- F** Dust Cup
- G** Dust Cup Release Foot Pedal
- H** Brushroll Indicator Light
- I** Suction Control
- J** Brushroll Cover Release
- K** Exhaust Grill/Post-Motor Filter
- L** Headlights

### ACCESSORIES

- M** All-Surface Brushroll
- N** Gentle Touch Hard Floor Brushroll
- O** Brushroll Holster

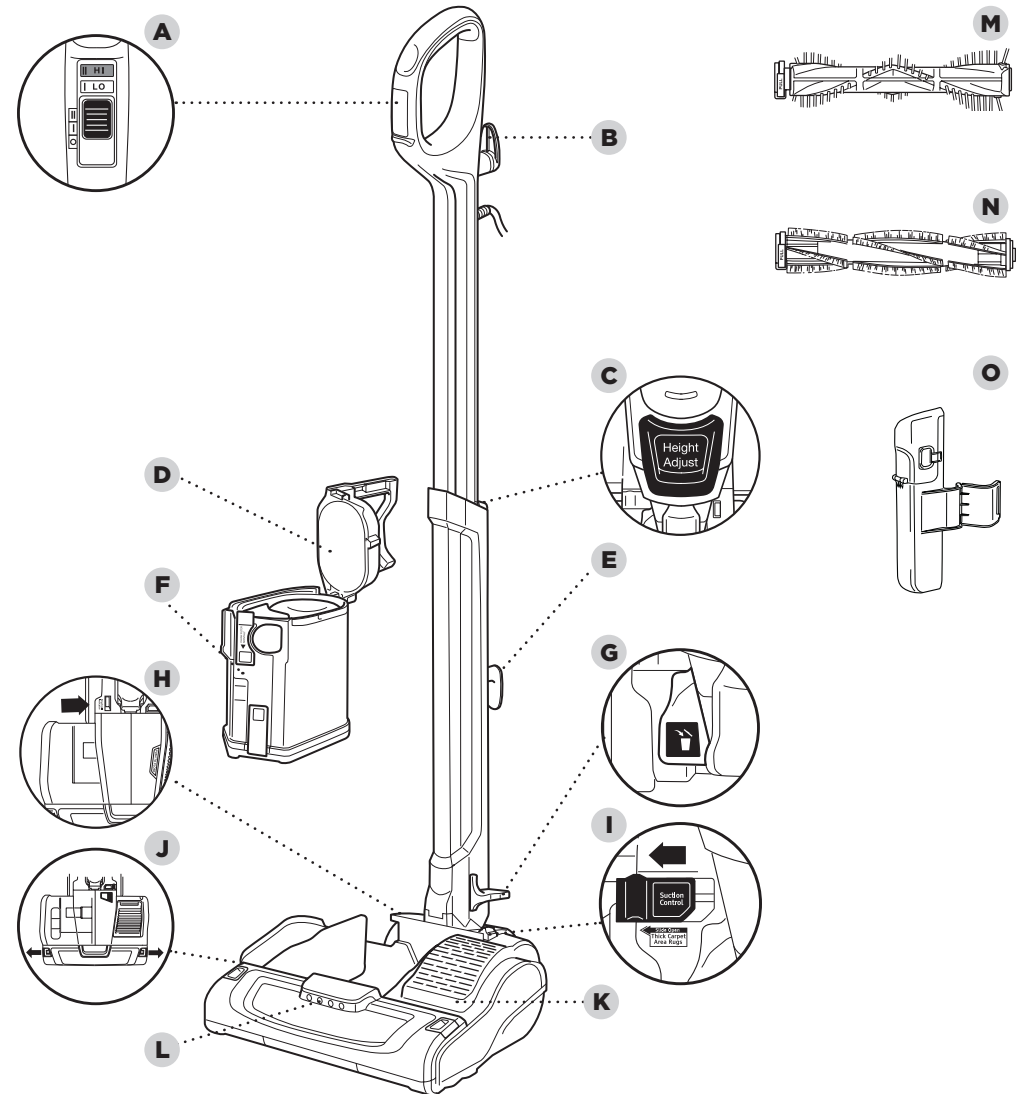

# ASSEMBLING YOUR VACUUM

★ **IMPORTANT:** Always inspect wires for damage before assembly.

## DID YOU KNOW?

The floor nozzle has LED headlights that illuminate the floor surface being cleaned. The lights turn on automatically in either speed setting.

### STEP 1

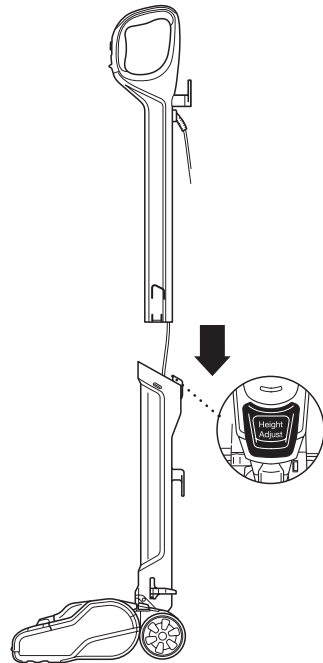

- 1 Insert upper part of the wand into lower portion while pressing the Height Adjust button until you hear a click. Make sure not to pinch the wires.

### STEP 2

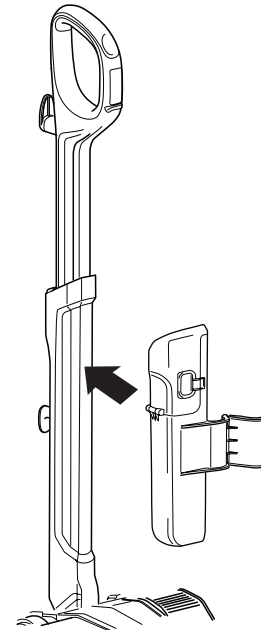

- 2 Open the holster collar by pressing "Press to detach holster"  
Place the collar so it rests on top of the lower cord hook  
Close the collar. You will hear a click.

### STEP 3

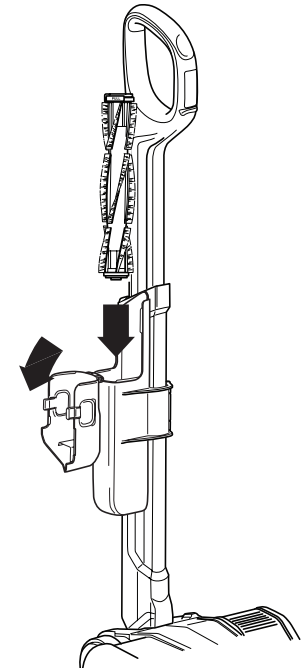

- 3 Open the holster by squeezing the two ends and insert the spare brushroll. Close before using the vacuum.

## SPEED SETTINGS

**NOTE:** Before vacuuming your delicate area rugs or carpets, refer to the manufacturer's recommended cleaning instructions.

### Less Suction

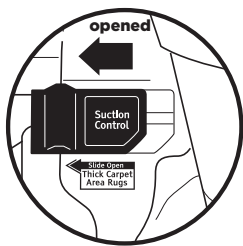

### More Suction

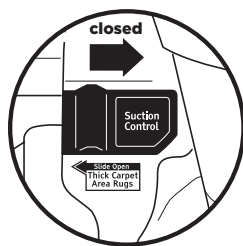

### SUCTION CONTROL

This unit has a Suction Control slider to help with push/pull on high-pile carpets and to release suction when vacuuming area rugs. Open to minimize suction. Close for maximum suction.

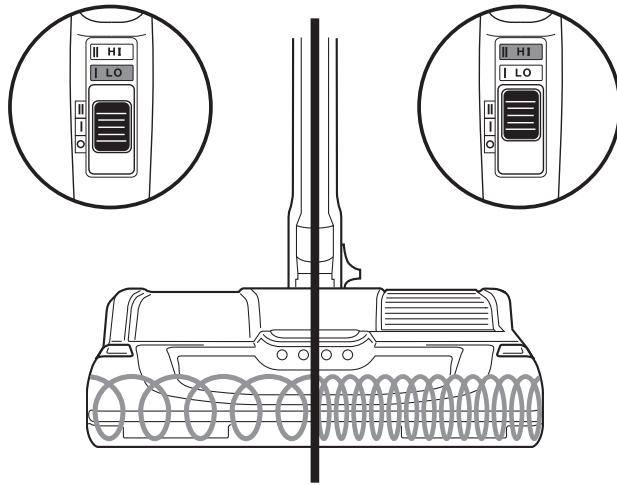

The Powerhead has a 2-speed Power slider switch on the handle.

**LO** - The brushroll spins slowly.

**HI** - The brushroll spins quickly.

## CHOOSING THE APPROPRIATE BRUSHROLL & SETTING

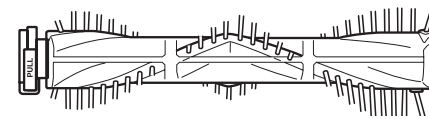

### ALL-SURFACE BRUSHROLL

**327FFJ452**

The All-Surface Brushroll can be used on all floor types. It is optimized for deep-carpet cleaning.

**LO** - For gentle cleaning on hard floors and area rugs.

**HI** - For deep-cleaning carpets by removing embedded dirt.

- 1** Plug the unit into an electrical outlet.
- 2** Slide the Power switch to the LO position to gently clean hard floors and area rugs. The brushroll will spin slowly.
- 3** Slide the Power switch to the HI position to deep-clean carpets by removing embedded dirt. The brushroll will spin quickly.

**NOTE:** For deep carpet cleaning per ASTM F608 (embedded dirt in carpets) please use the carpet brushroll on HI setting with the Suction Control closed.

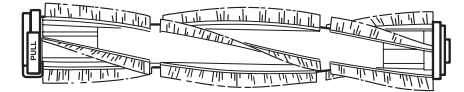

### GENTLE TOUCH HARD FLOOR BRUSHROLL

**323FFJ401**

The Gentle Touch Hard Floor Brushroll can be used on all floor types. It is optimized for enhanced hard-floor cleaning.

**LO** - For large and heavy debris pickup.

**HI** - For loose and stuck-on dust and debris.

- 1** Plug the unit into an electrical outlet.
- 2** Slide the Power switch to the LO position to clean large and heavy debris. The brushroll will spin slowly.
- 3** Slide the Power switch to the HI position to clean loose and stuck-on dust and debris. The brushroll will spin quickly.

## USING YOUR VACUUM

**TIP:** For quick cord access, rotate upper hook down and remove cord. Rotate back up for cord storage.

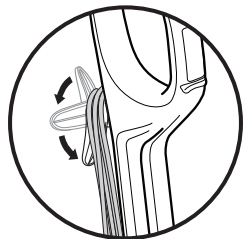

### WHAT DOES THE BRUSHROLL INDICATOR LIGHT MEAN?

#### Solid Green

The brushroll is on and working as it should.

#### Solid Red

There is a jam in the brushroll area. Turn your vacuum off and remove the blockage.

#### Flashing Red\*

The floor nozzle is overheating. Turn your vacuum off and wait for it to cool down.

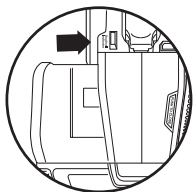

\*See Troubleshooting section for further instructions.

### STEP 1

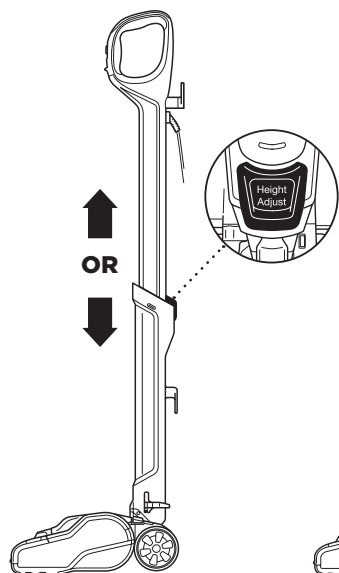

### STEP 2

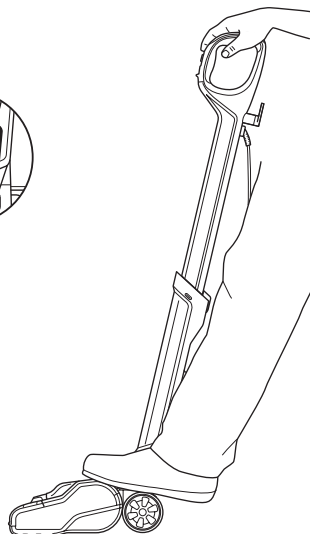

- 1 To adjust the height of the telescoping wand, unwrap power cord, press Height Adjust button, and pull wand up to increase its height or push down to decrease its height.
- 2 Plug power cord into electrical outlet. Step on floor nozzle and pull wand back. Select appropriate vacuum setting and start cleaning. Please note, the brushroll will not spin unless the wand is reclined.

## STORAGE

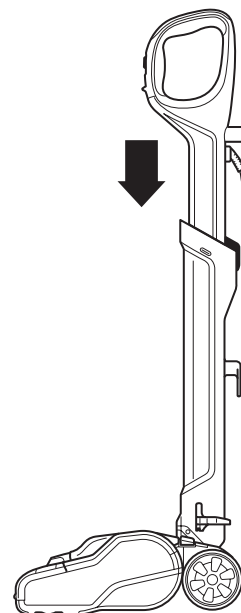

- 1 To store the vacuum, press Height Adjust button and push down on telescoping wand to decrease its height.
- 2 Wrap power cord around cord hooks.

# MAINTENANCE

**⚠ WARNING:** To reduce the risk of shock and unintended operation, turn power off and unplug unit before servicing.

**🔧 NOTE:** Clean the dust screen inside the dust cup as required.

**🔧 NOTE:** The unit will only run when the dust cup is locked into place.

**🔧 NOTE:** Empty dust cup when debris reaches the MAX fill line.

## STEP 1

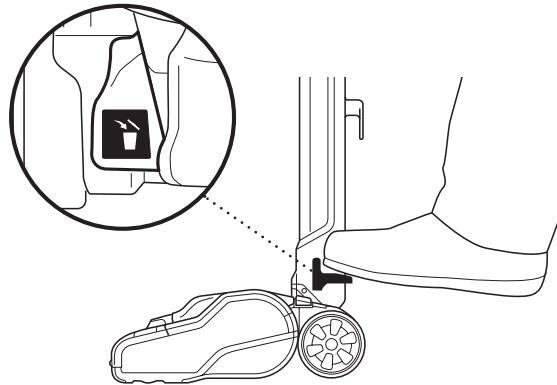

### EMPTYING THE DUST CUP

- 1 Detach the removable dust cup from the floor nozzle by pressing the dust cup release pedal located on the left side near the nozzle.

## STEP 2

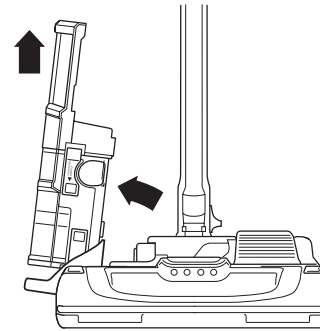

- 2 Once the dust cup pops up, hold it by the handle and lift up to remove it from the floor nozzle.

## STEP 3

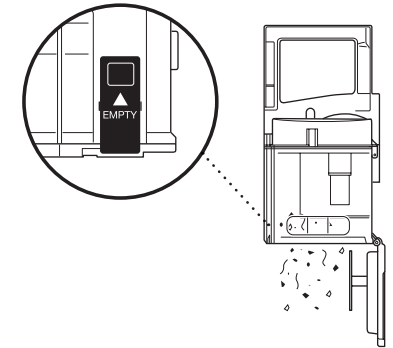

- 3 Hold the dust cup over a trash bin and press the EMPTY button. The bottom lid will open, allowing the debris to fall out.



# MAINTENANCE

**⚠ WARNING: Hand wash filters with water only to prevent damage from cleaning chemicals. Allow ALL filters to dry completely before replacing in the vacuum to prevent liquid from being drawn into electric parts.**

## RECOMMENDED FILTER CLEANING SCHEDULE:

### Pre-Motor Filter Kit

(Foam & Felt)  
XFFH400  
Clean once a month.

### Post-Motor Filter

XEXFH400  
Clean once a year.

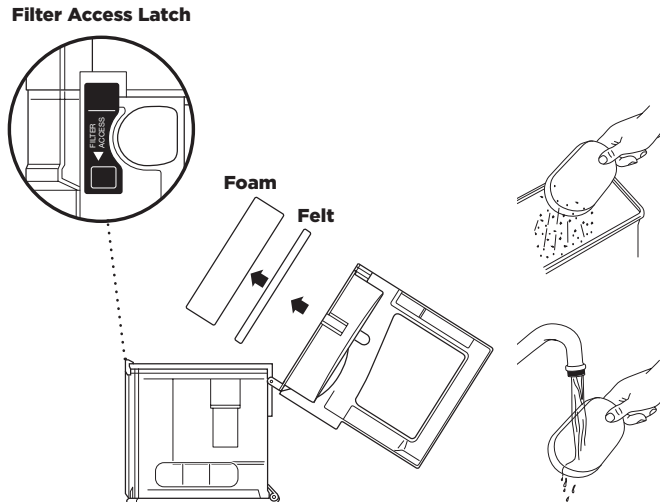

## CLEANING THE FILTERS

### Pre-Motor Filters

Access the pre-motor filters by pressing the FILTER ACCESS latch on the top of the dust cup. Remove and rinse the foam and felt filters with water. Tap loose dirt off filters between washes as needed. Once completely dry, insert the felt filter first, then place the foam filter on top of it.

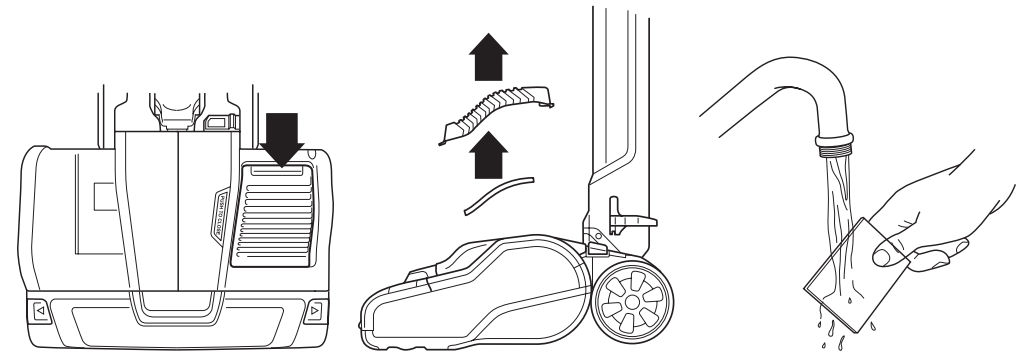

### Post-Motor Filter

Access the post-motor filter on top of the floor nozzle. Remove and rinse with water.

# MAINTENANCE

**⚠ WARNING:** To reduce the risk of shock and unintended operation, turn power off and unplug unit before servicing.

★ **IMPORTANT:** Remove brushroll before rinsing.

★ **IMPORTANT:** DO NOT place brushroll in the dishwasher to wash or the dryer to dry. DO NOT submerge brushroll in water.

★ **IMPORTANT:** Using a wet brushroll in the floor nozzle will void your warranty.

## DID YOU KNOW?

The brushroll endcap is removable to help clear hair/debris. Ensure the endcap is pressed firmly onto the brushroll to reassemble.

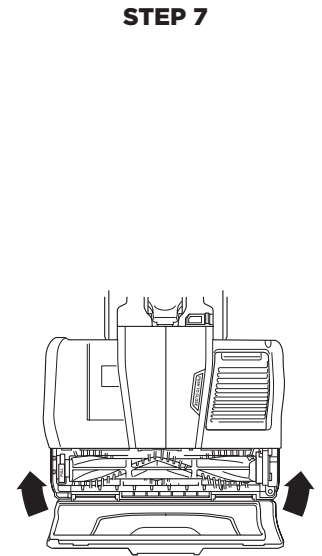
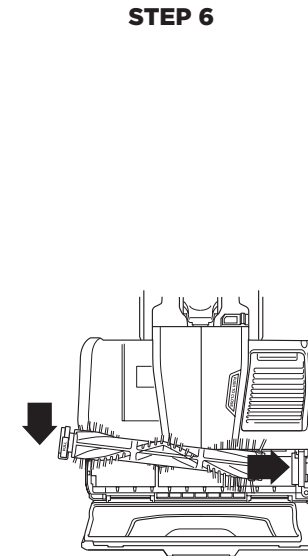
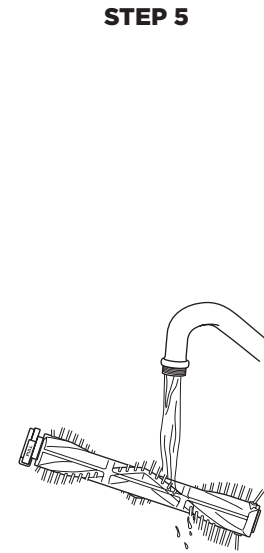
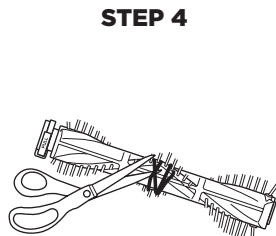
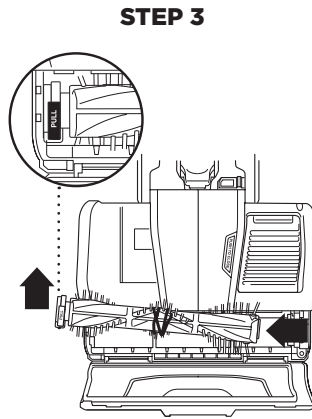
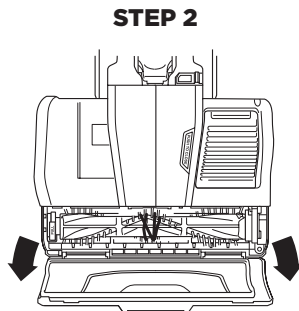
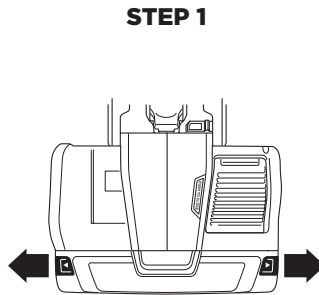
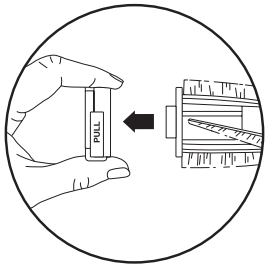

## ACCESSING & CLEANING THE BRUSHROLL

- 1 Slide the brushroll garage release buttons out.
- 2 Pull up to open the brushroll garage.

- 3 Lift the endcap on the brushroll up to remove it from the floor nozzle.
- 4 Remove any hair, fibers, or debris wrapped around the brushroll. The groove on the brushroll allows scissors to cut the debris without damaging the bristles.

- 5 The brushroll can be rinsed under running water. Let the brushroll air-dry completely before replacing in the vacuum.

- 6 To reassemble, hold the brushroll by the endcap and align the other end with the gear. With the endcap facing up, place the brushroll in the floor nozzle.

- 7 Close the brushroll garage. Listen for a click and make sure the release buttons are fully closed.

**NOTE:** The brushroll will only spin if the brushroll cover is fully closed and locked.







**SharkNinja Operating LLC**  
**US: Newton, MA 02459**  
**CAN: Ville St-Laurent, QC H4S 1A7**  
**1-800-798-7398**  
**sharkclean.com**

Illustrations may differ from actual product. We are constantly striving to improve our products; therefore the specifications contained herein are subject to change without notice.

Shark and Rocket are registered trademarks of SharkNinja Operating LLC.

For SharkNinja U.S. Patent information, visit [www.sharkninja.com/USPatents](http://www.sharkninja.com/USPatents)

