

euroflex®

monster

of italy

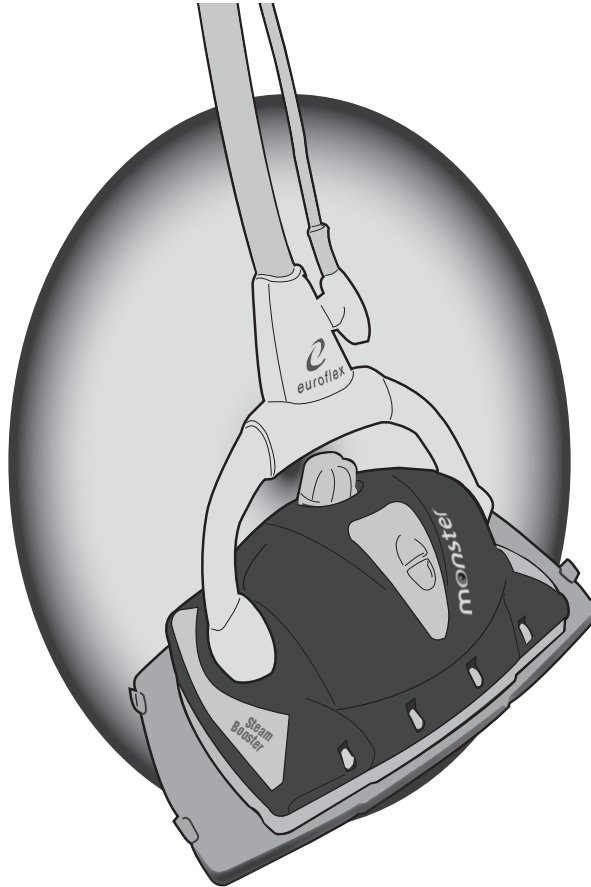

EZ1 XL PLUS FLOOR STEAMER

INSTRUCTION MANUAL



For Authentic Monster Replacement Parts
Call **888-896-8786**

Model #:
EZ1 XL Plus

IMPORTANT SAFE T

When using an electrical appliance, basic safety precautions should always be observed, including the following:

Read all instructions before using this appliance.

WARNING: To reduce the risk of fire, electrical shock, or injury:

1. This appliance is authorized for household/residential use only.
2. Do not charge or use outdoors or on wet surfaces. Do not immerse the floor steamer in water or other liquids.
3. Do not allow to be used as a toy. Close attention is necessary when used by or near children. Do not leave Steamer unattended. Always unplug unit when not in use.
4. Use only as described and for the uses described in this manual. Use only manufacturer's approved and supplied parts and accessories. Use of other accessories is not recommended and will void warranty.
5. Always make sure the Handle Assembly is in the upright position before plugging in or unplugging. Keep cord away from heated surfaces (e.g., cooking surfaces), and sharp edges and corners.
6. Do not use if power cord or plug has been damaged, or if any part of appliance has been dropped, damaged, left outdoors, or dropped in water. Do not attempt to disassemble or repair appliance. Return it to manufacturer or an authorized service center for examination or repair.
7. Do not wrap cord too tightly around appliance. Never carry by the cord, or yank to disconnect from an outlet. To unplug, always grasp plug to remove from outlet – do not pull on cord.
8. Do not handle cord or appliance with wet hands or without shoes on.
9. Look closely at steamer and follow all labels and marking instructions.
10. Do not put any objects into openings. Do not use with any opening blocked.
11. Keep hair, loose clothing, fingers, and all parts of body away from openings and moving parts.
12. Before filling with water or emptying, always place Handle Assembly in upright position, unplug the appliance and allow it to cool completely. Always turn the Boiler Cap slowly to open the water tank – this will allow any remaining steam to escape gradually.
13. Use caution while emptying the appliance. Contact with hot water or steam may cause burns.
14. Be sure Boiler Cap is (and remains) closed during use.
15. Never use cleaning solutions, perfumes, oils or other chemical substances other than tap or distilled/demineralized water in the Steamer. Use of chemicals may damage Steamer and will void your warranty.
16. When in use, never turn the appliance on its side. Do not direct steam at people, animals or other electrical equipment (i.e, inside an oven).

E TY INSTRUCTIONS

SAVE THESE INSTRUCTIONS

17. Do not operate around flammable or combustible liquids such as gasoline, or in areas where fumes may be present.
18. Not for space heating purposes.
19. To reduce the likelihood of circuit overload, do not operate another high wattage appliance on the same circuit. Plug in to a standard (120V, 60Hz) electrical outlet.

ATTENTION: This appliance is equipped with a 3-prong grounded power cord. Insert only into a 3-prong grounded electrical outlet. Do not try to remove the contacts of the grounded connection.

20. Do not use extension cords or outlets with inadequate voltage. Use only heavy duty, high-rated extensions cords.
21. Store appliance indoors in a cool, dry place.
22. If appliance is damaged, it must be repaired by manufacturer or its service agent or a similarly qualified person in order to avoid safety issues to the operator.
23. This appliance is not intended for use by persons (including children) with reduced physical, sensory or mental capabilities, or lack of experience and knowledge, unless they have been given supervision or instruction concerning use of appliance by a person responsible for their safety.
24. Read and follow all important notices in this guide.

CAUTIONS

- Do not use your Floor Steamer without a Hard Surface Pad or Carpet Glide & Pad attached to the system.
- Never leave your Floor Steamer in one spot on any surface for any period of time. Make sure that the Floor Steamer Handle Assembly is in the full "UP POSITION" when not in use - this turns the Steamer Off.

IMPORTANT

Please read all of the instructions for use and Important Safety Instructions carefully. Remove and discard all packaging materials and keep them out of the reach of children.

● Save your back

No need to press hard

The steamer does the work for you



For Authentic Monster Replacement Parts
Call **888-896-8786**

One (1) Floor Steamer

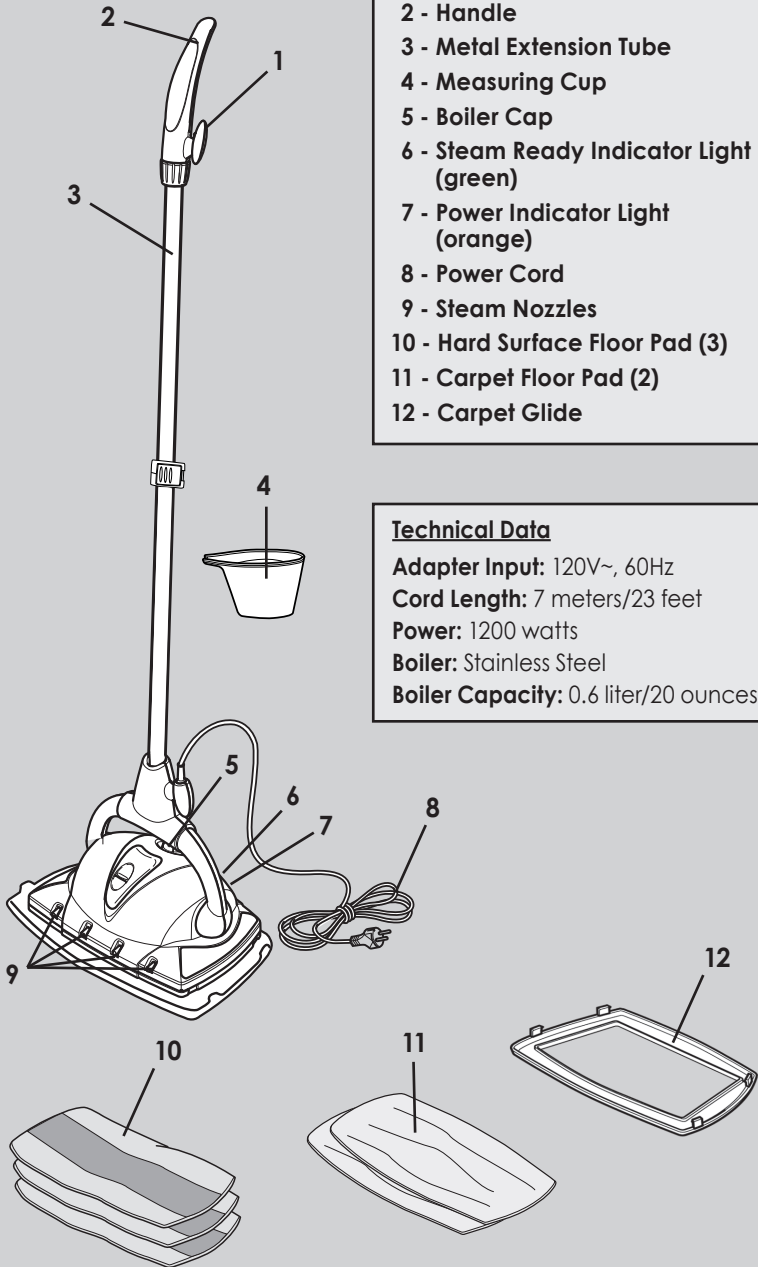

- 1 - Cord Winder
- 2 - Handle
- 3 - Metal Extension Tube
- 4 - Measuring Cup
- 5 - Boiler Cap
- 6 - Steam Ready Indicator Light (green)
- 7 - Power Indicator Light (orange)
- 8 - Power Cord
- 9 - Steam Nozzles
- 10 - Hard Surface Floor Pad (3)
- 11 - Carpet Floor Pad (2)
- 12 - Carpet Glide

Technical Data

Adapter Input: 120V~, 60Hz
Cord Length: 7 meters/23 feet
Power: 1200 watts
Boiler: Stainless Steel
Boiler Capacity: 0.6 liter/20 ounces

1 Assembly of Parts & Preparation of Steamer

Make sure all parts are in the box (see pg 4).

IMPORTANT: FOLLOW THESE INSTRUCTIONS CAREFULLY!

A. Assemble Handle

After removing Handle Assembly from carton:

- Pull Extension Tube apart (shown below).

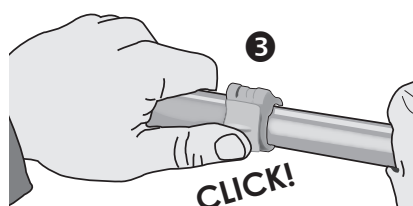
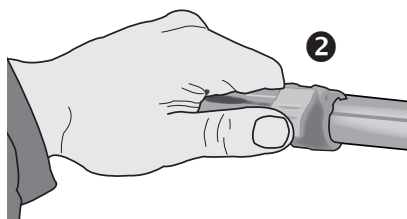
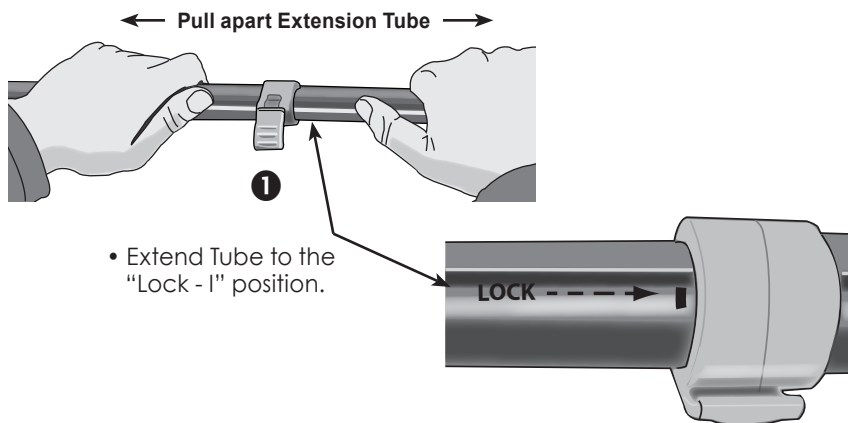

- Snap connector down. When a "click" is heard, the Tube is locked in position.



IMPORTANT

Frontal steam can only be generated when Extension Tube is in the "Maximum Extension" position. **BE SURE EXTENSION TUBE IS FULLY EXTENDED AND LOCKED IN PLACE FOR OPTIMAL STEAM OPERATION.** Use Extension Tube in Collapsed position only with the Carpet Glide (when cleaning upholstery) or when storing.

B. Attach Handle to Steamer

- Before starting, remove the self-tapping screw from the bottom of Extension Tube.
- Insert the Handle Assembly into the Floor Steamer Base. Align Arrow on Handle with Arrow on Base (as shown in Fig. A).
- Once inserted, twist Handle Assembly 90° clockwise (as shown in Fig. B). Be sure Arrow on the Handle is aligned with Line/Lock Icon on Base.

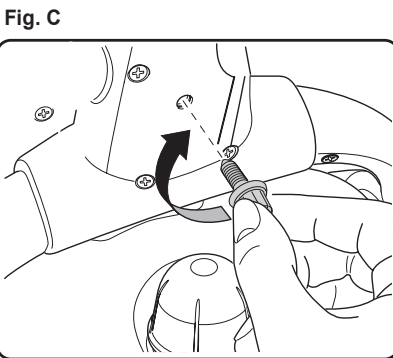
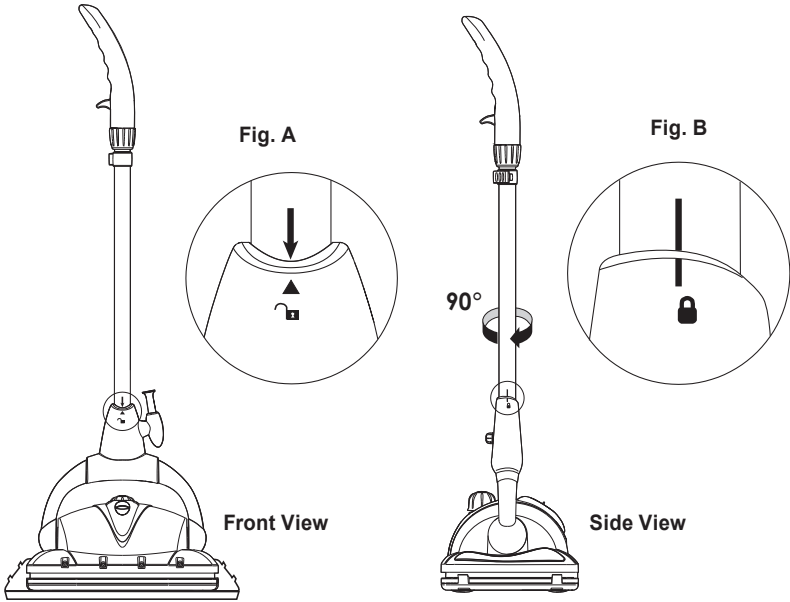

- Align the Handle Assembly screw hole with the opening in the steamer housing. Secure the handle assembly with self-tapping screw which was removed from bottom of Extension Tube (as shown in Fig. C).

C. Attach Hard Surface Floor or Carpet Pad to Steamer

Affix either the Hard Surface Floor Pad or Carpet Glide with Carpet Pad to your Floor Steamer.

WARNING: To prevent floor damage, ALWAYS attach either the HARD SURFACE FLOOR PAD or the CARPET GLIDE ACCESSORY with CARPET PAD when using your Floor Steamer. NEVER use without either of these attachments affixed to the machine.

ATTACHING HARD SURFACE FLOOR PAD

Place Floor Pad face down on the floor, wide side forward, with white hook and loop strips facing up. Hold Floor Steamer about 2" above Pad and gently place Floor Steamer onto the Pad. Firmly press down to assure Pad is securely adhered to the Floor Steamer.

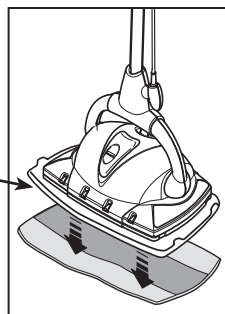

ATTACHING CARPET GLIDE WITH CARPET PAD

Place Carpet Glide face up on floor. Center and place Carpet Pad on top of Carpet Glide, wide side forward, with white hook and loop strips facing up. Hold Floor Steamer about 2" above Pad and gently place Floor Steamer onto the Pad. Firmly press down to assure Pad is adhered to the Floor Steamer and Carpet Glide is securely attached.

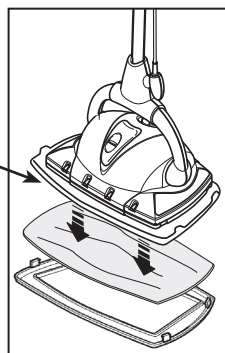

USE ON HARDWOOD FLOORS

For hardwood floors, use only on "sealed" hardwood surfaces. Carefully control the amount of steam used when cleaning, as too much water could cause damage.

IMPORTANT NOTE ABOUT LINOLEUM FLOORING

Steam can cause wax to be stripped from, and consequently damage, some varieties of linoleum flooring. ALWAYS test a small, inconspicuous portion of the floor BEFORE using steam to ensure that your linoleum floor does not have this issue.

NOTE: See "Maintenance & Cleaning" for care and cleaning instructions for Microfiber Pads.

For Authentic Monster Replacement Parts
Call 888-896-8786

D. Filling Boiler with Water

WARNINGS:

- Carefully read all instructions before removing Boiler Cap.
- Always unplug appliance before filling the Boiler.

IMPORTANT

Use tap water – distilled or demineralized water if tap water is too hard. DO NOT add detergents, perfumes, oils or other chemical substances.

Follow these instructions to avoid overflowing the Boiler.

- Be sure appliance is unplugged, and has cooled for at least 10 minutes before filling with water.
- Make sure Handle Assembly is in the upright "Off" position. Remove Boiler Cap by pressing it down and turning it counter-clockwise.
- Pour in a maximum of 0.6 l / 20 oz. water using the provided measuring cup. Make sure that **water does not overflow**. Replace Boiler Cap by pressing it down and turning it clockwise. If using cold water, heating time is about 3-5 minutes. If using warm water, heating time is reduced.

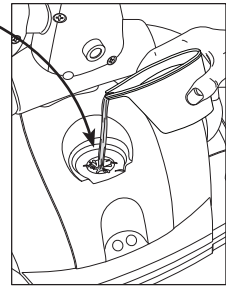
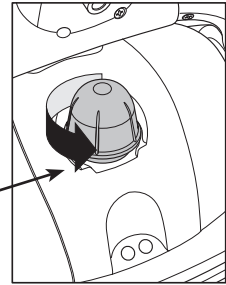

IMPORTANT

If re-filling the Boiler while Steamer has been in use, be sure to allow Steamer to cool for at least 10 minutes and loosen Boiler Cap slowly to allow any excess steam to escape before completely removing Cap. (See step 2C, "Refilling Boiler During Use" for detailed instructions.)

2 Using Your Floor Steamer

A. Starting the Appliance

- Be sure Boiler is filled with water and Boiler Cap is securely in place.
- Insert the plug into a 3-prong grounded electrical outlet (orange Power Indicator Light will illuminate).
- **Keeping the handle in the upright "Off" position**, wait until the (green) Steam Ready Indicator Light illuminates.

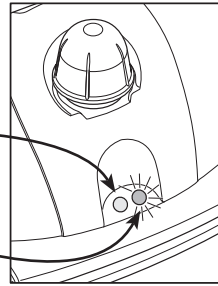

Once Boiler is filled and the green Steam Ready Indicator Light glows, the Steamer is ready to clean. (Steam temperature at the nozzle end is between 104°C / 219°F and 115°C / 239°F. Temperature lowers to 38°C / 100° F at a distance of 25cm / 10 in from the nozzles.

B. Using Steam

- To emit steam from the underside of the Steamer, simply pull the Handle downwards.
- Return Handle to upright position to stop steam.

You will find that your Floor Steamer can easily clean and refresh most hard surfaces and floors using the underside steam alone.

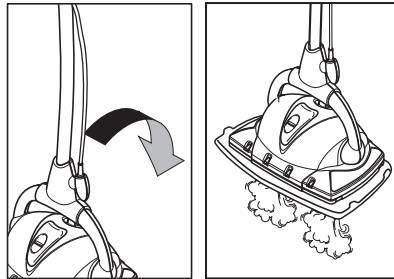

NOTE: Some water may be emitted. This is normal.

- To emit steam from the Steam Nozzles, push the trigger on the Handle.

NOTE: Your Steamer will not need the Boiler refilled for up to 30 minutes.

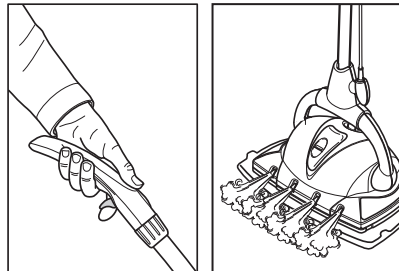

For Authentic Monster Replacement Parts
Call **888-896-8786**

IMPORTANT

The Steam Nozzles are meant to be used in steam “bursts” and should never be used on a sustained basis. The Steam Nozzles will loosen especially difficult debris and will also assist in treating hard to reach areas.

The Floor Steamer will stop producing steam when the Boiler is empty. When this happens unplug and store unit or refill with water per instructions (1D).

C. Refilling Boiler During Use

WARNING: Let Steamer cool 10 minutes before opening Boiler Cap. Use care when opening the Boiler Cap – it may still be hot and steam may escape, causing burns. If Boiler is still hot, water may spurt out during refilling – this can also cause burns.

- Unplug appliance.
- Press trigger on the Handle to clear steam from Steam Nozzles.
- Press down and slowly turn Boiler Cap counterclockwise. This will allow remaining steam to escape.
- **Be sure Steamer has cooled 10 minutes before refilling with water.**
- Fill Boiler using Measuring Cup provided. *Be sure Steamer Handle remains in the upright “Off” position.*
- Firmly push down and screw Boiler Cap back on by turning it clockwise.
- Insert plug into 3-prong electrical outlet.

REMINDERS

- Always use tap water.
- If tap water is too hard, use distilled or demineralized water to avoid the risk of staining pale colored fabrics.
- Do not add detergents, perfumes, oils or other chemical substances.

3 Cleaning and Rinsing Floor Steamer

If distilled or demineralized water is regularly used there is no need to clean the Boiler.

Rinsing the Boiler

We recommend you periodically rinse the Floor Steamer to prevent the accumulation of calcium and sediment caused by hard water use. After 10 - 15 uses, fill the Boiler 3/4 full with hot tap water, shake several times and empty out into sink or bathtub. Wipe the Steamer base with a damp cloth and wipe dry.

NEVER HOLD THE STEAMER UNDER TAP TO FILL. Use the Measuring Cup provided to fill.

Cleaning the Boiler

If you use tap water, we recommend cleaning the Boiler every 3-4 months (depending on mineral buildup). Use a Hard Water Mineral Remover (found in most hardware or small appliance stores).

- Remove Boiler Cap and empty water from Boiler into a sink.
- Follow manufacturer's instructions on cleaner package, and fill tank with specified amount of cleaner.
- Empty cleaner from Boiler and fill with water. Rinse thoroughly and empty from Boiler. Repeat until water in tank comes out clear.
- Replace Boiler Cap and store appliance properly.

Cleaning of Boiler and Steamer is the sole responsibility of appliance owner and is not covered by the product warranty.

Before first use after cleaning the Boiler, hold Steamer so it is facing downward and direct steam into a sink or standing shower to clear any leftover residue from Boiler. When clean drops of water appear, wipe clean with soft cloth. Your Steamer is ready for use.

Microfiber Pad Care & Cleaning

Your Microfiber Pads are designed for hundreds of uses. Clean Pads regularly, either by hand (using mild soap and warm water) or in your clothes washer on a delicate cycle, cool water. Never use fabric softener or bleach. We recommend letting Pads air dry to maintain maximum long term effectiveness.

Microfiber washing instructions – ULTRA MICROFIBRE

75% Polyester / 25% Polyamide
Hand wash only
Tumble dry low or air dry
No bleach / No fabric softener

80% Polyester / 20% Polyamide
Hand wash only
Tumble dry low or air dry
No bleach / No fabric softener

Issues	Possible Causes	Solutions
Steam is not coming out of the Steam Nozzles.	Improper Handle assembly.	Call Customer Service to receive instructions to correct the problem.
The Hard Surface Floor Pad is not adhering to Steamer.	No enough pressure was applied when attaching Pad.	Position Steamer about 2" above Pad and FIRMLY press it down onto the Pad.
The Cleaning Pads are getting soaked (too wet). Why?	Boiler is overfilled.	Let Steamer run until excess water ceases. -OR- Remove some water from Boiler.
	Green "Steam Ready Indicator Light" is not illuminated.	Wait for green "Steam Ready Indicator Light" to illuminate.
The steam seems to be making my floor too wet.	Steam Nozzles are being used too frequently.	Only use Steam Nozzles in short bursts for cleaning tougher stains or to clean hard to reach areas.
The green Steam Ready Indicator Light seems "dull".	Optical illusion.	Because the subtle green light is positioned next to the more vibrant orange light, it is naturally overpowered by the brighter color.

IMPORTANT QUESTION:

Q: Do I always need to use a Microfiber Pad when cleaning with my Steamer?

A. YES! It is critically important to ALWAYS use your Microfiber Pads. The Floor Steamer should NEVER be used without either a Hard Surface Floor Pad or Carpet Glide with Carpet Pad.

