



Figures and illustrations in this User Manual are provided for reference only and may differ from actual product appearance. Product design and specifications may be changed without notice.

## Important Warranty Information Regarding Television Format Viewing

See the warranty card for more information on warranty terms.

Wide screen format LED Displays (16:9, the aspect ratio of the screen width to height) are primarily designed to view wide screen format full-motion video. The images displayed on them primarily be in the wide screen, 16:9 ratio format, or expanded to fill the screen if your model offers this feature and the images are constantly moving. Displaying stationary graphics and images on screen, such as the dark sidebars on non- expanded standard format television video and programming, should be limited to no more than 5% of the total television viewing per week. Additionally, viewing other stationary images and text such as stock market reports, video game displays, station logos, web site or computer graphics and patterns, should be limited as described above for all televisions. Displaying stationary images that exceed the above guidelines can cause uneven aging of LED Displays that leave subtle, but permanent burned-in ghost images in the LED picture. To avoid this, vary the programming and images, and primarily display full screen moving images, not stationary patterns or dark bars. On LED models that offer picture sizing features, use these controls to view different formats as a full screen picture. Be careful in the selection and duration of television formats you use for viewing. Unseen LED aging as a result of format selection and use, as well as burned-in images, are not covered by your Samsung limited warranty.

SAMSUNG ELECTRONICS NORTH AMERICAN LIMITED WARRANTY STATEMENT

Subject to the requirements, conditions, exclusions and limitations of the original Limited Warranty supplied with Samsung Electronics (SAMSUNG) products, and the requirements, conditions, exclusions and limitations contained herein, SAMSUNG will additionally provide Warranty Repair Service in the United States on SAMSUNG products purchased in Canada, and in Canada on SAMSUNG products purchased in the United States, for the warranty period originally specified, and to the Original Purchaser only.

The above described warranty repairs must be performed by a SAMSUNG Authorized Service Center. Along with this Statement, the Original Limited Warranty Statement and a dated Bill of Sale as Proof of Purchase must be presented to the Service Center.



BN58-04214A-01

© 2012 Samsung Electronics Co., Ltd. All rights reserved.

To add channels to the **Added Channels** list, follow these steps:

- Select one or more channels in the **All Channels** list using the **▲/▼** buttons and the **Yellow Select** button on your remote.
- Press the **TOOLS** button on your remote. The Tools menu appears.
- Select **Add** in the Tools menu, and then press the **ENTER** button.

All deleted channels will be shown on the **All Channels** list. You add channels back to the **Added Channels** list on the **All Channels** list.

A gray-colored channel indicates the channel has been deleted from the **Added Channels** list.

The **Add** menu option only appears for deleted channels.

**Add to Favorite/Delete from Favorite:** Lets you add channels to and delete channels from your **Favorites** list.

To add channels to the **Favorites** list, follow these steps:

- Select one or more channels in the **All Channels** list using the **▲/▼** buttons and the **Yellow Select** button on your remote.
- Press the **TOOLS** button on your remote. The Tools menu appears.
- Select **Add to Favorite** in the Tools menu, and then press the **ENTER** button.

To delete channels from the **Favorites** list, follow these steps:

- Select one or more channels in the **Favorite Channels** list using the **▲/▼** buttons and the **Yellow Select** button on your remote.
- Press the **TOOLS** button on your remote. The Tools menu appears.
- Select **Delete from Favorite** in the Tools menu, and then press the **ENTER** button.

**Timer Viewing:** You can schedule a channel to be displayed automatically at a set time, even when you are watching another channel. You must set the current time first in the **Time > Clock** function to use **Time Viewing**.

To schedule a channel, follow these steps:

- Select a channel in the **Added Channels** list using the **▲/▼** buttons and the **Yellow Select** button on your remote.
- Press the **TOOLS** button on your remote. The Tools menu appears.
- Select **Time Viewing** in the Tools menu, and then press the **ENTER** button. The Time Viewing screen appears.

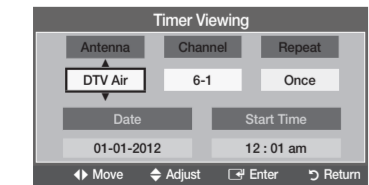

Use the **◀/▶** buttons to move from entry field to entry field and the **▲/▼** buttons to change the entries. Where numbers are displayed, you can also enter numbers directly using the number keypad on your remote.

- If you select **Everyday** or **Every Week**, the date you select in the Date field becomes the start date for your scheduled viewing. For **Everyday**, the TV will turn on every day, at the time you selected, starting from that date. For **Everyweek**, the TV will turn on every week, on the same day of the week as the start date you selected, at the time you selected, from that day on. If you select **Once**, the TV will turn on once, on the date and time you selected.

Press the **ENTER** button on your remote when done.

- Only Added Channels** can be scheduled.
- Scheduled programs and channels are displayed in the **Programmed List**.
- When you select a digital channel, press the **▶** button to view the digital program list. If you highlight a program in the list, and then press the **ENTER** button, you set **Timer Viewing** for that program directly.

- Select All:** Select all the channels in the displayed channel list.
- Deselect All:** Deselect all the selected displayed channels.
  - You can only select **Deselect All** when one or more channels are selected.

**Channel Name Edit:** Analog channels only. Lets you assign a name of up to five characters to an analog channel. For example, **Hot, Food, Golf**, etc. This makes it easier to find and select a channel.

**Auto Program:** See **Auto Program** under Memorizing Channels.

## Programmed List (on the Channel List Screen)

The **Programmed** list displays the channels and programs you have scheduled for viewing using the **Time Viewing** function. You can view, modify, or delete a show you have scheduled using the functions on the **Programmed List** screen Tools menu.

## Programmed List Screen Tools Menu

**Change Info:** Change the scheduling information for a show or channel you have scheduled.

To change the information, follow these steps:

- Select the **Programmed** List icon on the left side of the **Channel List** screen, and then press the **ENTER** button.
- On the **Programmed** List screen, select the show or channel entry you want to change, and then press the **TOOLS** button. The Tools Menu appears.
- Select **Change Info.** and then press the **ENTER** button. The **Time Viewing** screen appears.
- Use the **◀/▶** buttons to move from entry field to entry field and the **▲/▼** buttons to change the entries. Where numbers are displayed, you can also enter numbers directly using the number keypad on your remote.
- Press the **ENTER** button when done.

**Cancel Schedules:** Cancel a show or channel you have scheduled.

To cancel a scheduled show or channel, follow these steps:

- Select the **Programmed** List icon on the left side of the **Channel List** screen, and then press the **ENTER** button.
- On the **Programmed** List screen, select the show or channel entry you want to cancel, and then press the **TOOLS** button. The Tools Menu appears.
- Select **Cancel Schedules.** and then press the **ENTER** button. The **Cancel Schedule** screen appears.
- Select **OK.** and then press the **ENTER** button.

## The On Screen Menus

Your TV has two kinds of menus, the Main menu and the various Tools menus. The Main menu gives you access to most or all of the menu options available on your TV. The Tools menus display a selected number of frequently used menu options that change depending on the screen you are viewing. A Tools menu symbol (🔧) in the lower right side of the screen indicates that a Tools menu is available.

The Main menu has seven primary categories:

- Picture
- Input
- Sound
- Application
- Channel
- Support
- Setup

To view the Main menu, press the **MENU** button on your remote. To view a Tools menu, press the **TOOLS** button on your remote.

The menu options that appear in the Main menu depend on the Source you have selected. For example, if you have selected the HDMI source, the Channel category will not appear. To see the Channel category, you must first select TV in the Source List.

The Menu options are presented below, arranged by Main menu categories. A Tools button symbol (🔧) next to an option name indicates the option is also available in one of the Tools menus.

## Picture Menu

### Mode

Select your preferred picture mode.

- When your TV is connected to a PC, you can only select **Entertain** and **Standard**.
- Dynamic:** Brightens the screen. Suitable for a bright room.
- Standard:** Suitable for a normal normal.
- Movie:** Darkens the screen, making it less gray. Suitable for watching movies in a darkened room.
- Entertain:** Sharpens the picture. Suitable for games.
  - Only available when the TV is connected to a PC.

## Backlight / Contrast / Brightness / Sharpness / Color / Tint (G/R)

- Backlight:** Adjusts the brightness of the screen by adjusting the brightness of the individual pixels.
- Contrast:** Increases or decreases the contrast between dark and light areas of the picture.
- Brightness:** Adjusts the brightness of the screen. Not as effective as **Backlight**.
- Sharpness:** Sharpens or dulls the edges of objects.
  - Color:** Adjusts the color saturation. The higher the Color setting, the more intense the color. Low settings remove color and the picture becomes black, white and gray.
- Tint:** Adjusts the amount of green and red in the picture. As you increase the amount of green, the amount of red decreases and vice versa.
  - When the TV is connected to a PC, you can only make changes to **light, Contrast, Brightness, and Sharpness**.

- Information:** Display the information for a show or channel you have scheduled. You can also change the schedule information.
  - Select the **Programmed** List icon on the left side of the **Channel List** screen, and then press the **ENTER** button.
  - On the **Programmed** List screen, select the show or channel entry you want information for, and then press the **TOOLS** button. The Tools Menu appears.
  - Select **Information.** and then press the **ENTER** button. The **Time Viewing** Information screen appears.
  - Select **Change Info** and press the **ENTER** button to change information, or select **Close** and press the **ENTER** button to close the Information screen.
- Select All / Deselect All:** You can select or deselect all channels in the channel list.

## Other Channel Menu Functions

**Channel Mode (Added Channels/Favorite Channels)**

Lets you select the channel list displayed when you press the **▲CH▼** (Channel) button on your remote. For example, if you select **Favorite Channels**, you will only see Favorite channels when you press the **▲CH▼** button.

## Fine Tune

Analog channels only.

If the reception is clear, you do not have to fine tune the channel, as this is done automatically during the search and store operation. If the signal is weak or distorted, fine tune the channel manually.

- Select the channel, and then select **Fine Tune**.
- Fine tuned channels that have been saved are marked with an asterisk "\*" on the right-hand side of the channel number in the channel banner.
- To reset fine-tuning, select the channel, select **Fine Tune**, and then select **Reset** on the **Fine Tune** screen.

## Setup Menu

### Plug & Play

Lets you re-run the **Plug & Play** initial setup procedure. For instructions, see your Quick Start Guide.

### Language

Set the menu language.

- Choose between **English, Español, and Français**.

## Setting the Time

### Time

- The time you set will appear when you press the **INFO** button.
- Clock:** Set the clock so you can use the various timer features of the TV.
  - If you disconnect the power cord, you have to set the clock again.

## Advanced Settings

Available in **Standard** and **Movie** mode only.

Compared to previous models, new Samsung TVs offer a more precise picture with more precise controls.

When your TV is connected to a PC, you can only make changes to **Gamma** and **White Balance**.

**Color Space (Auto / Native):** Auto automatically matches the range of colors available to create pictures to the color range of the video source. Native provides a color range wider than the color range of the video source.

**White Balance:** Adjusts the color temperature of the picture so that white objects look white (instead of, for example, slightly pink or slightly yellow) and the overall color of the picture looks natural.

**R-Offset / G-Offset / B-Offset:** Adjusts each color's (red, green, blue) darkness.

**R-Gain / G-Gain / B-Gain:** Adjusts each color's (red, green, blue) brightness.

**Reset:** Resets the **White Balance** to it's default settings.

**Gamma:** Adjusts the primary color intensity.

**Dynamic Contrast (Off / Low / Medium / High):** Adjusts the screen contrast.

**Black Tone (Off / Dark / Darker / Darkest):** Selects the black level to adjust the screen depth. Darker settings make blacks look darker.

**Flesh Tone:** Adjusts the amount of red in skin tones.

**Motion Lighting (Off / On):** When on, the TV automatically adjusts the brightness of the screen in response to the brightness of the room. In bright light, the screen brightens. In dim light, the screen dims.

- Available in **Standard** mode only.

## Picture Options

When the TV is connected to a PC, you can only make changes to the **Color Tone, Size and HDMI Black Level**.

- Color Tone (Cool / Standard / Warm / Warm2):** Cool makes the picture blur cooler. Warm 1 and Warm 2 make the picture redder (warmer).
  - Warm1** and **Warm2** are deactivated when the picture mode is set to **Dynamic**.
- Size:** Set the size and aspect ratio of the picture on the screen. Your cable box or satellite receiver may have its own set of screen sizes as well. However, we highly recommend you use the TVs 16:9 mode most of the time.

**16:9:** Sets the picture to the 16:9 wide screen format.

**Zoom1:** Provides moderate magnification of the picture. Sides, top, and bottom are cut off.

**Zoom2:** Provides larger magnification of the picture. Sides, top, and bottom are cut off.

**Wide Fit:** Enlarges the aspect ratio of the picture so the picture fits the entire screen.

**4:3:** Sets the picture to the old, 4:3 format and puts black or gray borders on the right and left of the picture.

**Do not watch your TV in the 4:3 format for a long time.** Traces of borders displayed on the left, right and center of the screen may cause image retention (screen burn) which is not covered by the warranty.

**Screen Fit:** Displays the full image without any cut-off when your TV is inputting HDMI (720p / 1080 / 1080p) or Component (1080i / 1080p) HD signals.

**HD (High Definition)** has a 16:9 aspect ratio and 1080i/1080p (1920x1080) or 720p (1280x720) resolution.

- You can adjust and store settings for each external device you have connected to an input on the TV. Picture Sizes available by Input Source are listed below:

## To set the clock, follow these steps:

- Select **Setup > Time > Clock**.
- Press **ENTER** and select **Auto** or **Manual**, and then press **ENTER** again.

If you selected **Auto:**

The TV will automatically download the correct time from a digital channel.

- Select **Time Zone**, and then press the **ENTER** button. Use the **▲/▼** buttons to select your **Time Zone**, and then press **ENTER**.
- Select **DST** (Daylight Savings Time), and then press **ENTER**. Select **Off** if you want to turn the DST adjustment on and off manually. Select **Off** to turn off the DST adjustment. Select **Auto** if you want the TV to adjust to DST automatically. Press **ENTER** when done.
  - DST** and **Time Zone** function are only available when the **Clock Mode** is set to **Auto**.

If you selected **Manual:**

The **Clock Set** screen appears. Use the **▲/▼** buttons to change the values in each field or use the number buttons to enter the values directly. Use the **◀/▶** buttons to move from field to field. When done with all the fields, press **ENTER**.

Available only when **Clock Mode** is set to **Manual**.

- Sleep Timer** Automatically shuts off the TV after a preset period of time. (30, 60, 90, 120, 150 and 180 minutes).
  - To cancel the **Sleep Timer**, select **Off**.

## Timer 1 / Timer 2 / Timer 3

Turns the TV on and off automatically at times and days you select. You can set three different on/off timer settings.

You must set the clock first.

**On Time / Off Time:** Set the hour, minute, am/pm, and Activate/inactivate fields for the **On Time** and **Off Time**. Use the **◀/▶** buttons to move from field to field. Use the **▲/▼** buttons to change the values in each field. To activate the timer with the setting you have chosen, set the Activate/inactivate field to **Activate**.

**Volume:** Set the desired loudness.

**Contents:** To select what will be turned on when the timer setting is activated, you can set the TV to turn on a specific channel or play back contents such as photo or audio files. Use the **◀/▶** buttons to move to the Contents field, and then press the **ENTER** button. The Contents screen appears. Use the **◀/▶** buttons to move from field to field. Use the **▲/▼** buttons to change the values in each field.

**TV/USB:** Select **TV** or **USB**. The USB device must be connected to your TV before you can select **USB**.

**Antenna:** Displays the current antenna source, **Air** or **Cable**.

**Channel:** If you have selected **TV**, select the desired channel.

**Music/Photo:** If you have selected **USB**, follow these steps to select a folder containing MP3 (Music) or JPEG (Photo) files on the USB device:

- The maximum displayed number of files, including sub folders, in one folder of USB storage device is 2000.
- The media may not be playing smoothly when using the device lower than USB 2.0.
  - Use the **◀/▶** buttons to move to the field under **Music** or the field under **Photo**, and then press the **ENTER** button. The TV displays a single folder (the Root folder) and the type or name of the device.

Input Source	Picture Size
ATV, AV, Component (480i, 480p)	<b>16:9 Zoom1, Zoom2, 4:3</b>
DTV (1080i, 1080p), Component (1080i, 1080p), HDMI (720p, 1080i, 1080p)	<b>16:9, Wide Fit, 4:3, Screen Fit</b>

**Digital Noise Filter (Off / Low / Medium / High / Auto):** If the broadcast signal received by your TV is weak, you can activate the **Digital Noise Filter** feature to reduce any static and ghosting that may appear on the screen.

When the signal is weak, try all the **Digital Noise Filter** options until the TV displays the best picture.

**HDMI Black Level (Normal / Low):** For HDMI signals, select the black level to adjust the screen depth. Low make blacks look darker.

- Available only in **HDMI** mode (RGB signals).

**Film Mode (Off / Auto):** Sets the TV to automatically sense and process film signals from all sources and adjusts the picture for optimum quality.

Available in **ATV, DTV** (interface), **AV, COMPONENT** (480 / 1080) and **HDMI** (480 / 1080).

**LED Motion Plus (Off / On):** Removes drag from fast scenes with a lot of movement to provide a clear picture.

## Picture Reset

- Picture Reset (Reset Picture Mode/Cancel):** Resets the picture settings to their factory defaults.

## Sound Menu

### Mode

- Standard:** Selects the normal sound mode.
- Music:** Emphasizes music over voices.
- Movie:** Provides the best sound for movies.
- Clear Voice:** Emphasizes voices over other sounds.
- Amplify:** Increase the intensity of high-frequency sounds to allow a better listening experience for the hearing impaired.

## Equalizer

Available in **Standard** sound mode only.

- Balance L/R:** Adjusts the balance between the right and left speaker.
- 100Hz / 300Hz / 1kHz / 3kHz / 10kHz (Bandwidth Adjustment):** Adjusts the loudness of specific bandwidth frequencies.
- Reset:** Resets the equalizer to its default settings.

## SRS TruSurround HD (On/Off)

Available in **Standard** sound mode only.

SRS TruSurround HD is a patented SRS technology that solves the problem of playing 5.1 multichannel content through two speakers. TruSurround delivers a compelling, virtual surround sound experience through any two-speaker playback system, including internal television speakers. It is fully compatible with all multichannel formats.

## Preferred Language

Digital channels only.

Digital-TV broadcasts can transmit many audio tracks simultaneously (for example, simultaneous translations of a program into foreign languages).

You can only select a language from among the ones being broadcast.

- Press the **ENTER** button. A list of folders on the device appears.
  - If there are no folders on your device, press the **Yellow** select button to select the Root folder, and then press the **RETURN** button. The Timer screen re-appears.

Use the **▲/▼** buttons to highlight a folder that contains music or photos, and then press the **Yellow** select button to select the folder.

Press the **RETURN** button. The Timer screen re-appears.

**Repeat:** Select **Once, Everyday, Mon-Fri, Mon-Sat, Sat-Sun** or **Manual**. If you select **Manual**, you can select the days you want to activate the timer by using the **◀/▶** buttons to highlight the day, and then pressing the **ENTER** button. To unselect a day, highlight it, and then press the **ENTER** button.

When you finished making all your selections on the Timer screen, press either the **ENTER** or **RETURN** button.

## Other Features

### Program Rating Lock

The **Program Rating Lock** feature lets you block programs you've determined are inappropriate for your children based on the program's ratings. To access the **Program Rating Lock** feature and make any changes, you must enter a PIN (personal identification number). To watch a blocked program, you must also enter the same PIN.

**Program Rating Lock** is not available in **HDMI** or **Component** mode.

The default PIN number of a new TV set is "0-0-0-0". You can set your own PIN using the **Change PIN** function.

## How It Works

When you access the **Program Rating Lock** Menu functions for the first time, the PIN input screen appears. Enter 0-0-0-0. The PIN screen closes and the **Program Rating Lock** Menu appears. Every time you access the **Program Rating Lock** functions, the PIN screen will appear and you must enter a PIN.

When the Rating Lock screen appears, select **Program Rating Lock**, and then press **ENTER**. Select **On**, and then press the **ENTER** key again. Depending on what type of programs or movies you want to block, select one of the options on the screen, and then press the **ENTER** button. The options are listed below:

**TV Parental Guidelines:** You can block TV programs based on their ratings. This function allows you to control what your children are watching.

**MPAA Rating:** You can block movies based on their MPAA ratings. The Motion Picture Association of America (MPAA) has implemented a rating system that provides parents or guardians with advanced information on which films are appropriate for children.

**Canadian English:** You can block TV programs based on their Angophone Canadian ratings.

**Canadian French:** You can block TV programs based on their French Canadian ratings.

**Downloadable U.S. Rating:** Parental restriction information can be used while watching DTV channels.

## Multi-Track Sound (MTS)

Analog channels only.

**Mono:** Select for channels that are broadcasting in mono or if you are having difficulty receiving a stereo signal.

**Stereo:** Select for channels that are broadcasting in stereo.

**SAP:** Select to listen to the Separate Audio Program, which is usually a foreign-language translation.

Depending on the program being broadcast, you can listen to **Mono, Stereo** or **SAP**.

- Before connecting your device to the TV, please back up your files to prevent them from damage or loss of data. SAMSUNG is not responsible for any data file damage or data loss.
- A USB device that requires high power (more than 0.5A) may not be supported.
- Do not disconnect the USB device while it is loading.
- The higher the resolution of the image, the longer it takes to display on the screen.
- The maximum supported JPEG resolution is 15360 x 8640 pixels.
- If a file is corrupted or the TV does not support the file type, the "Not Supported File Format" message appears.

The TV cannot play MP3 files with DRM that have been downloaded from a for-pay site. Digital Rights Management (DRM) is a technology that supports the creation, distribution, and management of digital content in an integrated and comprehensive way, including protecting the rights and interests of content providers, preventing illegal copying of contents, and managing billing and settlements.

- PTP devices are not supported.
- If an over-power warning message is displayed while you are connecting or using a USB device, the device may not be recognized or may malfunction.

- If the TV has no input during the time period set in **Auto Protection Time**, the Screensaver will run.
- The power-saving mode of some external hard disk drives may be released automatically when you connect them to the TV.
- If you use a USB extension cable, the TV may not recognize the USB device or may not be able to read the files on the device.

- If a USB device connected to the TV is not recognized, the list of files on the device is corrupted, or a file in the list is not played, connect the USB device to a PC, format the device, and check the connection.
- If a file you deleted from the PC is still found when you run **Media Play**, use the "Empty the Recycle Bin" function on the PC to permanently delete the file.
- **Photos** only supports the sequential jpeg format.

- The **Videos** option does not support the scene search and thumbnail functions.
- If the number of files and folders saved on a USB storage device is over approximately 4000, the files and folders may not appear and some folders may not open.
- The maximum displayed number of files, including sub folders, in one folder of USB storage device is 2000.

- The media may not be playing smoothly when using the device lower than USB 2.0.

- In the **Media Play** menu, press the ◀ or ▶ button to select **Videos**, and then press the ENTER button.
- Press the ◀/▶/▲/▼ buttons to select a video in the file list.
- Press the ENTER button or (Play) button.

- The file name is displayed on the top of the screen with the playing time.
- If video time information is unknown, playing time and the progress bar are not displayed.
- During video playback, you can search using the ◀ and ▶ buttons.
- ☞ In this mode, you can play movie clips contained in a game, but you cannot play the game itself.

## Videos



## Supported Subtitle Formats

### External

Name	File extension
MPEG-4 timed text	.txt
SAM	.smi
SubRip	.srt
SubViewer	.sub
Micro DVD	.sub or .txt
SubStation Alpha	.ssa
Advanced SubStation Alpha	.ass

### Internal

Name	Container	Format
Xsub	AVI	Picture Format
SubStation Alpha	MKV	Text Format
Advanced SubStation Alpha	MKV	Text Format
SubRip	MKV	Text Format
MPEG-4 Timed text	MP4	Text Format

## Supported Video Formats

File Extension	Container	Video Codec	Resolution	Frame rate/fps	Bit rate(kbps)	Audio Codec
*.mp4	MP4	DxV 3.11/x.v5.1 /B.0	1920x1080	6-30	30Mbps	MP3 / AAC / ADPCM
		H264	1920x1080	6-30	30Mbps	MP3 / AAC
		AVC	1920x1080	6-30	30Mbps	MP3 / AAC
		MJPEG	640x480	6-30	10Mbps	MP3 / AAC
*.avi *.mkv	AVI, MKV	DxV 3.11/x.v5.1 /B.0	1920x1080	6-30	30Mbps	MP3 / AAC / LPCM / ADPCM / DTS Core
		MPEG4 SP / ASP	1920x1080	6-30	30Mbps	MP3 / AAC / LPCM / ADPCM / WMA Pro
		H264	1920x1080	6-30	30Mbps	MP3 / AAC / LPCM / ADPCM / WMA Pro
		MJPEG	640x480	6-30	10Mbps	MP3 / AAC / LPCM / ADPCM / WMA Pro
*.asf *.wmv	ASF	DxV 3.11 / 4.x.v5.1 /B.0	1920x1080	6-30	30Mbps	MP3 / AAC / LPCM / ADPCM / WMA Pro
		MPEG4 SP / ASP	1920x1080	6-30	30Mbps	MP3 / AAC / LPCM / ADPCM / WMA Pro
		H.264	1920x1080	6-30	30Mbps	MP3 / AAC / LPCM / ADPCM / WMA Pro
		MPEG2	1920x1080	6-30	30Mbps	MP3 / AAC / LPCM / ADPCM / WMA Pro
*.mp3 *.wav *.aac *.wma	TS	H.264 / AVC / B.1 /B.0	1920x1080	6-30	30Mbps	MP3 / AAC / LPCM / ADPCM / WMA Pro
		H.264 / AVC / B.1 /B.0	1920x1080	6-30	30Mbps	MP3 / AAC / LPCM / ADPCM / WMA Pro
		H.264 / AVC / B.1 /B.0	1920x1080	6-30	30Mbps	MP3 / AAC / LPCM / ADPCM / WMA Pro
		H.264 / AVC / B.1 /B.0	1920x1080	6-30	30Mbps	MP3 / AAC / LPCM / ADPCM / WMA Pro
*.mp3 *.wav *.aac *.wma	PS	MPEG1	1920x1080	24/25/30	30Mbps	MP3 / AAC / LPCM / ADPCM / WMA Pro
		MPEG2	1920x1080	24/25/30	30Mbps	MP3 / AAC / LPCM / ADPCM / WMA Pro
		H.264 / AVC / B.1 /B.0	1920x1080	6-30	30Mbps	MP3 / AAC / LPCM / ADPCM / WMA Pro
		H.264 / AVC / B.1 /B.0	1920x1080	6-30	30Mbps	MP3 / AAC / LPCM / ADPCM / WMA Pro
*.mp3 *.wav	3GPP	MPEG4 SP / ASP	1920x1080	6-30	30Mbps	MP3
		H.264	1920x1080	6-30	30Mbps	MP3
*.mp3 *.wav	Flash formats	H.264	1920x1080	6-30	30Mbps	MP3
		H.263	1920x1080	6-30	30Mbps	MP3

## Other Restrictions

- Video content will not play, or not play correctly, if there is an error in the content or the container.
- Sound or video may not work if the contents have a standard bit rate/ frame rate above the compatible Frame/sec listed in the Supported Video Formats table.
- If the Index Table erroneous, the Seek (Jump) function is not supported.
- The menu may take longer to appear if the video's bit rate exceeds 10Mbps.
- Video content can not be played if there are many contents in one file.

## Video Decoder

Supports up to H.264, Level 4.1

H.264 FMO / ASO / RS, VC, SP / MP / AP / L4 and AVCHD are not supported.

MPEG4 SP, ASP :

- Below 1280 x 720: 60 frame max

- Above 1280 x 720: 30 frame max

H.263 is not supported.

GM3 is not supported.

Audio Decoder

Supports up to WMA7, 8, 9 STD, 9 PRO, 10 PRO WMA 9 PRO and WMA 10 PRO support 5.1 channel. (LBR mode of WMA Pro is not supported)

WMA Lossless is not supported.

WMA Lossless is not supported.

## Music

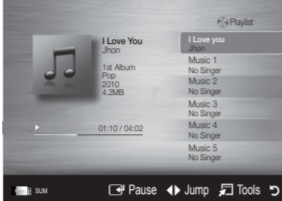

## Photos



1. In the **Media Play** menu, press the ◀ or ▶ button to select **Photos**, then press the ENTER button.
2. Press the ◀/▶/▲/▼ buttons to select a photo in the file list.
3. Press the ENTER button or (Play) button.

- ☞ NOTE
  - While a photo list is displayed, press the (Play) / ENTER button on the remote control to start a slide show.
  - All files in the file list section will be displayed in the slide show.
  - During the slide show, files are displayed in order.
  - During the slide show, you can adjust the slide show speed using (REW) or (FF) button.
  - You can play over other files using ◀ or ▶ button.

- ☞ **Media Play** can play Music files automatically during a Slide Show if **Background Music** is set to **On**.
- ☞ You cannot change the **Mode in Background Music** until the Background Music file has finished loading.

- Supported Photo Formats

Image	Photo	Resolution
JPEG	Base-line	15360 x 8704
	Progressive	1024 x 768

Other Restrictions

- CMYK, YCCK Color space JPEG are not supported.

## Playing Multiple Files

■ **Playing selected video/music/photo files**

1. On the File List screen, highlight a file, and then press the Yellow button on your remote.
2. Repeat Step 1 to select multiple files.

- ☞ NOTE
  - A ✓ mark appears to the left of the selected files.
  - To cancel a selection, press the Yellow button again.
  - To deselect all selected files, press the TOOLS button, select **Deselect All**, and then the ENTER button.

3. Press the TOOLS button, select **Play Selected Contents**, and then press the ENTER button.

- **Playing a video/music/photo folder**
  - 1. With the folders on your USB device displayed, use the ◀/▶/▲/▼ buttons to highlight a folder.
  - 2. Press the TOOLS button, select **Play Folder**, and then press the ENTER button.

## Media Play - Additional Functions

### ■ Videos/Music/Photos Play Option menus

When playing a file, press the TOOLS button.

Category	Operation	Videos	Music	Photos
<b>Title</b>	You can select another video file to play directly.	✓	✓	✓
<b>Repeat Mode</b>	You can play movie and music files repeatedly.	✓	✓	✓
<b>Picture Size</b>	You can adjust the picture size to your preference.	✓	✓	✓
<b>Picture Mode</b>	You can adjust the picture setting.	✓	✓	✓
<b>Sound Mode</b>	You can adjust the sound setting.	✓	✓	✓
<b>Subtitle Setting</b>	You can select the video with Subtitles and function only works if the subtitles have the same file name as the video.	✓	✓	✓
<b>Audio Format</b>	You can select the digital audio output format.	✓	✓	✓
<b>Audio Language</b>	You can change the audio language if the video has more than one language.	✓	✓	✓
<b>Stop Slide Show / Start Slide Show</b>	You can start or stop a Slide Show.	✓	✓	✓
<b>Slide Show Speed</b>	You can select the slide show speed during the slide show.	✓	✓	✓
<b>Background Music</b>	You can set and select background music when watching a Slide Show.	✓	✓	✓
<b>Zoom</b>	You can zoom into images in full screen mode.	✓	✓	✓
<b>Rotate</b>	You can rotate images in full screen mode.	✓	✓	✓
<b>Information</b>	You can see detailed information about the played file.	✓	✓	✓

## Settings

Using the Setup Menu

■ **DivX® Video On Demand** : Shows the registration code authorized for the TV. If you connect to the DivX web site and register with the 10-digit registration code, you can download the VOD activation file. Once you play it using Media Play, the registration is completed.

- ☞ For more information on DivX® VOD, visit "http://vod.divx.com".
- **Information:** Select to view information about the connected USB device.

## Other Information

The wall mount kit (sold separately) allows you to mount the TV on the wall.

For detailed information about installing the wall mount, see the instructions provided with the wall mount items. Contact a technician for assistance when installing the wall mount bracket. Samsung Electronics is not responsible for any damage to the product or injury to yourself or others if you elect to install the wall mount on your own.

Wall Mount Kit Specifications (VESA)

- ☞ The wall mount kit is not supplied, but sold separately.
- ☞ Install your wall mount on a solid wall perpendicular to the floor.
- ☞ When attaching to other building materials, please contact your nearest dealer. If you install the TV on a ceiling or slanted wall, it may fall and result in severe personal injury.

Storage and Maintenance

- ☞ If a sticker was attached to the TV screen, some debris can remain after you remove the sticker. Please clean it before watching the TV.
- ☞ The exterior and screen of the product can get scratched during cleaning. Be sure to wipe the exterior and screen carefully using a soft cloth to prevent scratches.

License

SRS TheaterSound  
SRS TheaterSound SRS and the symbol are trademarks of SRS Labs, Inc. TheaterSound technology is incorporated under license from SRS Labs, Inc.

DivX  
DivX Certified® to play DivX® video up to HD 1080p, including premium content.

ABSOLUT DIVX VIDEO: DivX® is a digital video format created by DivX, LLC, a subsidiary of Row Corporation. This is an official DivX Certified device that plays DivX video. Visit DivX.com for more information and software tools to convert your files into DivX videos. ABSOLUT DIVX VIDEO-ON-DEMAND: This DivX Certified® device must be registered in order to play purchased DivX Video-on-Demand (VOD) movies. To obtain your registration code, locate the DivX VOD section in your device setup menu. Go to vod. divx.com for more information on how to complete your registration. Covered by one or more of the following U.S. patents : 7,295,673; 7,460,668; 7,515,710; 7,519,274 DivX®, DivX Certified® and associated logos are trademarks of Row Corporation or its subsidiaries and are used under license.

DOLBY DIGITAL PLUS Manufactured under license from Dolby Laboratories. Dolby and the double-D symbol are trademarks of Dolby Laboratories.

dts 2.0+Digital Out Manufactured under license under U.S. Patent Nos: 5,966,674; 5,974,380; 6,487,535 & other U.S. and worldwide patents issued & pending. DTS, the Symbol, & DTS and the Symbol together are registered trademarks & DTS 2.0+Digital Out is a trademark of DTS, Inc. Product includes software. © DTS, Inc. All Rights Reserved.

Open Source License Notice  
Open Source used in this product can be found on the following webpage. (http://opensource.samsung.com) Open Source License Notice is written only in English.

To send inquiries and requests for questions regarding open sources, contact Samsung via Email (oss.request@samsung.com).  
■ **This product uses some software programs which are distributed under the Independent JPEG Group.**  
©1998-2008 International Business Machines Corporation and others All rights reserved.  
COPYRIGHT AND PERMISSION NOTICE  
© 1995-2008 International Business Machines Corporation and others All rights reserved. Permission is hereby granted, free of charge, to any person obtaining a copy of this software and associated documentation files (the "Software"), to deal in the Software without restriction, including without limitation the rights to use, copy, modify, merge, publish, distribute, and/or sell copies of the Software, and to permit persons to whom the Software is furnished to do so, provided that the above copyright notice(s) and this permission notice appear in all copies of the Software and that both the above copyright notice(s) and this permission notice appear in supporting documentation.  
THE SOFTWARE IS PROVIDED "AS IS", WITHOUT WARRANTY OF ANY KIND, EXPRESS OR IMPLIED, INCLUDING BUT NOT LIMITED TO THE WARRANTIES OF MERCHANTABILITY, FITNESS FOR A PARTICULAR PURPOSE AND NONINFRINGEMENT. IN NO EVENT SHALL THE COPYRIGHT HOLDER OR HOLDERS INCLUDED IN THIS NOTICE BE LIABLE FOR ANY CLAIM, OR ANY SPECIAL, INDIRECT OR CONSEQUENTIAL DAMAGES, OR ANY DAMAGES WHATSOEVER RESULTING FROM LOSS OF USE, DATA OR PROFITS, WHETHER IN AN ACTION OF CONTRACT, NEGLIGENCE OR OTHER TORTIOUS ACTION, ARISING OUT OF OR IN CONNECTION WITH THE USE OR PERFORMANCE OF THIS SOFTWARE.  
Except as contained in this notice, the name of a copyright holder shall not be used in advertising or otherwise to promote the sale, use or other dealings in this Software without prior written authorization of the copyright holder.  
All trademarks and registered trademarks mentioned herein are the property of their respective owners.

## NOTE

- Standard dimensions for wall mount kits are shown in the table below.
- When purchasing our wall mount kit, a detailed installation manual and all parts necessary for assembly are provided.
- Do not use screws that do not comply with the VESA standard screw specifications.
- Do not use screws that are longer than the standard dimension or do not comply with the VESA standard screw specifications. Screws that are too long may cause damage to the inside of the TV set.
- For wall mounts that do not comply with the VESA standard screw specifications, the length of the screws may differ depending on the wall mount specifications.
- Do not fasten the screws too firmly. This may damage the product or cause the product to fall, leading to personal injury. Samsung is not liable for these kinds of accidents.
- Samsung is not liable for product damage or personal injury when a non-VESA or non-specified wall mount is used or the consumer fails to follow the product installation instructions.
- Do not mount the TV at more than a 15 degree tilt.
- Always have two people mount the TV on a wall.

Product Family	TV size in inches	VESA screw hole specs (A * B) in millimeters	Standard Screw	Quantity
LED-TV	19~22	75 X 75	M4	4
	26	100 X 100		
	32~40	200 X 200		
	46~60	400 X 400	M8	

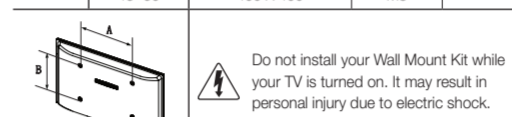

## Securing the TV to the Wall

- ☞ Caution: Pulling, pushing, or climbing onto the TV may cause the TV to fall. In particular, ensure that your children do not hang over or destabilize the TV, doing so may cause the TV to tip over, resulting in serious injuries or death. Follow all safety precautions provided on the included Safety Flyer. For added stability, install the anti-fall device for safety purposes, as follows.

- ☞ To prevent the TV from falling
  - Since the necessary brackets, screws, and string or cable are not supplied, please purchase these separately.
  - 1. Insert the screws into the wall brackets and firmly fasten them to the wall. Make sure the screws are firmly fixed to the wall.
  - We strongly recommend you drive the screws into a stud.
  - 2. Using screws, insert the screws through the TV brackets, and then fasten the screws to the top VESA screw holes on the back of the TV.
  - 3. Connect the brackets on the TV and the brackets on the wall with a strong string or cable, and then tie the string or cable tightly to the brackets.
  - ☞ Verify all connections are properly secured. Periodically check the connections for any sign of fatigue or failure. If you have any doubt about the security of your connections, contact a professional installer.
  - ☞ Install the TV close to the wall so that it does not fall.
  - ☞ Connect the string or cable so that the brackets on the wall are at the same height or lower than the brackets on the TV. Untie the string or cable before moving the TV.
  - ☞ To purchase a TV Holder kit, contact Samsung customer care.

- ☞ To prevent the TV from falling
  - Since the necessary brackets, screws, and string or cable are not supplied, please purchase these separately.

- ☞ To prevent the TV from falling
  - Since the necessary brackets, screws, and string or cable are not supplied, please purchase these separately.

- ☞ To prevent the TV from falling
  - Since the necessary brackets, screws, and string or cable are not supplied, please purchase these separately.

- ☞ To prevent the TV from falling
  - Since the necessary brackets, screws, and string or cable are not supplied, please purchase these separately.

- ☞ To prevent the TV from falling
  - Since the necessary brackets, screws, and string or cable are not supplied, please purchase these separately.

- ☞ To prevent the TV from falling
  - Since the necessary brackets, screws, and string or cable are not supplied, please purchase these separately.

- ☞ To prevent the TV from falling
  - Since the necessary brackets, screws, and string or cable are not supplied, please purchase these separately.

- ☞ To prevent the TV from falling
  - Since the necessary brackets, screws, and string or cable are not supplied, please purchase these separately.

- ☞ To prevent the TV from falling
  - Since the necessary brackets, screws, and string or cable are not supplied, please purchase these separately.

- ☞ To prevent the TV from falling
  - Since the necessary brackets, screws, and string or cable are not supplied, please purchase these separately.

- ☞ To prevent the TV from falling
  - Since the necessary brackets, screws, and string or cable are not supplied, please purchase these separately.

- ☞ To prevent the TV from falling
  - Since the necessary brackets, screws, and string or cable are not supplied, please purchase these separately.

- ☞ To prevent the TV from falling
  - Since the necessary brackets, screws, and string or cable are not supplied, please purchase these separately.

- ☞ To prevent the TV from falling
  - Since the necessary brackets, screws, and string or cable are not supplied, please purchase these separately.

- ☞ To prevent the TV from falling
  - Since the necessary brackets, screws, and string or cable are not supplied, please purchase these separately.

- ☞ To prevent the TV from falling
  - Since the necessary brackets, screws, and string or cable are not supplied, please purchase these separately.

- ☞ To prevent the TV from falling
  - Since the necessary brackets, screws, and string or cable are not supplied, please purchase these separately.

- ☞ To prevent the TV from falling
  - Since the necessary brackets, screws, and string or cable are not supplied, please purchase these separately.

- ☞ To prevent the TV from falling
  - Since the necessary brackets, screws, and string or cable are not supplied, please purchase these separately.

- ☞ To prevent the TV from falling
  - Since the necessary brackets, screws, and string or cable are not supplied, please purchase these separately.

- ☞ To prevent the TV from falling
  - Since the necessary brackets, screws, and string or cable are not supplied, please purchase these separately.

- ☞ To prevent the TV from falling
  - Since the necessary brackets, screws, and string or cable are not supplied, please purchase these separately.

- ☞ To prevent the TV from falling
  - Since the necessary brackets, screws, and string or cable are not supplied, please purchase these separately.

- ☞ To prevent the TV from falling
  - Since the necessary brackets, screws, and string or cable are not supplied, please purchase these separately.

- ☞ To prevent the TV from falling
  - Since the necessary brackets, screws, and string or cable are not supplied, please purchase these separately.

- ☞ To prevent the TV from falling
  - Since the necessary brackets, screws, and string or cable are not supplied, please purchase these separately.

- ☞ To prevent the TV from falling
  - Since the necessary brackets, screws, and string or cable are not supplied, please purchase these separately.

- ☞ To prevent the TV from falling
  - Since the necessary brackets, screws, and string or cable are not supplied, please purchase these separately.

## Kensington Lock

The Kensington Lock is not supplied by Samsung. It is a device used to physically fix the system when using it in a public place. Refer to the manual provided with the Kensington Lock for additional information on proper use.

- ☞ Please find a "K" icon on the rear of the TV. The Kensington slot is beside the "K" icon.
- ☞ The position and color may differ depending on the model.

## Assembling the Wire Holder stand

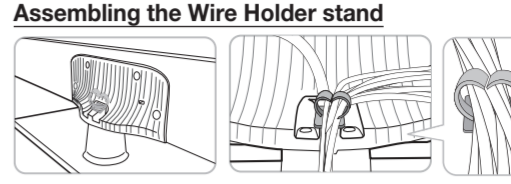

VERA DMT

Product Family	TV size in inches	VESA screw hole specs (A * B) in millimeters	Standard Screw	Quantity
LED-TV	19~22	75 X 75	M4	4
	26	100 X 100		
	32~40	200 X 200		
	46~60	400 X 400	M8	

## Troubleshooting

If the TV seems to have a problem, first review this list of possible problems and solution. If none of these troubleshooting tips apply, visit samsung.com, then click on Support, or call Samsung customer service at 1-800-SAMSUNG.

Problem	Possible Solution
Flickering and Dimming	If your Samsung Television is flickering or dimming sporadically, you may need to disable some of its energy efficient features like the Eco Sensor or the Energy Saving feature. Follow the steps below with your remote to turn these features off or on. <ul style="list-style-type: none"><li>• <b>Eco Sensor : Menu -&gt; Setup -&gt; Eco Solution -&gt; Energy Saving -&gt; Select Settings</b></li><li>• <b>Eco Sensor : Menu -&gt; Setup -&gt; Eco Solution -&gt; Eco Sensor -&gt; Select Settings</b></li></ul> If you find that the color on your Samsung television's screen is not correct or black and white, first run a Self Diagnosis Test on the TV to make sure there are no device issues. <ul style="list-style-type: none"><li>• <b>Self Diagnosis : User Menu -&gt; Support -&gt; Self Diagnosis -&gt; Picture Test</b></li><li>• If the test is ok, try making sure :<ul style="list-style-type: none"><li>• Your connections are all consistent. For example, if you've used the AV in jack on your TV, make sure you have used the AV out jack on your video source.</li><li>• Try making sure you have connected to the correct jacks. For example, if you use the Component jacks, labeled Pb, Pr, and Y, to connect your TV and video source, make sure you have connected the blue Pb jack on the video source to the blue Pb jack on the TV, the red Pr jack on the video source to the red Pr jack on the TV.</li></ul></li></ul>
Component Connections / Screen Color	
Screen Brightness	If you find that the colors on your Samsung TV are correct but just a little too dark or bright, there are some settings you should check before calling for a repair. <ul style="list-style-type: none"><li>• <b>Backlight, Contrast, Brightness, Sharpness, Color, Tint and so on.</b> Go to "Picture" in the Menu, and then try adjusting these options.</li></ul>
Unwanted Powering off	If your Samsung TV appears to turn off by itself, there may be an issue with either your Timer settings or your Eco-friendly No Signal Power Off feature. <ul style="list-style-type: none"></ul>