



# Cook's Essentials®

**The best meals start with the essentials.**

Cook's Essentials® Kitchenware. Only at QVC.

## 1.5 PINT SELF-FREEZING ICE CREAM MAKER

MODEL: K45559/EIM-700

### INSTRUCTION MANUAL

Before operating your new appliance, please read all instructions carefully and keep for future reference.



Questions? Elite's customer service team is ready to help.  
Call us toll-free at 800-365-6133 ext. 120/107/105.

## IMPORTANT SAFEGUARDS

The Elite Brand takes consumer safety very seriously. Products are designed and manufactured with our valued consumers' safety in mind. Additionally, we ask that you exercise a level of caution when using any electrical appliance by following all instructions and important safeguards.

### READ ALL INSTRUCTIONS BEFORE USE AND SAVE FOR FUTURE REFERENCE

**When using an electrical appliance, basic safety precautions should always be followed, including the following:**

1. Read all instructions before use, and keep for future reference.
2. To protect against electric shock, do not immerse cord, plug or motor in water or any other liquid.
3. Close supervision is required when any appliance is used by or near children.
4. Avoid contact with moving parts.
5. In order to reduce the risk of injury to person or damage to the appliance, keep hands and utensils out of removable container during operation. Do not use sharp objects or utensils inside the removable container.
6. Do not clean the removable container and fixed bowl with cleanser, steel wool pads or other abrasive materials.
7. Remove plug from wall outlet when not in use and before putting on or removing parts, and before cleaning.
8. Do not operate any appliance with a damaged cord or plug or after the appliance malfunctions or has been damaged in any manner.
9. The use of accessories not recommended by the manufacturer may cause fire, electric shock, or injury.
10. Do not use this appliance outdoors.
11. Do not let cord hang over the edge of table or counter or touch heated surfaces such as the stove.
12. Do not place appliance on or near hot gas or electric burner or in a heated oven.
13. Do not use the appliance for other than intended use, as per this instruction manual.
14. Do not operate any appliance with a damaged cord or plug or after the appliance malfunctions, or has been dropped or damaged in any manner. See warranty to return for examination, repair, or replacement.
15. Do not place hot foods or liquids into the ice cream maker.
16. Close the lid immediately after adding ingredients so the inside temperature will not rise dramatically.
17. Keep appliance away from any heat source or direct sunlight.
18. The appliance must be placed on a flat and solid surface during operation and in storage.
19. Never pull the cord to disconnect it from the outlet. Grasp the plug and pull it from the outlet.
20. Never lift or carry the maker by the cord.
21. Keep the cord away from heated surfaces.
22. *CAUTION: Keep product away from open flames.*
23. *DISPOSAL: Do not dispose of this product as unsorted municipal waste. Collection of E-WASTE is necessary.*

## SHORT CORD PURPOSE

**NOTE:** A short power cord is provided to reduce the risk of personal injury resulting from becoming entangled in or tripping over a longer cord.

**Longer power-supply cords or extension cords are available and may be used if care is exercised in their use.**

If an extension cord is used: (1) the marked electrical rating of the extension cord should be at least as great as the electrical rating of the product; (2) the extension cord should be arranged so that it will not drape over the countertop or tabletop where it can unintentionally be pulled on or tripped over by children or pets.

## POLARIZED PLUG

If this appliance is equipped with a **polarized plug** (one blade is wider than the other), please follow the below instructions:

To reduce the risk of electrical shock, this plug is intended to fit into a polarized outlet only one way. If you are unable to fit the plug into the electrical outlet, try reversing the plug. If the plug still does not fit, contact a qualified electrician. Never use the plug with an extension cord unless the plug can be fully inserted into the extension cord. Do not alter the plug of the product or any extension cord being used with this product. Do not attempt to defeat the safety purpose of the polarized plug.

**SAVE THESE INSTRUCTIONS  
THIS PRODUCT IS FOR  
HOUSEHOLD USE ONLY**

## PARTS IDENTIFICATION

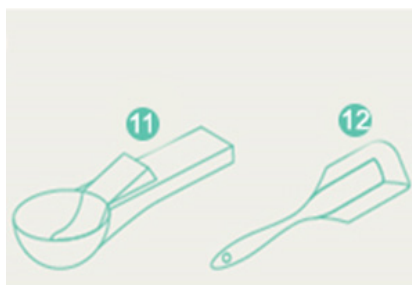
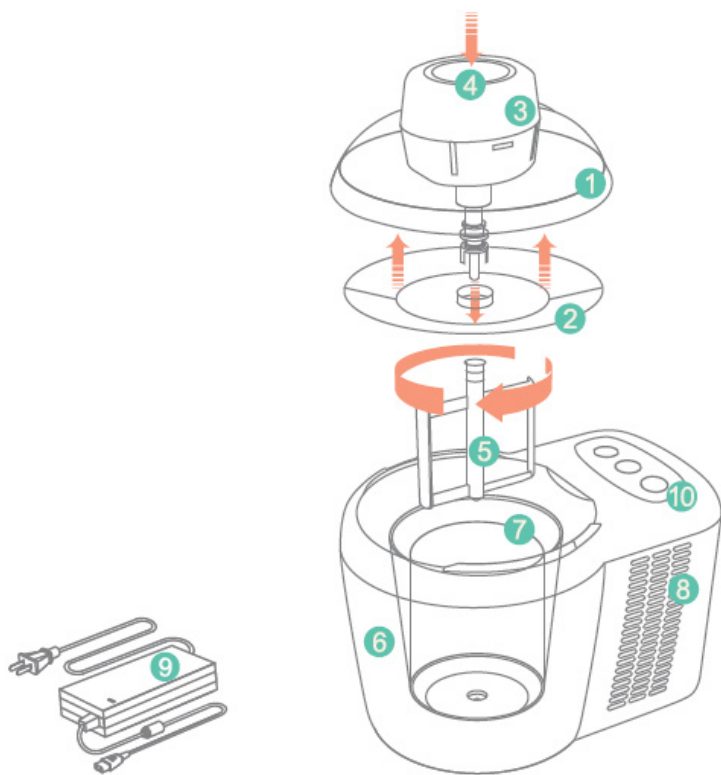

- |                         |                     |
|-------------------------|---------------------|
| 1. Top Cover            | 9. AC Adaptor       |
| 2. Top Lid Lining       | 10. Control Panel   |
| 3. Mixing Motor         | 11. Ice Cream Scoop |
| 4. Motor Release Button | 12. Spatula         |
| 5. Ice Cream Paddle     |                     |
| 6. Housing              |                     |
| 7. Inner Bowl           |                     |
| 8. Back Cover           |                     |

## BEFORE FIRST USE

1. Remove all interior and exterior packaging materials.
2. To remove the Mixing Motor (3) from the Top Cover (1), lift upwards on the motor (3) at the same time as pressing down on the Motor Release Button (4). (See figures 1 - 2).
3. Remove the Paddle (5) by pulling it out of the shaft of the motor (3). Turn top cover (1) counter-clockwise to unlock and remove.

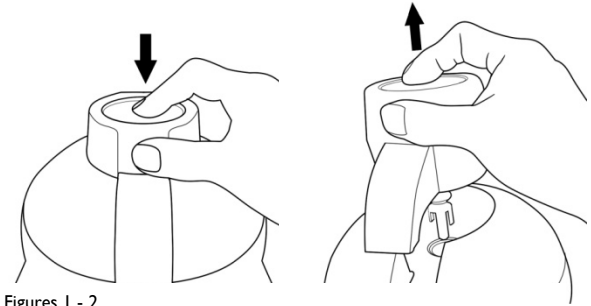

Figures 1 - 2

Use warm, soapy water to clean the Inner Bowl (7), transparent top cover (1), top lid lining (2) and paddle (5) of ice cream maker before using.

- **CAUTION:** Do NOT wash the Mixing Motor (3). Wipe Mixing Motor (3) with damp cloth.
4. Ice Cream Maker must be set upright on a horizontal surface for at least 5 hours after purchase or after transit.

## HOW TO USE YOUR ICE CREAM MAKER

1. Place the Ice Cream Maker on a stable and flat surface and allow for proper air circulation through Ventilation Grills on all sides of the main body.
2. Assemble mixing motor (3) back onto top cover (1) and insert the paddle (5) into the spindle of the mixing motor (3) until it clicks into place.
3. Connect the AC adaptor (9) to an electrical outlet and to the back of the main body (See figures 3 - 4).

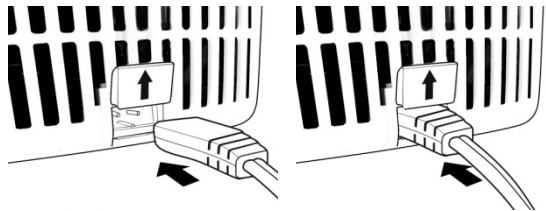

Figures 3 - 4

4. Prepare Ice Cream Mixture.

### Preparation of Ice Cream Mixture:

- Select your recipe and prepare the mixture.
- When using ice cream powder to make ice cream, please operate according to the instructions on the package of the ice cream powder.
- Use ingredients free of any inedible materials such as seeds, peels or pits.
- Always chill the ingredients in your refrigerator before pouring into the machine. This will reduce the time required to make the ice cream.

## HOW TO USE YOUR ICE CREAM MAKER (cont).

- Do not exceed the MAX fill line marking within the Inner Bowl when using ingredients that expand. This will allow the volume to increase during freezing to fit the bowl's maximum capacity.
5. Pour ice cream mixture into inner bowl (7).
  6. Place assembled top cover (1) onto the ice cream maker by ensuring the metal pins underneath the mixing motor (3) (see figure 5) make contact with the magnetic switches on the main body of the ice cream maker (See figures 6 - 7).

Underside of Mixing Motor (3)

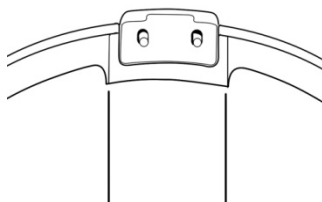
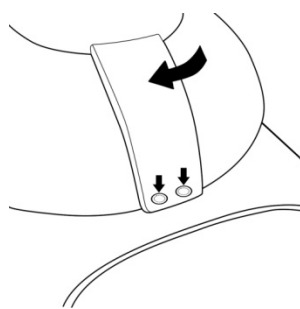
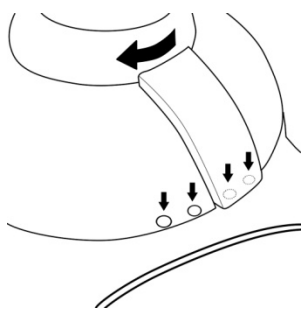
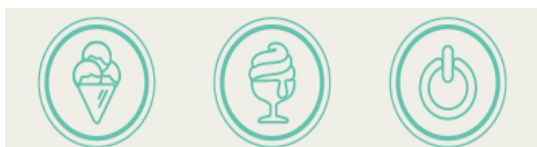

Figure 5



Figures 6 - 7

- **NOTE:** The motor (3) will not function if the magnetic switches are not activated by the metal pins. It will also switch off the motor power automatically if the motor (3) separates from the magnetic switches.
7. Turn clock-wise to lock the top cover (1) in place.
  8. Press either the HARD or SOFT button to begin operation. The motor (3) will begin turning and the unit will begin freezing.
- The HARD setting is for thicker ice cream consistency
- The SOFT setting is for Soft-Serve ice cream consistency .



9. Depending on the quantity and type of ingredients used as well as the ambient temperature, the unit will take between 45-120 minutes to make ice cream.
10. The ice cream maker will beep once the ice cream is ready and the paddle is no longer able to turn.
11. Press the STOP button to cancel operation.

## HOW TO USE YOUR ICE CREAM MAKER (cont).

- If the paddle does not rotate anymore due to the hardness of the ice cream, press the STOP button and remove the paddle immediately to avoid the paddle freezing into the ice cream.
- Do not turn the motor (3) off unless the ice-cream is ready. If the motor is shut off too early, the mixture may freeze onto the inner bowl (7).
- The freezing times for recipes may vary due to different room temperatures. If the mixture freezes quicker, turn off the motor and immediately remove the paddle. (The times listed in the recipe section are estimates.)

### WHEN FINISHED:

1. Unplug the power cord from wall socket.
  2. Remove the motor (3) and unlock the top cover (1) by turning it counter-clockwise. Set them aside. The paddle (5) should be inside the ice cream bowl. Remove the paddle and scrape off any ice cream stuck to the paddle (5).
  3. Use scoop or spatula (included) to spoon out ice cream from inner bowl (7) into a freezer-safe container or serve immediately.
- **CAUTION:** Do not use metal utensils to stir or scoop your ice cream in the inner bowl (7) as this may damage the surface of the bowl.

## CLEANING AND MAINTENANCE

**WARNING:** To avoid the risk of electrical shock, always ensure the product is unplugged from the electrical outlet before assembling, disassembling, relocating, servicing, or cleaning it.

- Before cleaning, make sure that the machine has had sufficient time to reach room temperature.
  - Never use harsh, abrasive cleaners, heavy-duty cleaners, or solvents on any surface.
1. Wipe exterior with damp, soapy cloth and then dry with a clean towel.
  2. Wash the top cover (1), top lid lining (2) and paddle (5) in warm, soapy water.
- **CAUTION:** Do NOT wash the Mixing Motor (3). Wipe Mixing Motor (3) with damp cloth.
  - **TIP:** To remove the top cover (1) from the top lid lining (2), pinch the tabs shown in figure 8 and then pull the top lid lining (2) away from the top cover (1) as shown in figure 9.
3. Rinse and dry.
  4. Wash inner bowl (7) with warm soapy water and rinse. Avoid water contact with the vents on the back cover (8).
- Do not place any parts of the machine in the dishwasher.

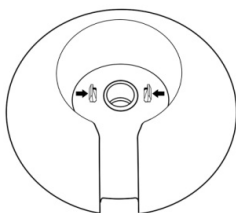

Figure 8

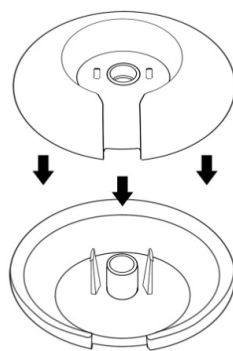

Figure 9

## CLEANING AND MAINTENANCE (cont).

**WARNING: NEVER SUBMERGE THE ICE CREAM MAKER INTO WATER OR ANY OTHER LIQUID AS THIS MAY DAMAGE THE UNIT.**



## TROUBLESHOOTING

Symptoms	Possible Causes	Solutions
The ice cream maker does not power on.	The motor is assembled incorrectly.	Make sure you have followed the instructions in the manual on how to assemble the motor (3) and top cover (1) to the body and that the magnetic switches are activated by the pins found underneath the motor (3).
The ice cream maker isn't freezing the ice cream.	The appliance is placed too close to a heat source. No sufficient ventilation. The lid is opened too frequently.	Keep the appliance away from direct sunlight or other heat sources. Place the ice cream maker in an area with good ventilation and leave 6" of clear space on all sides of the vents. Close the lid tightly and do not open the lid too frequently while in operation.











# Cook's Essentials®

**The best meals start with the essentials.**  
Cook's Essentials® Kitchenware. Only at QVC.

## Elite Customer Service Center

Mail: Maxi-Matic, USA  
18401 E. Arenth Ave  
City of Industry, CA  
91748-1227

Phone: 800-365-6133 ext. 120/107/105

Email: [info@maxi-matic.com](mailto:info@maxi-matic.com)

[www.maxi-matic.com](http://www.maxi-matic.com)

Elite is a registered trademark of Maxi-Matic, USA.  
Copyright Elite by Maxi-Matic.

Actual product may vary from the images/illustrations in this manual due to continual product improvement.

MODEL: K45559/EIM-700